

SUNBEAM *Specialties, Inc.*

ALPINE-TIGER PARTS SPECIALISTS

PHONE (408) 371-1642
FAX (408) 371-8070
E-mail: sunsp22@gmail.com

765 E McGLINCY LN STE A
CAMPBELL, CA 95008, USA



Le Mans Tiger in 1964

WWW.ROOTES.COM

WORLD WIDE SERVICE

PARTS CATALOG

SEPT. 2021

© COPYRIGHT SUNBEAM SPECIALTIES, INC. MARCH 2019
THE COVER AND CONTENTS ARE FULLY PROTECTED UNDER
THE COPYRIGHT LAWS OF THE UNITED STATES. COPYING
OR REPRODUCTION IN ANY MANNER IS FORBIDDEN. ALL
RIGHTS ARE RESERVED. PRINTED IN THE U.S.A.

COVER PHOTO

THE COVER PHOTO AND PHOTOS IN THE REAR INNER COVER ARE
COURTESY OF THE **COVENTRY U.K. MOTOR MUSEUM**, HOME OF THE **ROOTES**
ARCHIVES, OFFICIAL PHOTOGRAPHS, AND FACTORY RECORDS. THE
MUSEUM HAS AN IMPRESSIVE DISPLAY OF ROOTES CARS.

ROOTES ARCHIVE CENTRE

MANY THANKS TO THE ROOTES ARCHIVE CENTRE FOR THEIR SUPPORT AND
TECHNICAL HELP BY PROVIDING ORIGINAL FACTORY BLUEPRINTS & INFO.



PHOTO COURTESY OF COVENTRY MOTOR MUSEUM

IDENTIFY YOUR CAR

IDENTIFY YOUR CAR AND ITS ENGINE FROM THE INFORMATION BELOW. IT IS
NECESSARY TO KNOW YOUR CAR'S SERIES NUMBER TO ORDER THE CORRECT PARTS.
ALPINE CHASSIS #S AND ENGINE NUMBERS ARE THE SAME WHEN THE CAR WAS
MANUFACTURED BUT WILL BE DIFFERENT IF THE ENGINE HAS BEEN CHANGED. IF YOUR
ENGINE DOES NOT HAVE ONE OF THE NUMBERS BELOW, IT MAY HAVE AN ENGINE FROM
A RAPIER, A HILLMAN OR OTHER ROOTES CAR OR MAY BE OUT OF SOME OTHER MAKE
OF CAR.

YOUR CHASSIS # IS STAMPED ONTO A PLATE NEAR THE HOOD LATCH PANEL ON THE
BODY OF THE CAR AND THE ENGINE # ON AN ALPINE IS STAMPED INTO A MACHINED
AREA BEHIND THE FUEL PUMP. TIGER ENGINE NUMBERS ARE NOT THE SAME AS
CHASSIS NUMBERS.

YOUR CHASSIS NUMBER	SERIES OR MARK #
YOUR ENGINE # (ALPINE)	ENGINE SERIES # (ALPINE)

ALPINE SERIES	NOTE	CHASSIS NUMBERS	DATES	TOTAL
1		B9000001 TO B9011904	Oct.59-Oct.60	11,904
2		B9100001 TO B9119956	Oct.60-Feb.63	19,956
3		B9200001 TO B9205863	Mar.63-Jan.64	5,863
4	(A)	B9400001 TO B9407936	Jan.64-Sep.65	7,936
	(B)	B94100001 TO B94104470		4,470
5		B395000001 TO B395019122	Sep.65-Jan.68	19,122

TIGER MARK	NOTE	CHASSIS NUMBERS	DATES	TOTAL BUILT
I		B9470001 TO B9473762	Jun.64-Aug.65	3,762
I-A	(C)	B382000001 TO B382002706	Aug.65-Sep.66	2,706
II	(D)	B382100001 TO B382100633	Dec.66-Jun.67	536

- Notes: A SERIES IV WITH NON-SYNCHRO FIRST TRANSMISSION & 8" CLUTCH.
B SERIES IV WITH ALL-SYNCHRO TRANSMISSION & 7-1/2" CLUTCH.
C NO TIGERS WERE DESIGNATED BY ROOTES AS MK IA CARS. THIS TERM
HAS ARISEN TO DESCRIBE TIGERS BUILT ON ALPINE V TYPE BODIES WITH
THE VINYL CONV. TOP BOOT INSTEAD OF METAL COVERS.
D MARK II PRODUCTION NUMBERS VARY. CARS WITH SERIAL # B382100001
AND #B382100002 EXIST WITH NO JAL #S (JENSEN ALPINE LTD. BODY #)
WHICH INDICATES THE CARS WERE COMPLETELY ASSEMBLED BY ROOTES,
NEVER GOING TO THE JENSEN PLANT AND MUST HAVE BEEN A PRE-
PRODUCTION PILOT CARS. THE NEXT MK II IS B382100100 WHICH CARRIES
A JAL NUMBER, THE FIRST OF THE MK II SERIES.

CHASSIS # LETTER SUFFIXES

- GT GRAN TURISMO, IE. HARDTOP & TONNEAU ONLY, NO SOFTOP, UPGRADED
INTERIOR.
OD OVERDRIVE TRANSMISSION.
BW BORG WARNER AUTOMATIC TRANSMISSION

THE FIRST LETTER OF THE FINAL COMBINATION INDICATES:

- H HOME MARKET (ENGLAND)
R RIGHT HAND DRIVE EXPORT
L LEFT HAND DRIVE EXPORT

THE SECOND LETTER INDICATES:

- R ROADSTER

THE THIRD LETTER INDICATES

- O STANDARD
X NON-STANDARD
P POLICE SPECIFICATION

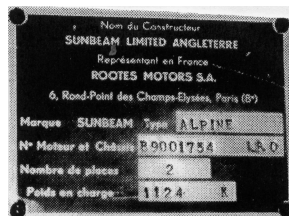

ON TIGERS, THE FINAL PAIR OF LETTERS ARE: FE FORD ENGINE

USING THE ABOVE CODES, WE SEE THAT A ALPINE WITH THE # B9204567 GT OD/LRX IS
AN ALPINE S.III GRAN TURISMO (HARDTOP ONLY), OVERDRIVE, LEFT HAND DRIVE
ROADSTER WITH NON-STANDARD SPECIFICATIONS. (US CAR, NOT FOR ENGLAND"

A TIGER WITH THE # **B382001527 HROFE** IS A RIGHT HAND DRIVE CAR MADE FOR THE
ENGLISH MARKET AND IS A ROADSTER OF STANDARD SPECIFICATIONS WITH FORD
ENGINE # 1599 E22KC AND COLOUR CODE # 86, FOREST GREEN



LE MANS ALPINE

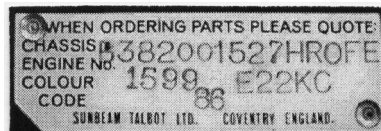

INDEX

A

AIR CLEANER, ALPINE 6,17
 AIR FILTER, TIGER 13
 ALPINE SCRIPT 24
 ALTERNATORS & PARTS 14,16
 ALUMINUM THRESHOLD PLATES 20
 ANTI-RATTLE STRIPS 20
 ASH TRAYS 25

B

BALL JOINTS 11
 BEARINGS, CRANK & ROD 5
 BEARINGS, ELECT. PARTS 14
 BEARINGS, WHEEL 11
 BLEED SCREWS, CAL. & W/C 19
 BOOKS 19
 BOOT, SOFT TOP 23
 BRA, FRONT END (STONE MASK) 25
 BRACKET, BUMPER 24
 BRACKET, TOP ANCHORING 21
 BRACKETS, SUN VISOR 28
 BRAKE BOOSTER 18
 BRAKE FLUID 19
 BRAKE HOSES 18
 BRAKE PARTS 18,19
 BRUSHES 14
 BULBS 15,16
 BUMPER PARTS 24
 BUSHINGS, SUSPENSION 10,11

C

CABLE, BRAKE 18
 CALIPER KITS 18
 CAP, OIL FILLER 4
 CAR COVERS 25
 CARBURETOR, KITS, PARTS 6
 CARPET KITS 23
 CENTER TIE ROD BUSHINGS 11
 CHANNEL KIT, DOOR 20
 CLIPS, CARPET 23
 CLIPS, DOOR 20
 CLIPS, EMBLEM 24
 CLUTCH HYDRAULIC PARTS 18
 CLUTCHES & PARTS, ALPINE 7
 CLUTCHES & PARTS, TIGER 13
 CONNECTING ROD 5
 CONVERTIBLE TOPS & PARTS 21
 COOLING SYSTEM, TIGER 12
 CRANKSHAFT, 1725 5
 CRANKSHAFT FR. SEAL KIT, ALPINE 7
 CRASH PAD, ALL 23
 CUBBY BOX 25

D

DASH PAD, ALL 23
 DASH, WOOD 24
 DECAL, WHEEL SPINNER 28
 DECALS, SOFT TOP 21
 DEFROSTER HOSES 25
 DIAPHRAM, CARB 6
 DIAPHRAGM, SEAT 23
 DIFFERENTIAL PARTS, ALPINE. 10
 DISTRIBUTOR CAPS 14
 DISTRIBUTOR, ALPINE 14
 DISTRIBUTOR, TIGER 16
 DOOR CLOSING PADS 20
 DOOR HANDLES 20,24
 DOOR LIMIT STRAP 21
 DOOR PANEL CLIPS 20
 DOOR PANELS 22
 DOOR PARTS 20
 DOOR WAIST ROLL PADS 23
 DOVETAIL, DOOR 20
 DRIVESHAFT YOKE 11
 DUCKBILL DRAIN END 12,27
 DUST COVER, BRAKE 19
 DZUS BRACKET 26

E

ELECTRONIC IGNITION 14
 EMBLEMS & PATCHES 27
 EMERGENCY BRAKE BOOT 19
 EMERGENCY BRAKE CABLE 18
 ENGINE INFO PLATE 25
 ENGINE, 1725 SHORT BLOCK 7
 EXHAUST SYSTEM PARTS 27
 EXTERIOR TRIM 24

F

FAN BELT 5,13
 FASTENERS, SOFT TOP 21
 FLASHER UNIT 16
 FRAME EXHAUST SUPPORTS 25
 FREEZE PLUG SET 4
 FRONT SUSPENSION 11
 FUEL PUMP 7,13
 FUEL PUMP PARTS 7,13
 FUEL SYSTEM 17
 FUSE BOX & FUSES 16
 FUZZIES, WINDOW 20

G

GAS CAP 17
 GAS PEDAL,ALPINE III-V, TIGER RHD 6
 GASKETS 6,13
 GASKETS, SIGNAL LIGHTS 15
 GEAR SHIFT BOOT, ALPINE 25
 GEAR SHIFT KNOBS 25
 GENERATOR 14,16
 GLOVE BOX 25
 GRILL FINISHERS & PARTS 24
 GROMMETS, CARB LINKAGE 6
 GROMMETS, FIREWALL 27

H

HARD TOP PARTS 26
 HARRINGTON BADGES 24
 HEADERS, TIGER 27
 HEADLAMP 15
 HEATER VALVE 5,12
 HEATER CONTROL CABLE PAIR 5,12
 HEATER CORE 5,12
 HEATER CORE DRAIN TROUGH 5,12
 HOLLEY CARBS, TIGER 13
 HOOD BADGE 24
 HOOD BUFFER 25
 HOOD SEAL 25
 HORN 13
 HORN RELAY 16
 HORN RING 25
 HOSE, PVC VALVE, TIGER 13
 HOSE, VACUUM ADVANCE 5
 HOSES, BRAKE 18
 HOSES, FUEL SYSTEM 17
 HOSES, RADIATOR 5,12
 HYDRAULIC LINES, METAL 17

I

IDLER ARM PARTS 11
 IGNITION PARTS, ALPINE 14
 IGNITION SPECS, ALPINE 17
 INSTRUMENT VOLT. REG. 16
 INSTRUMENTS 16
 INTAKE MANIFOLD, ALPINE 6
 INTERIOR TRIM 25

K

KEY FOB 27
 KONI SHOCKS 8
 KYB SHOCKS 8

L

LAMPS 15
 LAT OPTIONS 28
 LENSES 15
 LETTERS, "SUNBEAM" 24
 LIFTERS 4

LIGHTER 25
 LOCK FOR TRUNK LATCH 26
 LUG BOLTS & NUTS 10,11

M

MASTER CYL. & KITS 18
 MIRROR BUFFER 20
 MIRROR, DOOR 24
 MIRROR, INTERIOR 25
 MOTOR MOUNT 4,13
 MOULDINGS, CHROME 24
 MOUNT, TRANSMISSION 8,12
 MUFFLERS 27

N

NUTS, EXHAUST PIPE 27
 NUTS, WHEEL LUGS 10,11

O

OIL FILTER, ALPINE 17
 OIL GUAGE LINE 16
 OIL PAN, STEEL (ALPINE) 4
 OIL PUMP 5
 OVERDRIVE PARTS 8
 OWNER'S HANDBOOKS 19

P

PADS, BRAKE 19
 PANEL KIT, INTERIOR 23
 PANHARD ROD BUSHINGS 10
 PARKING SIGNS 27
 PATCHES 27
 PEDAL PADS 25
 PERTRONIX IGNITION 14
 PILOT BUSHINGS 7,13
 PINS, JACKET OR HAT 27
 PISTONS 6
 PLUGS, FIREWALL 27
 POINTS & CONDENSOR, ALPINE 14
 PULLEY & FAN, ALTERNATOR 14
 PUSH ROD, ENGINE 4
 PUSH ROD, CLUTCH SLAVE CYL. 7

R

RADIATOR CAPS 5
 RADIATOR DRAIN TAP 5,12
 REAR AXLE PARTS, ALPINE 10
 REAR END PARTS, TIGER 13
 REBUILDING, INSTRUMENTS 16
 REGULATOR PARTS, WINDOW 20
 REGULATOR, VOLTAGE 14,16
 RELAY, WARNING LIGHT 14
 RING GEAR FOR FLYWHEEL, ALP. 9
 RING & PINION, ALPINE 10
 RING & PINION, TIGER 13
 RINGS, PISTON 6
 ROCKER ARM PARTS 4
 ROD, CONNECTING 5
 RODS, ROD BOLTS & NUTS 5
 ROOTES GROUP BADGE 24

S

SCREWS, DOOR HINGE 20
 SCREWS, DOOR PARTS 20
 SCREWS, TRIM 24
 SCRIPT, NAMEPLATE 24
 SEAL, TRUNK 26
 SEALS, DOOR 20
 SEALS, HARDTOP 26
 SEALS, SOFT TOP 21
 SEAT BELTS 28
 SERVOS (BRAKE) & PARTS 18
 SHIFT BOOT, ALPINE 25
 SHIFT BOOT, TIGER 12
 SHOCK ABSORBERS 8
 SHOES, BRAKE 19
 SPARE TIRE STRAP 26
 SPARK PLUGS 17
 SPECIFICATION PLATES 25
 SPEEDO CABLES 16

SHORT BLOCK ENGINE 1725 7
 SIDE MOULDINGS, TIGER 24
 SOFT TOPS & PARTS 21
 SPINNERS FOR LAT WHEELS 28
 SPRINGS, BRAKE RETURN 19
 STAINLESS STEEL EXHAUST 27
 STARTER SOLENOID 14
 STARTERS & PARTS 14,16
 STEERING BOX PARTS 11
 STEERING WHEELS, MOTO-LITA 25
 STONE MASK 25
 STRAPS, SEAT 23
 STROMBERG CARB PARTS 6
 STUD, CYL. HEAD 4
 STUD, EXHAUST TO MANIFOLD 27
 SUN VISORS 21
SUNBEAM LETTERS 24
Sunbeam SCRIPT 24
 SUSPENSION, FRONT 11
 SUSPENSION, REAR 10
 SWAY BARS 10,11
 SWITCHES 8,16

T

T FITTING, CARBURETOR 6
 TEMPERATURE SENDERS 16
 TENSION RODS, SOFT TOP 21
 THERMOSTATS & HOUSING 4
 TIE ROD ENDS 11
 TIE TACKS 27
 TIGER SCRIPT 24
 TIMING CHAIN & GEARS 4
 TIMING COVER 4
 TIMING SPECS 7
 TONNEAU COVERS 21
 TOOLS 27
 TORQUE SPECS 7
 TRACTION BARS 10
 TRANSMISSION PARTS 8,9,12
 TREAD PLATES, DOOR 20
 TRIANGLE PLATES, DOOR 20
 TRUNK HINGES 24
 TRUNK LATCH STRIKER 26
 TRUNK PLATFORM 26
 TRUNK SEAL 26
 TURN SIGNAL SW. REPAIR KIT 16

U

U JOINTS 11
 UPHOLSTERY, SEAT 22
 UPHOLSTERY PANELS 22,23

V

VALVE COVERS, ALUMINUM 28
 VALVE LASH SPECS, ALPINE 7
 VALVE LIFTERS 4
 VALVES, SEATS, GUIDES 4
 VENT REPAIR KIT 25

W

WARNING LIGHTS, DASH 15
 WATER JET, CYL. HEAD 4
 WATER OUTLET PIPE 4
 WATER PUMP 5,13
 WHEEL BEARING 11
 WHEEL CYL. & PARTS 18
 WHEELS, LAT 70, ALUMINUM 28
 WINDOW CRANK 20
 WINDOWS, HARD TOP 26
 WINDSHIELD WASHER PARTS 17
 WINDSHIELD WIPERS 17
 WINDSHIELDS SEALS 20
 WIRING HARNESSSES 16
 WOODEN DASHBOARD 24
 WORKSHOP MANUALS 19

Z

ZENITH CARB GASKETS 6

VALVE TRAIN PARTS

PICT. REF.#	DESCRIPTION	PART #	PRICE
	ROCKER STAND STUD	A9605263	5.95
1	CRANKSHAFT TIMING GEAR	A1228027	46.50
2	TIMING CHAIN	A9226040	24.60
3	BOLT, CAM SPROCKET	A5220686	1.25
4	WASHER, TABWASHER	AP055844	9.75
5	WASHER, RETAINING	A9096046	3.00ea
6	CAMSHAFT TIMING GEAR	AP112147	81.00
7	RETAINING PLATE, .004" O/S	AP107824	14.50
7	RETAINING PLATE, STANDARD	AP118772	14.50
8	KEY, CAM SPROCKET	A9213008	2.50
9	CAMSHAFT, S. V. 11725cc	A1239455	NLA
10	END PLUG	A9809340	4.50
11	PLUG, ROCKER SHAFT ENDS	A9101807	0.90ea
12	ROCKER SHAFT, FRONT (WITH PLUG)	A5220124	N.L.A.
13	ROCKER SHAFT, REAR (WITH PLUG)	A5220125	N.L.A.
14	ADAPTER, ROCKER OIL FEED	A1202204	17.60
15	COMPRESSION FITTING	A9157102	0.50ea
16	NUT	A9156506	2.00
17	OIL PIPE, ROCKER FEED	A5220099	14.75
18	NUT, OIL PIPE	A9156051	1.75
19	UNION	A9151200	3.75
20	RETAINING CLIP	AP103912	1.50ea
21	SPRING	AP103638	3.00ea
22	ROCKER, NUMBERS 1,3,5,7	AP118877	29.50ea
23	ROCKER, NUMBERS 2,4,6,8	AP118878	29.50ea
24	ROCKER ADJUSTER STUD	A1238404	5.60
25	LOCKNUT, ROCKER ADJ. STUD	A9520050	0.50
26	ROCKER STAND	AP106984	28.75ea
27	SPACER FOR SPRING	A1202169	1.50
28	SPRING	AP103637	2.50
29	PUSH ROD, S. V (CHANGE ALL 8)	A1238510	11.50ea

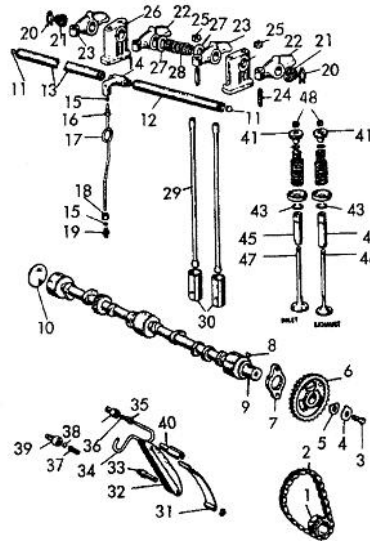

1725 SHORT BLOCK, SEE PAGE 7
NEW

VALVE SEATS		
OVERSIZE	INTAKE	PRICE
.002 O/S	A5107319	8.00ea
.005 O/S	A5107320	8.00ea
.010 O/S	A5107321	8.00ea

OVERSIZE	EXHAUST	PRICE
.002 O/S	A5114976	10.75ea
.005 O/S	A5114977	8.75ea
.010 O/S	A5114978	8.75ea

VALVE LASH SETTINGS (HOT)		
INTAKE	(2,4,5,7)	0.012"
EXHAUST	(1,3,6,8)	0.014"

REF.#	DESCRIPTION	PART #	PRICE
30	VALVE LIFTER, STD. SIZE	A5112223	10.95ea
31	CHAIN TENSIONER BLADE*	AP107711	7.25
32	CHAIN TENSIONER RUBBER	AP107710	9.75
33	CHAIN TENSIONER STUD	AP103732	8.75
34	OIL PIPE, TIMING	A1208782	13.50
35	RETAINER NUT FOR OIL PIPE	A9156501	1.75
36	COMP. FITTING FOR OIL PIPE	A9157100	0.50
37	SPRING, OIL FEED	A1208784	1.75
38	BALL, OIL FEED	A9187001	0.75
39	FITTING, OIL FEED, ALP. B9106448 & UP	A1208783	3.50
40	PILLAR STUD	A1235909	13.75

*ALPINE S.I-II WITH A ONE PIECE METAL CHAIN TENSIONER BLADE, REPLACE WITH ITEM #S 31 & 32.

- (A) SERIES I-V TO SERIAL # B395016811
- (B) SERIES V FROM SERIAL # B395015821

ALPINE ENGINE CAUTION: NEVER USE AN ENGINE OIL SUPPLEMENT OR "HIGH MILEAGE OIL" TO TRY TO REDUCE ENGINE OIL LEAKS. THESE ADDITIVES WORK BY SWELLING THE RUBBER SEALS WHICH THIS ENGINE DOES NOT HAVE. HOWEVER, THE TIMING CHAIN TENSIONER IS RUBBER & IT WILL SWELL AND BE DESTROYED IN THE ENGINE REQUIRING AN ENGINE TEARDOWN. THIS IS VERY IMPORTANT.

APPLICATION NOTE	INLET VALVE(47)	EXHAUST VALVE(46)	INLET GUIDE(45)	EXHAUST GUIDE(44)	GUIDE RET. RING(43)	SPRING RETAINER(41)	VALVE KEEPER SET(48)
ALPINE S.I-II(A)	IV2 17.50ea	EV4 17.50ea	IN5 7.25ea	EX5 7.25ea	EX5R 0.45ea	VS5R NLA	VS5K 9.95
ALPINE II-IV (B)	IV4 17.75ea	EV4 17.75ea	IN5 7.25ea	EX5 7.25ea	EX5R 0.45ea	VS5R NLA	VS5K 9.95
ALPINE S. V	IV5 19.75ea	EV5 19.75ea	IN5 7.25ea	EX5 7.25ea	EX5R 0.45ea	VS5R NLA	VS5K 9.95

NOTE: PICTURE REFERENCE NUMBERS ARE IN PARENTHESSES.

- (A) SERIES I AND II UP TO B9117424
- (B) SERIES II FROM B9117425 THRU S.IV

MISC. ENGINE PARTS

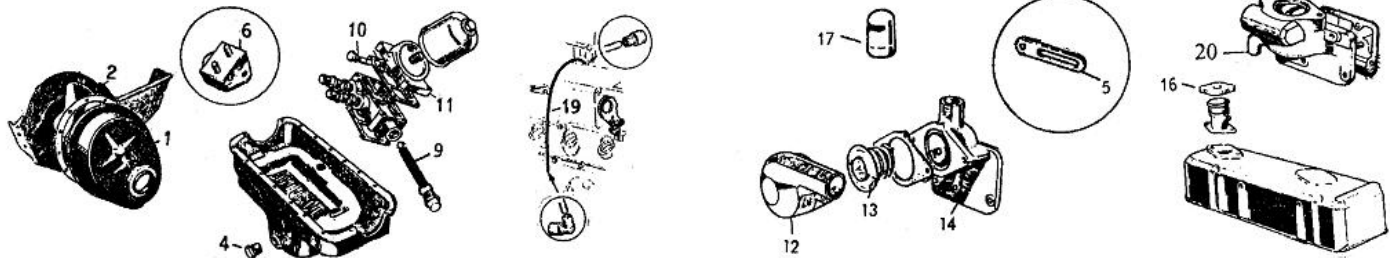

PICT REF.#	DESCRIPTION	PART #	PRICE
	FREEZE PLUG SET, BRASS, ALL SERIES	A5220785	29.50
	OIL COOLER HOSE, SHORT	A5220966	82.50
	OIL COOLER HOSE, LONG	A5220967	98.20
	CYL. HEAD BOLT (8 PER CAR) EA	A9003202	6.95
	CYL. HEAD STUD (2 PER CAR) EA	A9008052	6.95
1	TIMING COVER, SERIES V	A1235083	76.50
1	DIPSTICK, 1725 cc ENGINE ONLY	A1238470	18.95
2	ENGINE SUPPORT PLATE	A1207042	NLA
3	STEEL OIL PAN, 1725cc S. V	A1238000	139.00
4	OIL DRAIN PLUG BOLT	A9801043	9.95
5	ALTERNATOR ADJUSTING STRAP	A1235179	NLA
6	MOTOR MOUNT, FRONT, EACH	A1201437	22.75
11	FILTER BASE WITH VALVE*	A5058202	NLA

PICT. REF	DESCRIPTION	PART #	PRICE
12	WATER OUTLET PIPE, S. III-V	A1214648	88.60
13	THERMOSTAT, 160 (SUMMER)	A1218672	10.95
13	THERMOSTAT, 180 (WINTER)	A1235962	10.95
14	THERMOSTAT HOUSING, S.III-V	A1214647	134.00
15	ALTERNATOR BRACKET, S.V	A1238066	N.L.A.
16	OIL FILLER CAP, SERIES III-V	A1207074	9.50
17	WATER JET FOR CYL. HD, S.I-V	A1200077	8.50
19	HOSE, VACUUM ADVANCE, NYLON WITH RUBBER ENDS	Ai63	7.25
20	THERMOSTAT HOUSING, S.I-II	A1218587	137.50
	FLAME TRAP, SMALLER THAN ORIG.	A1228004	13.75

NOTE: SEE P.6 FOR THE ALPINE FRONT CRANK OIL SEAL KIT

LOWER END

PICT. REF.#	DESCRIPTION	PART #	PRICE
1	CRANKSHAFT BALANCER, ALL ALP.,	A1228153	299.50
1	BALANCE, SPECIAL FOR TC1A COVER	A1228154	299.50
2	BOLT W/O JAW (REPLACEMENT)	A1238081	6.75
3	TABWASHER FOR BOLT ABOVE	A1202443	5.95
5	RUBBER DAMPER RING, S.V	A1228028	8.95
6	OIL SLINGER, S.V TYPE	AP103610	13.75
7	KEY FOR DAMPER, 1-7/16" LONG ONLY	A9213040	4.75
8	CRANKSHAFT, S. V ONLY (1725cc)	A5221237	415.00
9	OIL PUMP, SERIES V	A5044739	108.75
10	ROD BOLT, 11/32", SERIES II-V, EACH	A1238004	4.75ea
11	ROD NUT, 11/32", SERIES II-V EACH	A9034069	N.L.A.
11	ROD NUT, 5/16", S. I ONLY EACH	A9571053	3.00ea
12	LOCK PLATE FOR FLYWHEEL BOLTS, EA	AP103620	3.75ea
13	PIN, PINION TO SHAFT, S. I-IV EACH	A9146020	1.75ea

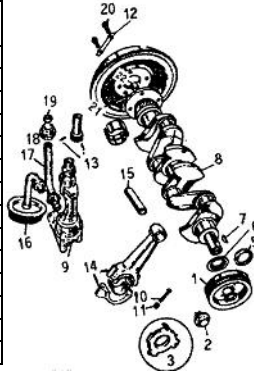

PICT. REF.#	DESCRIPTION	PART #	PRICE
	NEW 1725cc SHORT BLOCK, SEE P.7		
13	PIN, PINION TO SHAFT, S. V EACH	A5043897	2.75ea
14	CONNECTING ROD, SERIES II-IV, EACH	A1206880	78.00ea
14	CONNECTING ROD, S. V (1725) , EACH	A1229289	68.75ea
15	WRIST PIN, .003 O/S, S. II-V, EACH	A5110420	N.L.A.
15	WRIST PIN, .001 O/S, S. II-V, EACH	A5110421	N.L.A.
16	OIL PICKUP ASSEMBLY, SERIES V	A1238047	N.L.A.
17	OIL PIPE, PUMP TO BLOCK, S. V	A1235118	13.50
18	NUT FOR OIL PIPE, SERIES V	A9156553	5.00
19	COMP. FITTING FOR PIPE, S. V	A9157115	1.60
20	FLYWHEEL BOLT, EACH	A9506073	2.00ea
21	CRANKSHAFT/FLYWHEEL DOWEL PIN	A5220715	4.95ea
22	PILOT BUSHING (SEE CLUTCH PARTS)		

ENGINE BEARINGS

DESCRIPTION	APPLICATION	STANDARD SIZE	SIZE .010	SIZE .020	SIZE .030	SIZE .040	SIZE .050
MAIN BEARINGS	ALPINE S. I-IV	MB40 94.75set	MB41 94.75	MB42 94.75set	MB43 94.75set	MB44 58.80set	MB45 58.80set
	ALPINE SERIES V	MB50 53.60set	MB51 53.60set	MB52 53.60set	MB53 53.60set	MB54 53.60set	

ROD BEARINGS	APPLICATION	STANDARD SIZE	SIZE .010	SIZE .020	SIZE .030	SIZE .040	SIZE .050
ALPINE SERIES I	ALPINE SERIES I	RB10 59.50set	RB11 59.50set	RB12 59.50set	RB13 59.50set	RB14 59.50set	RB15 59.50set
	ALPINE S. II-IV	RB40 62.75set	RB41 62.75set	RB42 62.75set	RB43 62.75set	RB44 62.75set	RB45 62.75set
	ALPINE SERIES V	RB50 60.75set	RB51 60.75set	RB52 60.75set	RB53 60.75set	RB54 60.75set	

DESCRIPTION	APPLICATION	STANDARD SIZE	SIZE 0.025	SIZE .005	SIZE .010	SIZE .030
THRUST WASHERS, FOR CRANKSHAFT	ALPINE S. I-IV	TW40 58.75pr	TW402 N.L.A.	TW405 N.L.A.	TW410 N.L.A.	
	ALPINE S. V	TW50 17.50pr		TW505 17.80pr		TW53 17.80pr

CAM BEARINGS	ALPINE I-V, ALL	CB50 37.95set
PISTON PIN BUSHING SET	ALPINE SERIES I	PP10 NLA
	ALPINE S. II-V	PP50 38.95set

ENGINE BEARINGS & BUSHINGS SETS ARE SUPPLIED AS ENGINE SETS. THRUST WASHERS ARE SUPPLIED AS PAIRS.



COOLING SYSTEM / FAN BELTS

ALPINE SERIES #	WATER PUMP	LOWER RAD. HOSE	UPPER RAD. HOSE	BYPASS HOSE	FAN BELT
I	NOT AVAIL.	LH1 25.90	UH1 24.60	BH2 31.80	FB4 19.95
II	WP5 B/O	LH2 29.80	UH2 26.40	BH2 31.80	FB4 19.95
III	WP5 B/O	LH5 26.60	UH5 25.40	BH5 16.95	FB4 19.95
IV	WP5 B/O	LH5 26.60	UH5 25.40	BH5 16.95	FB4 19.95
V	WP5 B/O	LH5 26.60	UH5 25.40	BH5 16.95	FB5 19.20

PICT. REF.#	DESCRIPTION	PART #	PRICE
1	RADIATOR CAP, SERIES I	RC1	14.75
1	RADIATOR CAP, SERIES II TO B9104562	RC1	14.75
2	RAD. CAP, SERIES II FR B9104563, NO PR RELIEF	RC2	9.50
3	RADIATOR CAP, SERIES III-V	RC5	9.95
4	HOSE, HEATER VALVE TO HEATER CORE, S.V	CS62	15.75
5	ENGINE DRAIN TAP, BRASS, ALPINE I-V	CS63	7.95
6	RADIATOR DRAIN TAP, BRASS S.I-V TO B395004644	CS63	7.95
7	RADIATOR DRAIN TAP, PLASTIC, S.V FROM B395004645	CS64	9.20
8	HEATER CONTROL VALVE, SERIES I-IV, TIGER I	CS45	58.50
9	DUCKBILL DRAIN, ALPINE III-V, TIGER	CS65	12.50
	GASKET FOR HEATER CORE COVER PLATE	CS66	4.75
10	HEATER CORE, ALL ALPINES & TIGERS	CS68	192.10
11	HEATER CONTROL VALVE, SERIES V, TIGER IA II	CS55	NLA
12	HEATER CONTROL CABLE SET, LONG & SHORT, AS ORIGINAL, MAY NEED TO SHORTEN THE LONG CABLE DEPENDING ON THE TYPE CAR	CS69	29.95
13	HEATER CORE DRAIN TROUGH	CS70	47.75

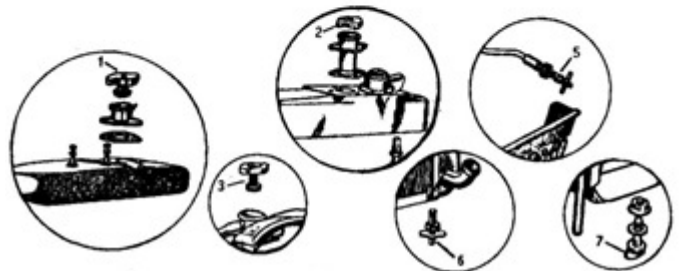
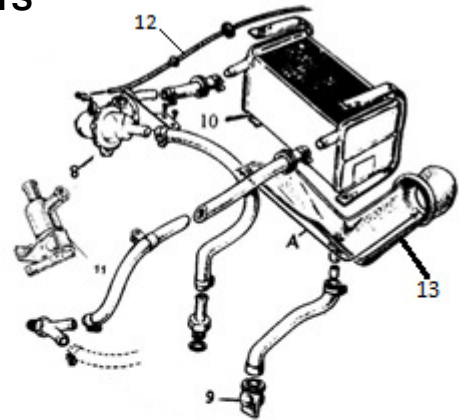

ENGINE GASKETS

DESCRIPTION	ILL.#	SERIES I	SERIES II	SERIES III	SERIES IV	SERIES V
HEAD SET		UG5 56.40	UG5 56.40	UG5 56.40	UG5 56.40	UG5 56.40
CONVERSION SET		CG4 34.75	CG4 34.75	CG4 34.75	CG4 34.75	CG5 34.25
HEAD GASKET		HG5 19.95	HG5 19.95	HG5 19.95	HG5 19.95	HG5 19.95
VALVE COVER GASKET, CORK	1	VG5C 9.25	VG5C 9.255	VG5C 9.25	VG5C 9.25	VG5C 9.25
VALVE COVER GASKET, PAPER	1	VG5 5.75	VG5 5.75	VG5 5.75	VG5 5.75	VG5 5.75
MANIFOLD GASKET, EXH & INTAKE	2	MG5 16.75	MG5 16.75	MG5 16.75	MG5 16.75	MG5 16.75
OIL PAN SET	3	PG4 17.80	PG4 17.80	PG4 17.80	PG4 17.80	PG5 19.50
PUSH ROD SIDE COVER	4	SG5 6.95	SG5 6.96	SG5 6.95	SG5 6.95	SG5 6.95
SUPPORT PLATE GASKET	5	JG5 4.80	JG5 4.80	JG5 4.80	JG5 4.80	JG5 4.80
TIMING COVER GASKET	6	TG5 5.50	TG5 5.50	TG5 5.50	TG5 5.50	TG5 5.50
FILTER TO CYLINDER BLOCK	7			FG5 3.00ea	FG5 3.00ea	FG5 3.00ea
OIL COOLER BLOCK GASKET	7			FG5 3.00ea	FG5 3.00ea	FG5 3.00ea
WATER OUTLET PIPE	8			OG5 4.80	OG5 4.80	OG5 4.80
THERMOSTAT HOUSING TO HEAD	9	AG5 4.75	AG5 4.75	AG5 4.75	AG5 4.75	AG5 4.75
EXHAUST PIPE	10				EG5 13.95	EG5 13.95
DRAIN PLUG GASKET, ENGINE, TRANS & DIFFERENTIAL	11	DG5 1.65ea	DG5 1.65ea	DG5 1.65ea	DG5 1.65ea	DG5 1.65ea
STROMBERG CARB BASE (PAIR)	12					LG5 5.30pr
WATER PUMP, PAIR	13	WG5 5.50pr	WG5 5.50pr	WG5 5.50pr	WG5 5.50pr	WG5 5.50pr
FUEL PUMP SPACER	14	KS5 11.50	KS5 11.50	KS5 11.50	KS5 11.50	KS5 11.50
FUEL PUMP GASKET	15	KG5 4.75pr	KG5 4.75pr	KG5 4.75pr	KG5 4.75pr	KG5 4.75pr

*ALL SERIES III AND UP WITH SCREW-ON OIL FILTER.

**FITS DRAIN PLUG ON THE ENGINE, TRANSMISSION, OR DIFFERENTIAL.

ONE HEAD SET AND ONE CONVERSION SET CONTAIN ALL THE GASKETS NECESSARY TO REBUILD AN ENGINE.

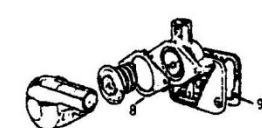
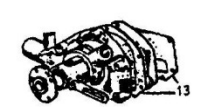
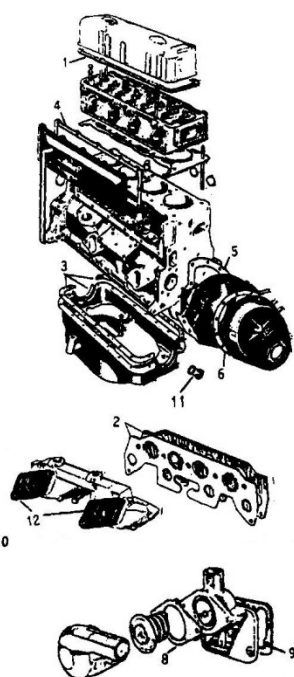

PISTONS

APPLICATION	SIZE STDS.	SIZE .020	SIZE .030	SIZE .040	SIZE .060
ALPINE S. I	EP10 N.L.A.	EP12 N.L.A.	EP13 N.L.A.	EP14 N.L.A.	
ALPINE S. II-IV	EP50* 135.00ea	EP52* 135.00ea	EP53* 135.00ea	EP54* 135.00ea	EP56 135.00ea
ALPINE S. V	EP50 135.00ea	EP52 135.00ea	EP53 135.00ea	EP54 135.00ea	EP56 135.00ea

*1725 PISTONS HAVE BEEN SUBSTITUTED FOR THE 1592 PISTONS. THEY ARE IDENTICAL EXCEPT THE COMPRESSION RATIO WILL BE SLIGHTLY LOWER.

PISTONS COME COMPLETE WITH WRIST PINS AND RINGS. PISTONS ARE SOLD IN SETS OF 4 PISTONS PER SET.



RINGS

APPLICATION	SIZE STD	SIZE .020	SIZE .030	SIZE .040
ALPINE S. I, 1494	PR10 78.50set	PR12 78.50set	PR13 78.50set	PR14 89.65set
ALPINE S. II-V	PR50 65.50set	PR52 65.50set	PR53 65.50set	PR54 65.50set

PISTON RINGS ARE SUPPLIED AS A COMPLETE SET.



CARB REBUILDING KITS

APPLICATION	CARB TYPE	KIT #	PRICE
ALPINE S. I-III*, GASKET SET ONLY	ZENITH WIA, WIP	RK30*	22.60ea
ALPINE S. III, IV, NO SECONDARY DIAPHRAGM	SOLEX 32 PAIA-2	RK40	N.L.A.
ALPINE IV GASKET SET	SOLEX 32 PAIA	RK40G	14.95
STROMBERG KIT, THROTTLE SHAFTS NOT INCLUDED, 1 CARB PER KIT		RK50	44.50ea

ORDER 1 CARB KIT PER CARBURETOR.

*GASKET & SPACER SET ONLY.

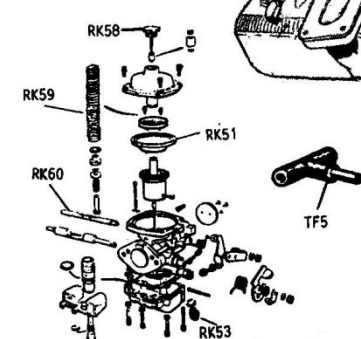
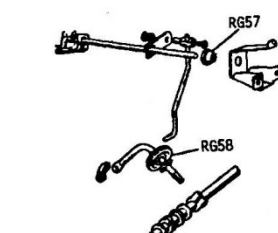

2 BARREL INTAKE MANIFOLD

LINKAGE GROMMETS

DESCRIPTION	PART #	PRICE
THROTTLE ROD GROMMET (S. III-V)	RG57	4.25ea
FIREWALL GROMMET (LATE S.II THRU V)	RG58	5.60ea



DESCRIPTION	PART #	PRICE
2 BARREL DOWNDRAFT INTAKE MANIFOLD, TAKES SC50W CARB. MADE IN US	IM5	198.00

GAS PEDAL

DESCRIPTION	PART #	PRICE
GAS PEDAL, ALL ALPINE III-V, ALSO FITS THE TIGER (RHD ONLY)	GT57	32.95

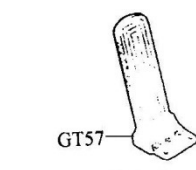

WEBER CARBS

DESCRIPTION	PART #	PRICE
WEBER 2 BARREL PROGRESSIVE CARB 32mm PRIMARY & 36mm SECONDARY FOR BETTER PERFORMANCE., (ITALIAN WEBER, NOT REPRO) MANUAL CHOKE	SC50W*	307.00
ELECTRIC CHOKE MODEL	SC50E	335.00
WEBER AIR CLEANER FOR ABOVE, CHROME	AF54	39.95
LINKAGE FIREWALL TO CARB SECTION	SC50L	38.00

STROMBERG CARB PARTS (S.V)

DESCRIPTION	PART #	PRICE
GAS LINE T FITTING, PLASTIC	TF5	26.50
RUBBER DIAPHRAGM	RK51	8.20ea
METERING NEEDLE	RK52	9.00ea
STROMBERG NEEDLE & SEAT	RK53	IN RK50
GASKET AND "O" RING SET	RK55	16.80ea
CARBURETOR CHOKE CABLE CLIP	RK56	2.00
DAMPER ASSEMBLY	RK58	NLA
DAMPER SPRING	RK59	NLA
THROTTLE SHAFT, FRONT OR REAR	RK60	16.00ea
METAL BUSHING FOR THROTTLE SHAFT	RK60B	9.95ea
RUBBER-BRASS WELL-NUT TO SECURE FIRE WALL BRACKET (3 NEEDED), ALPINE IV-V	RK61	2.75ea

FACTORY TIMING SPECIFICATIONS

ALPINE S. I-III	HIGH COMP.	5-7° B.T.D.C.
	LOW COMP.	6-10° B.T.D.C.
ALPINE S. IV		6-10° B.T.D.C.
ALPINE S. V	HIGH COMP.	6-10° B.T.D.C.

BECAUSE OF THE LOWER OCTANE GASOLINE AVAILABLE, WE RECOMMEND THAT YOU SET YOUR TIMING IN THE 3-9° BTDC RANGE. SET TO THE LOWER SIDE OF THE RANGE IF NEEDED TO AVOID PINGING WHICH CAUSES PISTON DESTRUCTION AND CONSEQUENT HEAD DAMAGE. USE HIGH OCTANE UNLEADED WITH AN ADDITIVE IF YOU EXPERIENCE PINGING.

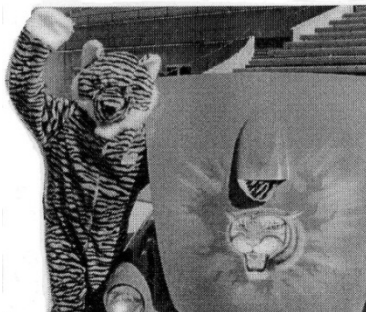

TORQUE & VALVE LASH SPECS

TORQUE SPECS	S. I 1494cc	S. II-IV 1592cc	S. V 1725cc
CYL. HEAD	48 FT/LB	48 FT/LB	48 FT/LB
ROD CAPS	20 FT/LB	24 FT/LB	24 FT/LB
MAIN BEARINGS	55 FT/LB	55 FT/LB	55 FT/LB
FLYWHEEL	40 FT/LB	40 FT/LB	40 FT/LB

VALVE LASH, HOT	INTAKE	EXHAUST
	0.012	0.014

ALPINE BILLET TIMING COVER AND FRONT OIL SEAL KIT. THE STOCK ALPINE ENGINE IS DESIGNED WITHOUT AN OIL SEAL AND HAS A REVERSE SPIRAL GROOVE ON THE CRANKSHAFT PULLEY TO PREVENT OIL LEAKAGE. THIS SYSTEM WAS LESS THAN 100% EFFECTIVE. THIS KIT REPLACES THE ORIGINAL SHEET METAL COVER WITH AN ATTRACTIVE MACHINED TIMING COVER WITH SEAL AND METAL SLEEVES TO INSTALL ON THE PULLEY TO PROVIDE A SMOOTH SURFACE FOR THE SEAL.

KIT WITH BARE ALUMINUM COVER WITH SEAL	TC1A	250.00
CRANKSHAFT BALANCER W/O GROOVE FOR ABOVE COVER	A1228154	299.50
SLEEVE FOR BALANCER (IF NEEDED FOR OLD BALANCER)	TC2S	32.50



NEW 1725cc SHORT BLOCK

FACTORY NEW 1725cc SHORT ENGINE. BRAND NEW 1725 SHORT BLOCK INCLUDES THE NEW ENGINE BLOCK, CRANKSHAFT, CONNECTING RODS AND LOW-COMPRESSION PISTONS, BEARINGS, AND PLUGS. WHY SPEND A FORTUNE REBUILDING YOUR OLD ENGINE WHEN IT CAN BE REPLACED FOR A VERY SMALL PRICE. NO CAMSHAFT, CYL. HEAD OR OIL PUMP. MADE IN THE 1980'S BUT RUST FREE. PT. #AE55B \$1525.00

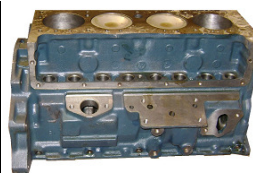

FUEL PUMPS & PARTS

APPLICATION	PUMP	REPAIR KIT	GLASS BOWL
ALPINE S. I-V	FP50 39.50	FP51 22.50	FP52 NLA

FP50 IS AN AFTERMARKET PUMP & DOES NOT HAVE THE GLASS BOWL. FP52 FITS THE ORIGINAL PUMP & SOME AFTERMARKET ONES.

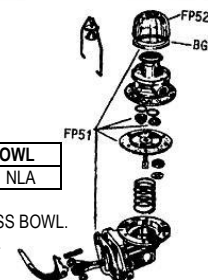

CLUTCHES & PARTS

NOTE: PICTURE REFERENCE NUMBERS ARE IN PARENTHESIS

APPLICATION	SIZE	SPLINE	COVER (1)	DISC (2)	RELEASE BEARING (3)	PILOT BUSHING (5)	RING GEAR (6)
ALPINE SERIES I	8"	10 X 1"	NEW PP1 195.00	NEW CD3 88.75	TB2* 39.95	PB5 17.95	RN5 110.00
ALPINE SERIES II & III TO B9204717	8" Note A	10 X 1"	NEW PP2 (CALL US)	NEW CD3 88.75	TB2* 39.95	PB5 17.95	RN5 110.00
ALPINE SERIES III & IV, S. III FROM B9204718	8" Note A	10 X 1"	NEW PP3 125.00	NEW CD3 88.75	TB2* 39.95	PB5 17.95	RN5 110.00
S. IV FROM B9400001 TO B94100001	8" Note A	10 X 1"	NEW PP3 125.00	NEW CD3 88.75	TB2* 39.95	PB5 17.95	RN5 110.00
ALPINE SERIES IV LATE (FROM B94100001 ON)	7-1/4"	10 X 1"	NEW PP5 N.L.A.	NEW CD4 98.00	TB5* 39.95	PB5 17.95	RN5 110.00
ALPINE SERIES V UP TO B395017308	7-1/4"	10 X 1"	NEW PP5 N.L.A.	NEW CD4 98.00	TB5* 39.95	PB5 17.95	RN5 110.00
ALPINE SERIES V LATE (FROM B395017309 ON)	7-1/5"	25X1-1/16"	NEW PP5 N.L.A.	NEW CD5 90.00	TB5* 39.95	PB5 17.95	RN5 110.00

*ORIGINAL CARBON TYPE THROW-OUT BEARING

NOTE A: SERIES II & III CLUTCH PRESSURE PLATES WILL ACCEPT AN 8-1/2 CLUTCH DISC INSTEAD OF 8". LET US KNOW IF YOU WOULD PREFER THE LARGER DISC. (PRICE MAY CHANGE)

SPLINE EXAMPLE: 10 X 1" MEANS THE TRANSMISSION INPUT SHAFT HAS 10 SPLINES AND A DIAMETER OF 1 INCH. (ONE INCH = 2.54cm)

PICT. REF.#	DESCRIPTION	PART #	PRICE
(9)	CLUTCH ALIGNMENT SHAFT, 10 SPLINE ONLY, ALP.I-V TO B395017308*	AC53	10.95
(11)	DOWEL PIN TO ALIGN CLUTCH PRESSURE PLATE, ALPINE S.I-V	AC55	1.45ea
(12)	RUBBER BOOT FOR BELLHOUSING	AC50	19.25

* HINT FOR A 25 SPLINE CLUTCH DISC, BUY A CHEAP WOODEN ALIGNMENT SHAFT AT AN AUTO PARTS STORE WHERE 1 OR BOTH OF THE DIAMETERS IS TOO SMALL. WRAP MASKING TAPE AROUND THE UNDERSIZED DIAMETERS UNTIL THEY ARE A SLIP FIT TO THE CLUTCH DISC AND PILOT BEARING.

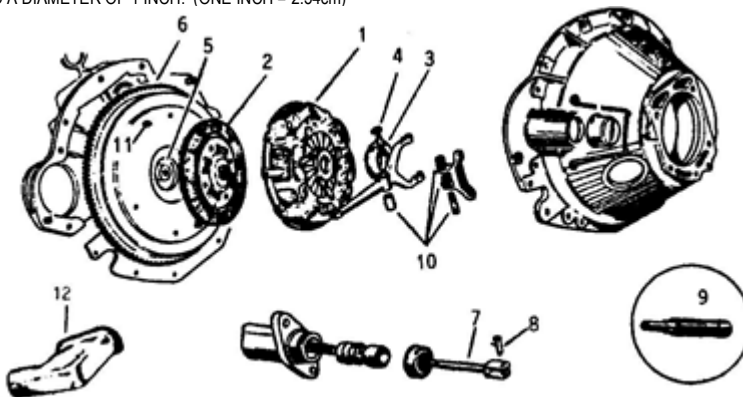

SHOCK ABSORBERS

APPLICATION		STOCK TYPE	KYB GAS SHOCKS		KONI, NEW VERSION	
ALPINE SERIES I-III,	FRONT	SA30 NLA	SA30G	59.95ea		
ALPINE SERIES I-III	REAR	SA21* NLA				
ALPINE IV, V, & TIGER	FRONT	SA50 31.25ea	SA50G	78.75ea	SA50KM**	235.00ea
ALPINE IV-V, & TIGER	REAR	SA51 39.75ea	SA51G	74.50ea	SA51KM**	235.00ea

KYB
World Class Shocks & Struts

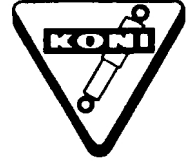

**NEW KONI'S ARE EASILY ADJUSTABLE BY A ROTATING SHAFT IN THE CENTER OF EACH ROD. THE RIDE IS NOT AS HARSH AS IN THE PAST.

KYB GAS SHOCKS ARE NOT ADJUSTABLE. THEY HAVE A GAS CHARGE THAT WILL LIFT AN ALPINE ABOUT 1/2" TO 1" HIGHER.

TRANSMISSION, NON-SYNCR0 1st GEAR ONLY

Alpine I-IV (Early)

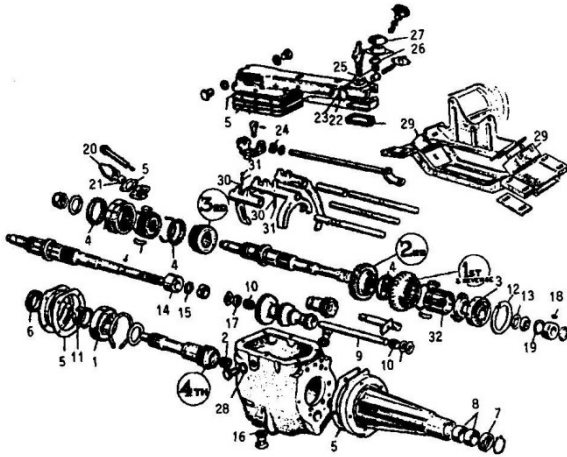

PICT REF#	DESCRIPTION	PART #	PRICE
1	INPUT SHAFT BEARING	TR50	54.60
2	INPUT SHAFT ROLLER SET OF 27	TR31	7.40set
3	MAIN SHAFT BEARING	TR52	56.75
4	SYNCHROMESH RING	TR53	32.25ea
5	GASKET SET	TR54	10.75set
PICT			

REF#	DESCRIPTION	PART #	PRICE
6	FRONT SEAL	TR35	11.95
7	REAR SEAL	TR46	13.95
8	REAR DRIVESHAFT BUSHINGS	TR47	N.L.A.
9	LAYSHAFT FOR CLUSTER GEAR	TR59	46.90
10	LAYSHAFT ROLLER SET OF 54	TR60	14.80set
11	LOCK RING	TP055507	1.95
12	RETAINING RING, MAIN SHAFT BRG.	TP055516	4.50
13	TABWASHER FOR NYLON SPEEDO WHEEL	T1210201	4.80
14	CAM, OVERDRIVE PUMP	T1218172	N.L.A.
15	CIRCLIP, FROM B9119093 ON	T9207036	1.75
16	GASKET, DRAIN PLUG	DG5	1.25
17	ABUTMENT RING, LAYSHAFT	TP027766	6.50
	WASHER, TOP COVER TO CASE	T9664163	0.25ea
18	KEY, SPEEDO DRIVE WHEEL	T9213001	2.80
19	CIRCLIP, SPEEDO WHEEL	T9205053	2.75
20	BEARING, SPEEDO PINION, NON OD	TP108159	9.75
21	SEAL, SPEEDO DRIVE, NON OD	T9102005	5.10
	TOP COVER SHAFT BUSHING	T1216520	5.50
22	DAMPER PAD, FROM B9119268 ON	T1216453	4.75
23	SPRING FOR PAD, FR.B9110013 ON	T1208352	3.50
24	WASHER SPRING	T9086011	5.65ea
25	SPRING, GEARSHIFT LEVER	T1205203	5.90
26	DISC, GEARSHIFT LEVER	T1203071	6.75
27	GROMMET FOR CAP, GEARSHIFT LEVER	T1216103	8.20
28	WASHER, OD SWITCH PLUG	T9078033	0.60
29	TRANSMISSION MOUNT	T1206582	22.75ea
30	SPRING, DETENT BALL	TP055557	3.80ea
31	BALL FOR DETENT	T9187006	2.65

OVERDRIVE PARTS

PICT REF#	DESCRIPTION	PART #	PRICE
1	GASKET & O-RING SET, COMPLETE	TR54OD	25.00
2	"O" RING, USE TR54OD	T9107014	N.L.A.
3	BALL	T9187005	1.48
4	OPERATING VALVE (FROM S. II B91082391)	T5039191	14.75
5	BALL	T9187008	2.75
	RELIEF VALVE KIT	T5042631	47.75
6	FILTER (FROM UNIT #25/3046/002 160)	T5038860	N.L.A.
7	SEALING WASHER	TK025902	6.00
8	GASKET, USE TR54OD	T5038872	N.L.A.
9	BEARING	T9188075	N.L.A.
10	SPRING RING	T9205025	2.50
11	TAB WASHER, SOLD EACH	TK024221	0.60ea
12	SUN WHEEL	T5037080	N.L.A.
	NEEDLE ROLLER, SET OF 6	T9196000	24.75set
13	FREE WHEEL	T5037403	46.25
14	ROLLER, SET OF 12	TK024237	12.70set
15	CAGE	TK024238	6.50
16	SPRING RING	T5037420	6.25
18	BEARING, REAR	T9197031	N.L.A.
19	BEARING NEEDLE ROLLER	T9196003	N.L.A.
20	SHIM, .008"	T9071100	2.00ea
21	REAR COVER, BUSHED	T5041014	N.L.A.
22	OIL SEAL	TR46	13.95
23	CIRCLIP	T9204028	2.75
	PINION BEARING, S. III ON	T5031113	35.85
24	RUBBER RING	T9107058	2.35
25	PISTON RING FOR OP. PISTON	T9107041	N.L.A.

OVERDRIVE ELECTRICS

PICT. REF.#	DESCRIPTION	PART #	PRICE
26	SOLENOID SWITCH, O.D. UNIT	T5039747	N.L.A.
27	OVERDRIVE SWITCH ON GEARBOX	T1800253	21.40
28	OVERDRIVE RELAY UNIT, S.I-II	ME50	61.40
29	OVERDRIVE RELAY UNIT, S.III-V	NOT AVAIL*	N.L.A.

*ME50 CAN BE USED WITH A MINOR WIRING CHANGE. REQUEST THE TECH TIP.

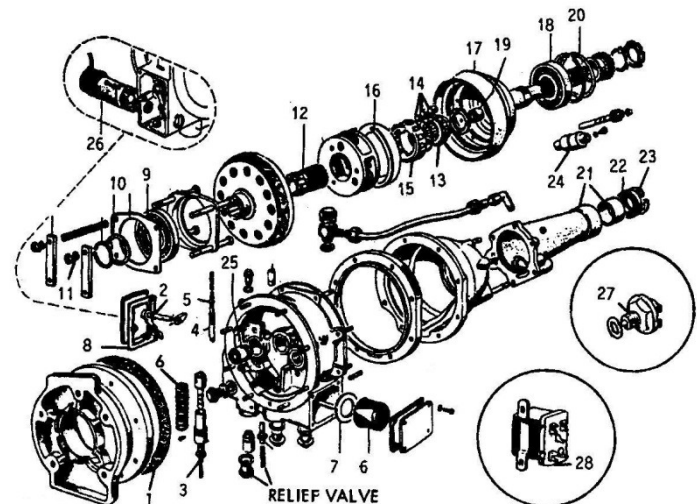

ALL-SYNCHRO ALPINE IV-V TRANSMISSION (FROM S.IV B94100001 ON)

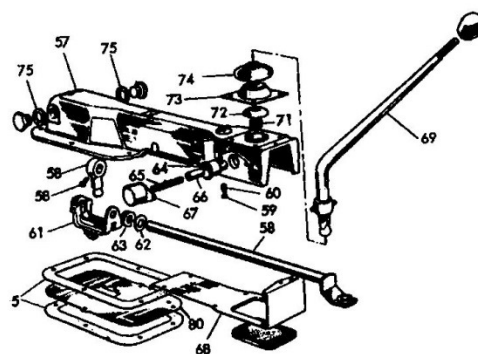
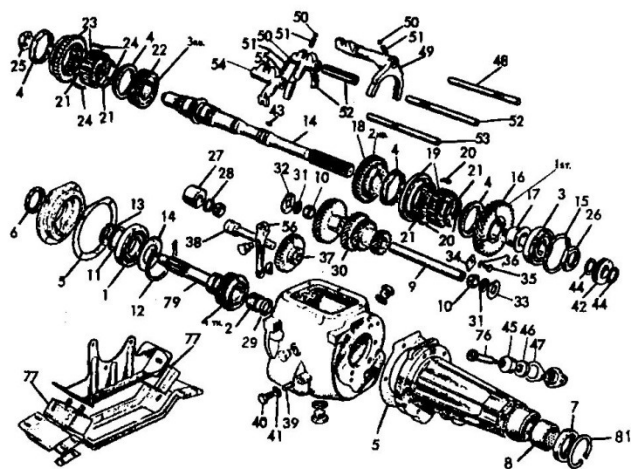

PICT. REF.#	DESCRIPTION	PART #	PRICE
1	INPUT SHAFT BEARING	TR50	54.60
2	INPUT SHAFT ROLLER, SET OF 23	TR51	8.45
3	MAIN SHAFT BEARING	TR52	56.75
4	SYNCHROMESH RING, SOLD EACH	TR53	32.25ea
5	GASKET SET	TR54	10.75
6	FRONT SEAL	TR55	10.80
7	REAR SEAL, SERIES IV FR.B94100000	TR46	13.95
7	REAR SEAL, ALL SERIES V	TR56	13.75
8	DRIVESHAFT REAR BUSHINGS SERIES IV FROM B94100000	TR47	N.L.A.
8	DRIVESHAFT REAR BUSHING, ALL S. V	TR57	19.60
9	LAYSHAFT FOR CLUSTER GEAR	TR59	46.90
10	ROLLER SET FOR LAYSHAFT, SET OF 54	TR60	14.80set
11	WASHER, .058/.060"	T9071158	2.85
11	WASHER, .054/.056 »	T9071159	2.90
12	RING	T1224593	7.40
13	RING	TP055507	1.95
14	SHIELD FOR FRONT BEARING	T9071086	8.10
15	RETAINING RING	TP055516	4.50
16	1 ST GEAR	T1224527	N.L.A.
17	DISTANCE PIECE	T1224545	49.90
18	2 ND GEAR	T1224530	146.25
19	SYNCHRO HUB AND SLEEVE 1 ST -2 ND , TO B395017308	T1228905	N.L.A.
19	SYNCHRO HUB AND SLEEVE 1 ST -2 ND FROM B395017309	T5221245	153.95
20	SHIFTING PLATE (ORDER 3 PER CAR)	T1224547	3.90ea
21	CIRCLIP	T1224540	N.L.A.
22	3 RD GEAR	T1224532	N.L.A.
23	3 RD -4 TH SYNCHRO HUB WITH REVERSE, UP TO B395017308	T1228906	N.L.A.
23	3 RD -4 TH SYNCHRO HUB WITH REVERSE FROM B395017309	T5221246	N.L.A.
24	SHIFTING PLATE (ORDER 3 PER CAR)	T1224544	3.35ea
25	NUT, FRONT OF MAINSHT	T1217970	7.75
26	NUT, REAR OF MAINSHAFT	T9029209	7.60
	TABWASHER FOR OD CAM	T1210201	4.80
28	CIRCLIP	T9207036	1.48
29	COLLAR FOR ROLLER SET	T1224578	8.65
30	LAYSHAFT CLUSTER, S. IV FR, B94100000	T1224510	234.80
30	LAYSHAFT CLUSTER, S. V ALL	T1224511	N.L.A.
31	ABUTMENT RING	TP027766	6.50
32	THRUST WASHER, .060-.058	T1224503	5.95
32	THRUST WASHER, .063-.061	T1224504	6.85
32	THRUST WASHER, .066-.064	T1224505	6.25
32	THRUST WASHER, .069-.067	T1224506	5.95
33	THRUST WASHER, REAR	T5220868	6.45

PICT. REF.#	DESCRIPTION	PART #	PRICE
34	LOCKING PLATE	T1224509	4.30
35	SCREW	T9604031	1.40
36	WASHER	T9664163	0.25
37	REVERSE IDLER GEAR	T1229538	87.75
38	SPINDLE, REVERSE IDLER	T1224513	37.95
39	PIN	T9146192	3.25
40	SCREW	T5220691	2.80
41	WASHER	T9078012	0.45
42	SPEEDO DRIVING WHEEL, B395017309 ON	T1236713	17.95
43	KEY, SPEEDO DRIVE WHEEL	T9213001	2.80
44	CIRCLIP, TO B395017308	T9205053	2.75
44	CIRCLIP, FROM B395017309	T9205068	2.55
45	BEARING, SPEEDO PINION NON-O.D.	TP108159	9.75
46	SEAL, SPEEDO DRIVE NON-OVERDRIVE	T9102005	5.10
47	GASKET, SPEEDO GEAR (NON OD)	T1219684	0.60
48	SHIFT ROD 1 ST -2 ND	T1229302	N.L.A.
49	SHIFT FORK, 1 ST -2 ND	T1229303	N.L.A.
50	BALL, SOLD EACH	T9187008	2.75ea
51	DETENT SPRING, SOLD EACH	TP082493	2.65ea
52	SHIFT FORK & ROD, 3 RD -4 TH IMPROVED	T1239823	N.L.A.
53	SHIFT ROD, REVERSE	T1229305	22.75
54	SHIFT FORK, REVERSE	T1229304	61.35
55	SHIM, .020 »	T9071002	2.25
56	RELAY LEVER WITH PIN	T1238332	30.50
57	TOP COVER WITH BUSHING	T1228258	N.L.A.
	TOP COVER BUSHING ONLY	T1216520	5.50
58	SHAFT WITH LEVER FROM 8395014026	T1239011	59.55
59	DAMPER PAD	T1216453	4.75
60	SPRING FOR PAD	T1208352	3.50
61	SELECTOR SAFETY CATCH	T1228222	23.75
62	WASHER, PLAIN, SOLD EACH	T9067056	0.35ea
63	WASHER, SPRING	T9086011	5.65ea
64	PLUNGER, REVERSE STOP	T1228371	11.60
65	SPRING FOR PLUNGER	T1228720	5.60
66	RUBBER SLEEVE FOR SPRING	T1228718	3.25
67	RETAINER	T1228719	5.05
68	CLOSING PLATE	T1239013	N.L.A.
69	GEARSHIFT LEVER	T1239662	N.L.A.
71	SPRING	T1205203	5.90
72	DISC	T1203071	6.75
73	CAP	T1228274	9.50
74	GROMMET FOR CAP	T1216103	8.70
75	WASHER	T9078033	0.60
76	PINION, NON OD, 13 TEETH	T1207586	21.05
76	PINION, NON OD, 14 TEETH	T1207587	21.05
77	RUBBER MOUNT, TRANSMISSION, 2 REQ.	T1206582	22.75ea
80	OIL SHIELD, TOP COVER	T1240433	7.45
81	CIRCLIP FOR REAR SEAL & BUSHING	T9204035	8.10

GEAR RATIOS

ALL-SYNCHRO GEAR RATIOS,	ALPINE S.IV	ALPINE S.V
REVERSE	3.569:1	3.320:1
FIRST	3.353:1	3.120:1
SECOND	2.141:1	1.990:1

THIRD	1.392:1	1.295:1
FOURTH	1.000:1	1.000:1

MISCELLANEOUS SPECS.

LAYSHAFT END FLOAT	0.006/0.008"
FIRST GEAR END FLOAT	0.004/0.009 »
TORQUE, MAINSHAFT NUTS	80 FT. LBS.

ALPINE REAR AXLE

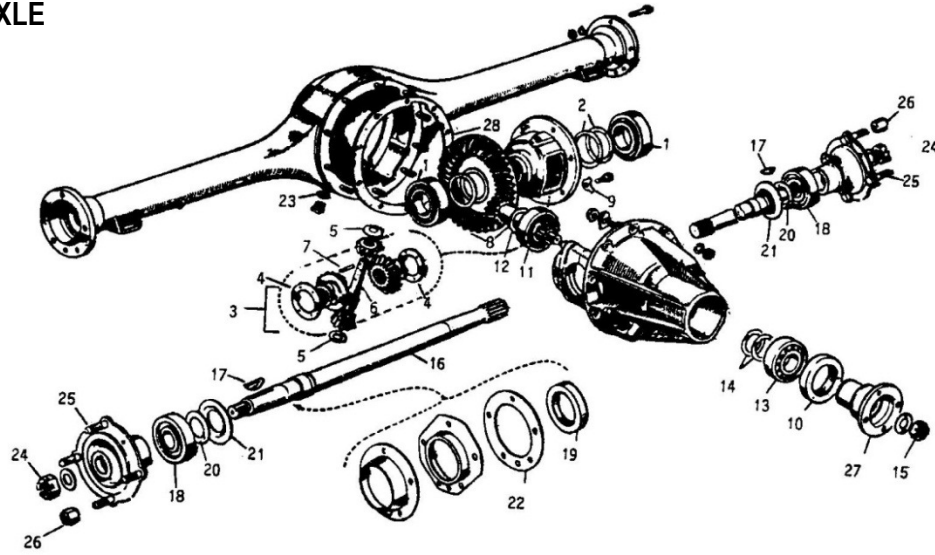

PICT. REF.#	DESCRIPTION	PART #	PRICE
	DIFFERENTIAL, 3.889:1.S.II-V (A)	R1238650	N.L.A.
	DIFFERENTIAL, 4.222:1.S.II-V (A)	R1238651	N.L.A.
1	BEARING, DIFF. BOX HOUSING	R9192057	34.50ea
2	SHIM, .003"	R9071088	N.L.A.
2	SHIM, .010"	R9071090	N.L.A.
2	SHIM, .020"	R9071134	N.L.A.
	ABUTMENT WASHER	R1219400	4.70
3	WHEEL & PINION SET, FROM S. II AFTER B9108431	R5220524	N.L.A.
4	THRUST WASHER	R5220887	5.25ea
5	THRUST WASHER, PINION	R1207649	2.75
6	CROSS PIN	R1200403	17.00ea
7	LOCK PIN FOR CROSS PIN	R9146061	3.70ea
8	RING AND PINION, 3.889:1	R5220639	175.00
	BOLT, SPECIAL, RING GEAR RETAINING	R9003197	3.50 ea
9	TAB WASHER	R1207927	1.35
10	OIL SEAL, PINION (B)	R5220439	11.80
10	OIL SEAL, PINION (C)	R5221256	13.55
11	INNER BEARING, PINION	R9192029	38.40
12	SHIM, .003" INNER BEARING	R9071147	N.L.A.
12	SHIM, .005" INNER BEARING	R9071148	N.L.A.
12	SHIM, .010" INNER BEARING	R9071149	N.L.A.
12	SHIM, .020" INNER BEARING	R9071133	2.65ea
13	OUTER BEARING, PINION (B)	R9192009	38.50
13	OUTER BEARING, PINION (C)	R9192134	37.60
14	SHIM, .003", OUTER BEARING	R9071049	N.L.A.

NOTES (A) FROM SERIES II FROM B9108158 ON
 (B) UP TO B395013608 (LATE S. V)
 (C) FROM B395013609 (LATE S. V)

PICT. REF.#	DESCRIPTION	PART #	PRICE
14	SHIM, .005", OUTER BEARING	R9071050	N.L.A.
14	SHIM, .010", OUTER BEARING	R9071051	N.L.A.
14	SHIM, .020", OUTER BEARING	R9071132	1.30ea
15	NUT, NYLOC, SOLD EACH	R9034035	7.95ea
16	AXLE WITH SLEEVE, SERIES V, EACH	R5220957	N.L.A.
17	KEY FOR AXLE, SOLD EACH	R9213027	3.75ea
18	AXLE BEARING, SERIES I-IV, 2 REQ.	R9188096	46.75 ea
19	BEARING SEAL, SERIES I-IV, 2 REQ.	R9102145	12.80ea
18	AXLE BEARING, SERIES V, 2 REQ.	R1801176	58.75ea
	"O" RING FOR BEARING, S. V, 2 REQ.	R9107158	3.85ea
20	INNER SPLASH GUARD, S. V, 2 REQ.	R1235746	N.L.A.
21	OUTER SPLASH GUARD, S. V, 2 REQ.	R1235750	N.L.A.
22	GASKET, .006", (S.I-IV USE 6 PER CAR, S.V USE 2 PER CAR)	R1229702	2.35ea
22	GASKET, .010", (S.V USE 2 PER CAR)	R1229698	2.35ea
23	GASKET, DRAIN PLUG	DG5	1.25ea
24	NUT FOR HUB, ALL SERIES, 2 REQ.	R9552123	10.75ea
25	LUG BOLT, 4 PER WHEEL	R1214407	4.90ea
26	LUG NUT, 4 PER WHEEL	R1108015	4.60ea
27	PINION TO U-JOINT FLANGE	R1236702	67.85
28	GASKET, DIFFERENTIAL TO HOUSING	RP022341	4.75
	WHEEL BALANCE WEIGHT, .5 OZ.	R1235513	0.80ea
	WHEEL BALANCE WEIGHT, 1.0 OZ.	R1235514	0.80ea
	WHEEL BALANCE WEIGHT, 1.5 OZ.	R1235515	0.90ea
	WHEEL BALANCE WEIGHT, 2.0 OZ.	R1235516	0.95ea

ALPINE & TIGER REAR SUSPENSION

PICT. REF.#	DESCRIPTION	PART #	PRICE
1	LARGE RUBBER ECCENTRIC BUSHING FRONT SPRING EYE, ALPINE III-V, TIGER	RS50	21.95ea
1	LARGE URETHANE ECCENTRIC BUSHING FRONT SPRING EYE, ALPINE III-V, TIGER	RS50U	25.80ea.
2	SMALL BUSHING FOR SPRING EYE, FRONT & REAR, ALPINE S.I (4/CAR) FRONT ONLY S. II (2/CAR)	RS21	18.55ea
2	SPRING EYE BUSHING ALPINE II, REAR	RS51	13.50ea
3	SMALL BUSHING FOR REAR SPRING EYE & SPRING SHACKLE BUSHINGS, 4 PER CAR, ALPINE III-V & ALL TIGER.	RS51	12.90
4	SPRING WRAP RUBBER SET FOR 2 SPR.	RS53	16.20
	TEFLON THRUST BUTTON BETWEEN SPRING LEAFS	RS54	3.95ea
5	TIGER PANHARD ROD, COMPLETE W/O BUSHINGS OR ANCHOR BRACKET	RS55T	NLA
	BUSHING SET FOR PANHARD ROD	RS55B	29.95
	TRACTION BAR BUSHINGS, SET OF 8	FS68B	39.70
	TRACTION MASTER KIT, TIGER	FS68	205.00

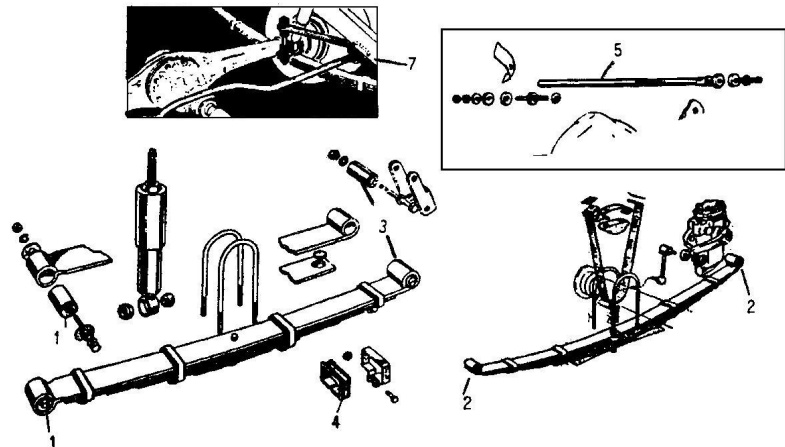

SUSPENSION ALPINE IV-V, TIGER

ALPINE I-III

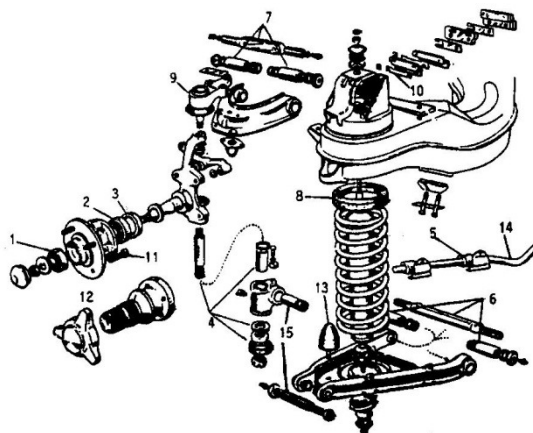
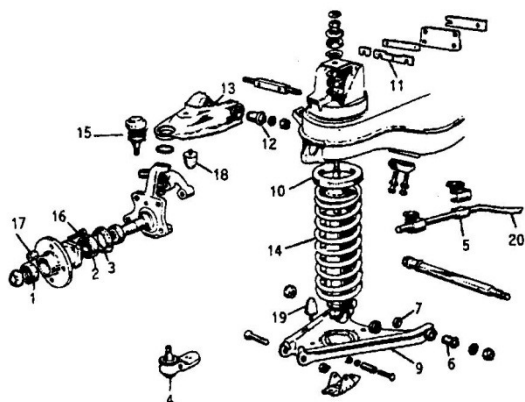

REF.#	DESCRIPTION	PART #	PRICE
1	OUTER WHEEL BEARING	FS50	12.75ea
2	INNER WHEEL BEARING	FS51	28.95ea
3	GREASE SEAL	FS52	14.80ea
4	LOWER BALL JOINT, PAIR	FS53	97.50pr
5	RUBBER SWAY BAR BUSHING, STOCK 3/4" BAR	FS54	4.90ea
5	RUBBER SWAY BAR BUSHING, HD 7/8" BAR	FS54L	4.60ea
6 & 12	UPPER & LOWER A-FRAME BUSHING SET, URETHANE SET OF 8 WITH INNER & OUTER METAL SLEEVES.	FS78	137.50set
6	METAL-RUBBER TYPE LOWER BUSHING	FS55	16.90ea
12	METAL-RUBBER TYPE UPPER BUSHING	FS59	14.50ea
7	SPECIAL WASHER FOR LOWER BUSHING	FS63	4.95ea
10	RUBBER INSULATOR FOR COIL SPRING	FS56	15.50ea
11	CAMBER ADJUSTING SHIM, .100" THICK	FS58	2.70ea
11	CAMBER ADJUSTING SHIM, .060" THICK	FS58M	2.70ea
13	SPECIAL WASHER FOR UPPER BUSH	FS67	4.95ea
15	UPPER BALL JOINT, PAIR	FS57	74.60pr
16	LUG BOLT, STOCK	R1214407	4.90ea
17	LUG NUT, STOCK FOR STEEL WHEELS	R1108015	4.60ea
18	RUBBER SNUBBER FOR UPPER A-ARM	FS76	13.75ea
19	RUBBER SNUBBER FOR LOWER A-ARM	FS77	13.75ea
	ALUMINUM SPACERS, X MEMBER TO FRAME	FS80	79.50pr

REF.#	DESCRIPTION	PART #	PRICE
1	OUTER WHEEL BEARING	FS50	12.75ea
2	INNER WHEEL BEARING	FS51	28.95ea
3	FRONT HUB GREASE SEAL, S. I & II	FS22	16.95ea
3	S. III	FS52	13.50ea
4	SWIVEL PIN REPAIR KIT	FS33	N.L.A.
5	SWAY BAR BUSH, 5/8" BAR ONLY (NOT 3/4")	FS24	6.30ea
5	SWAY BAR BUSH, 3/4" BAR ONLY (NOT 5/8")	FS54	4.90ea
6	LOWER FULCRUM PIN & KIT, PAIR	FS35	N.L.A.
7	UPPER FULCRUM PIN & KIT, PAIR	FS39	N.L.A.
8	RUBBER INSULATOR	FS56	15.50ea
9	UPPER BALL JOINT, PAIR	FS37	160.00pr
10	CAMBER ADJUSTING SHIM, .100" THICK	FS58	2.70ea
10	CAMBER ADJUSTING SHIM, .060" THICK	FS58M	2.70ea
11	LUG BOLT, STOCK	R1214407	4.90ea
12	LUG NUT, STOCK FOR STEEL WHEELS	R1108015	4.60ea
13	RUBBER SNUBBER FOR LOWER A-ARM	FS77	13.75ea
18	SNUBBER FOR UPPER A-ARM	FS36	8.50ea
	ALUMINUM SPACERS, X MEMBER TO FRAME	FS80	79.50pr

STEERING COMPONENTS

REF.#	DESCRIPTION	PART #	PRICE
1	ALPINE TIE ROD ENDS, 1 LH & 1 RH THREAD.	FS61A	42.60pr
2	ALPINE CENTER CROSS TUBE	FS61C	N.L.A.
	URETHANE BUSHINGS, FOR CROSS TUBE	FS61CBU	28.00pr
3	TIGER TIE ROD ENDS, PAIR	FS61T	44.30pr
4	TIGER RACK & PINION BELLOWS, NOT OEM	FS64T	12.95ea
6	ALPINE I-V IDLER ARM BUSHES, 2 REQ.	FS73A	12.95ea
6	ALPINE STEERING BOX BUSHING.	FS73A	12.95ea
7	BALL BEARING SET FOR ALPINE STEERING BOX, 14 LARGE & 24 SMALL PER SET	FS74A	19.95set
8	RUBBER "O" RING SEAL FOR STEERING BOX OUTPUT SHAFT. FITS ALPINE I-V	FS75A	3.75
	NUT TO RETAIN THE STEERING WHEEL	FS79	9.75

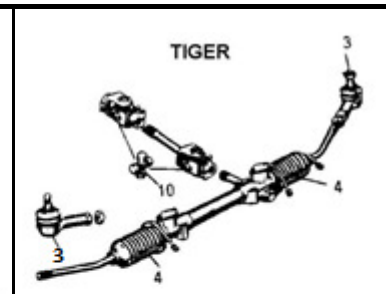
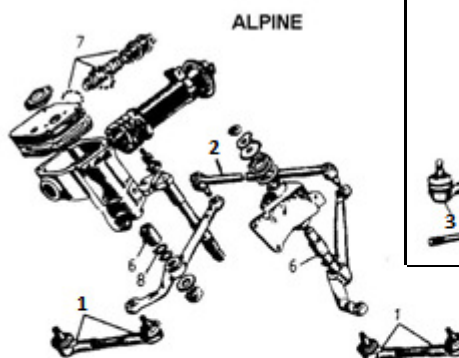

U-JOINTS

REF #	DESCRIPTION	PART #	PRICE
9	ALPINE DRIVESHAFT U-JOINT	UJ50A	24.50ea
9	TIGER DRIVESHAFT U-JOINT	UJ20T	19.95ea
10	TIGER STEERING U-JOINT (WITH ZERKS)	FS65T	25.50ea
11	DRIVESHAFT YOKE, ALPINE 10 SPLINE	UJ51C	55.00
11	DRIVESHAFT YOKE, ALPINE 25 SPLINE	UJ51F	58.75

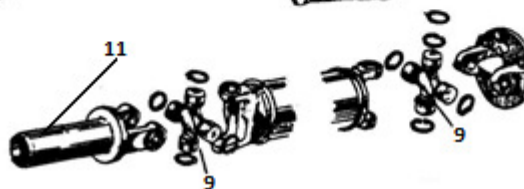

FACTORY ALIGNMENT SPECIFICATIONS

APPLICATION	CASTOR	CAMBER	TOE-IN
ALPINE S. I-V & ALL TIGER	(POSITIVE) 3°_50'	(POSITIVE) 30' ± 15'	1/8" (3 mm)

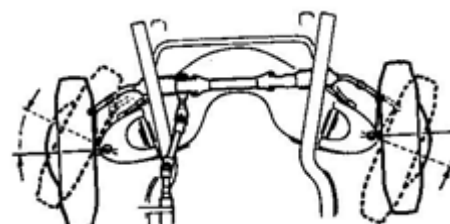

TIGER MK I-II TRANSMISSION

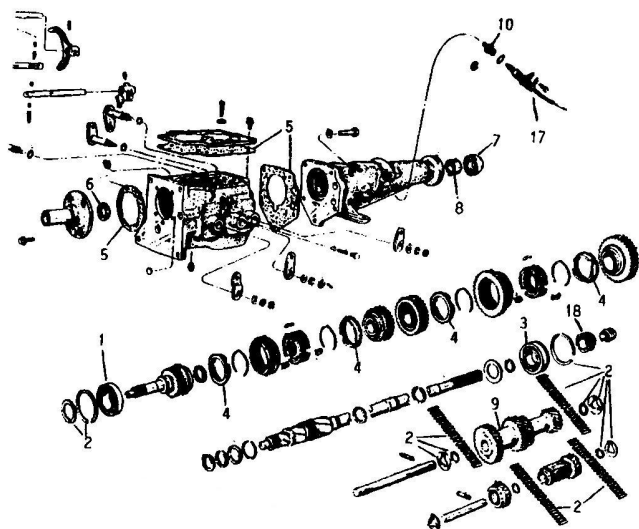

RATIOS	TIGER MK I	TIGER MK II
--Top	1 00:1	1 00:1
--Third	1 29:1	1 36:1
--Second	1 69:1	1 93:1
--First	2 32:1	2 78:1
--Reverse	2 32:1	2 78:1

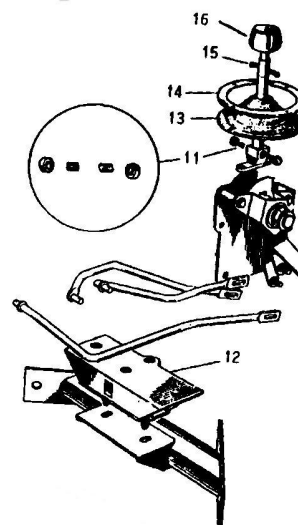

TIGER TOPLOADER PARTS

REF.#	DESCRIPTION	PART #	PRICE
4	SYNCHROMESH RING (4 NEEDED)	TR223T	Not Stocked
5	GASKET SET	TR224T	11.70
6	FRONT SEAL	TR225T	9.50
7	REAR SEAL MK I & II	TR226T	16.95
8	DRIVESHAFT BUSHING IN REAR CASE	TR227T	N.L.A.
9	CLUSTER GEAR, MK I (CLOSE RATIO)	TR128T	N.L.A.
10	CABLE SPEEDO GEAR, MK I,* 16 TEETH	TR235T	13.50
10	CABLE SPEEDO GEAR, MK II 17 TEETH	TR240T	14.80

REF.#	DESCRIPTION	PART #	PRICE
11	TRUNNION & SPRING SET, 2 OF EACH	TR236T	21.80
12	TRANSMISSION MOUNT	TM28	26.50
13	GEARSHIFT BOOT	IP53T	28.45
14	TRIM RING FOR GEARSHIFT BOOT	IP54T	29.45
16	GEARSHIFT KNOB, STOCK	TR237T	19.50
17	SPEEDO CABLE, MK I-IA (NOT MK II)	TR238T	79.25

*THE STOCK MK I-IA GEAR IS 15 TEETH & IS NOT AVAILABLE

TIGER MK I-II COOLING

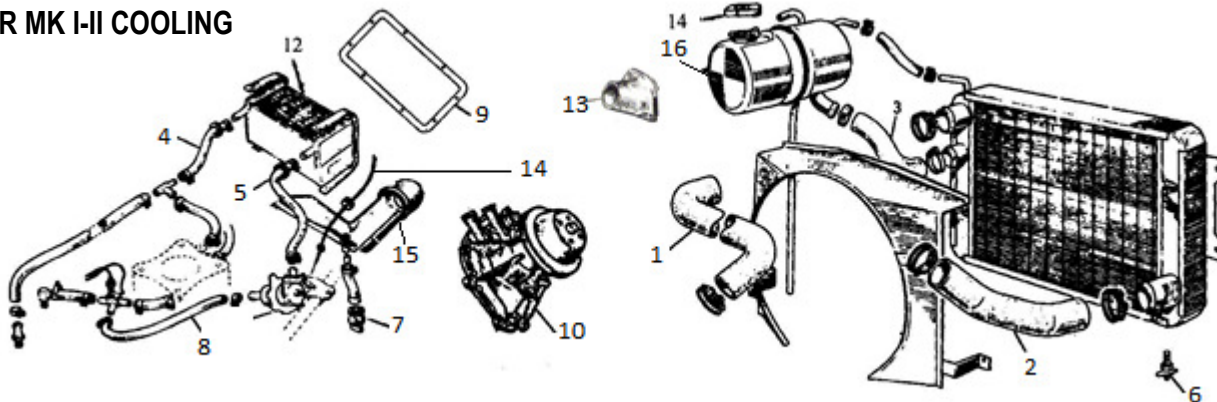

COOLING SYSTEM

1	UPPER RADIATOR HOSE, MOLDED	CS20	24.60
2	LOWER RADIATOR HOSE, MOLDED	CS21	23.80
3	EXPANSION TANK LARGE HOSE, MOLDED	CS22	9.25
4	HOSE, HEATER CORE TO "T" FITTING	CS23	8.50
5	HOSE, HEATER VALVE TO CORE, MK I ONLY	CS12T	17.50
5	HOSE, HEATER VALVE TO CORE, MK IA-II	CS62	15.75
6	BRASS DRAIN TAP, TO B382001894	CS63	7.95
6	PLASTIC DRAIN TAP, FR. B382001895	CS64	9.20
7	DUCKBILL DRAIN END, S.V,MK IA-II, EACH	CS65	12.50
8	HOSE, FITTING TO HEATER VALVE	CS24	10.95
9	GASKET FOR HEATER CORE COVER PLATE	CS66	4.75

10	WATER PUMP, MK I-IA (ALUMINUM)	TM32	112.60
10	WATER PUMP, MK II (CAST IRON TYPE)	TM33	139.50
11	HEATER CONTROL VALVE, ALPINE I-IV, TIGER I	CS45	58.50
	HEATER CONTROL VALVE, TIGER 1A, II*	CS55	NLA
12	HEATER CORE	CS68	192.10
13	THERMOSTAT HOUSING	HA53	21.50
	BYPASS HOSE FOR WATER PUMP, ALL	TM49	9.50
	TEMP SENDER UNIT, P. 15, MISC. ELECTRICAL		
	HEATER CONTROL CABLES, LONG & SHORT	CS69	29.75
14	RAD CAP WITH ZINC ELECTRODE, NOT ORIG	TM45	24.20
15	HEATER CORE DRAIN TROUGH	CS70	47.75
16	TIGER BRASS OVERFLOW TANK	CS71T	498.88

STOCK TIGER ENGINE PARTS

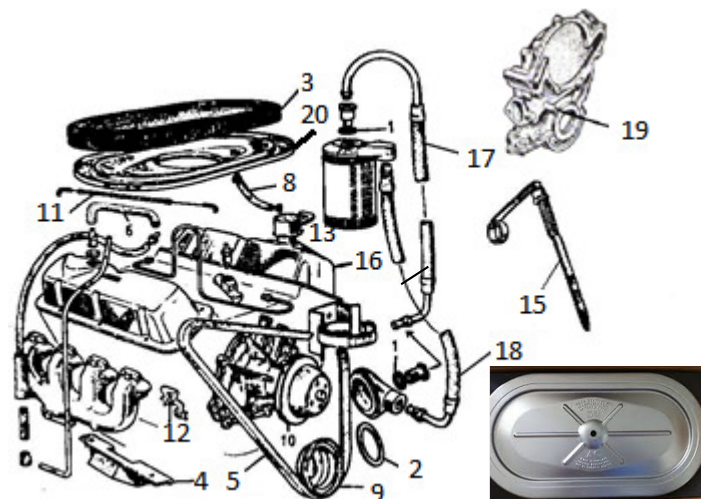

REF.#	DESCRIPTION	PART #	PRICE
1	SMALL FILTER GASKET (2 PER CAR), EACH	TM20	2.25
2	LARGE FILTER GASKET, SOLD EACH	TM21	2.90
3	AIR FILTER ELEMENT, AFTERMARKET	TM24	18.90
3	S & B COTTON FILTER ELEMENT, WASHABLE	TM24S	49.50
	S & B FILTER SERVICE KIT, SOAP & OIL	TM43	AMAZON
	MOTOR MOUNT, LEFT	TM25LH	21.40
4	MOTOR MOUNT, RIGHT	TM25RH	21.40
5	FAN BELT MK I	FB1T	21.90
	FAN BELT MK II	FB2T	22.80
6	HOSE, PCV VALVE TO MANIFOLD, MOLDED	TM30	15.75
8	HOSE, BREATHER TO AIR CLEANER, MOLDED	TM36	17.50
9	CRANKSHAFT PULLEY	TM29	NLA
10	WATER PUMP PULLEY	TM37	NLA
	RING GEAR FOR FLYWHEEL	TM38	84.40
11	THROTTLE CABLE, STOCK 13 1/2" LONG	TM39	34.60
12	LOCKING TABS, EX. MANIFOLD BOLTS, SET	TM42	17.65TR46
13	CHROME OIL FILLER CAP, BREATHER NOT 90°	TM48	27.85
14	CHOK TUBE & KIT, STOCK ENGINES	TM46	28.75
15	DIPSTICK FOR ENGINES WITH GENERATORS	TM50	18.95
16	STOCK STEEL TIGER CHROME VALVE COVERS	TM51	94.00
17	REMOTE OIL FILTER HOSE, LONG (TIGER 1-1A)	TM12	CALL US
18	REMOTE OIL FILTER HOSE, SHORT	TM13	CALL US
19	TIMING CHAIN COVER FOR ALUMINUM TYPE WATER PUMP, TIGER 1 & 1A ENGINES	HA55	145.95
19	TIMING CHAIN COVER FOR CAST IRON TYPE WATER PUMP (MK II TYPE,	HA54	144.00
20	TIGER AIR FILTER HOUSING, TOP & BOTTOM	TM56	498.00

TIGER REAR END PARTS

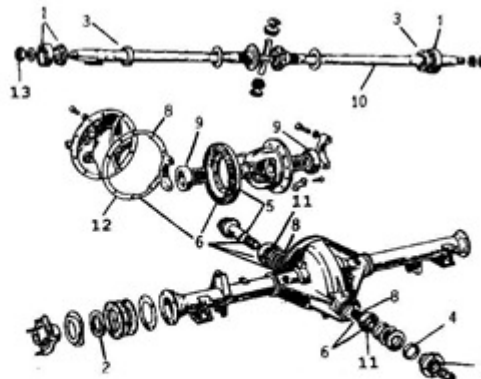

REF.#	DESCRIPTION	PART #	PRICE
1	AXLE BEARING	RA20T	44.25ea
2	AXLE BEARING OUTER SEAL	RA21T	11.80ea
3	AXLE BEARING INNER SEAL	RA25T	16.75ea
4	PINION SEAL	RA22T	22.50
5	RING & PINION, 2.88/1, FACTORY GEARSET	RA27T	N.L.A.
6	TIGER RING & PINION, 3.07/1	RA29T	Not stock
6	TIGER RING & PINION, 3.31/1	RA30T	Not stock
6	TIGER RING & PINION, 3.54/1	RA31T	Not stock
6	TIGER RING & PINION, 3.73/1	RA32T	Not stock
7	DRIVESHAFT PINION FLANGE, FINE SPLINE NEEDED FOR ABOVE RING & PINION UNITS. U-JOINT MOUNTS DIRECTLY ONTO FLANGE.	RA34T	N.L.A.
8	GASKET & SHIM KIT FOR TIGER REAR	RA35T	49.95
9	CARRIER BEARING FOR AXLE, STOCK	RA37T	58.90ea
10	AXLE SHAFT, LH OR RH, STOCK 19 SPLINE	RA38T	275.00ea
10	AXLE SHAFT, LH OR RH, 30 SPLINE**	RA38TF	278.50ea
11	PINION BEARINGS, FRONT & REAR	RA39T	98.20
12	GASKET, DIFFERENTIAL COVER	RA41T	10.95
13	AXLE NUT FOR RETAINING HUB	RA42T	9.50ea

THE STOCK TIGER COURSE SPLINE DRIVESHAFT PINION FLANGE WILL NOT MOUNT ON ANY OF THE ABOVE PINIONS. ORDER THE FINE SPLINE PINION FLANGE PT.# RA34T. CONTACT US BEFORE ORDERING THIS PART
 ** USING 2 RA38TF AXLES ALLOWS A WIDE SELECTION OF MODERN DIFFS.

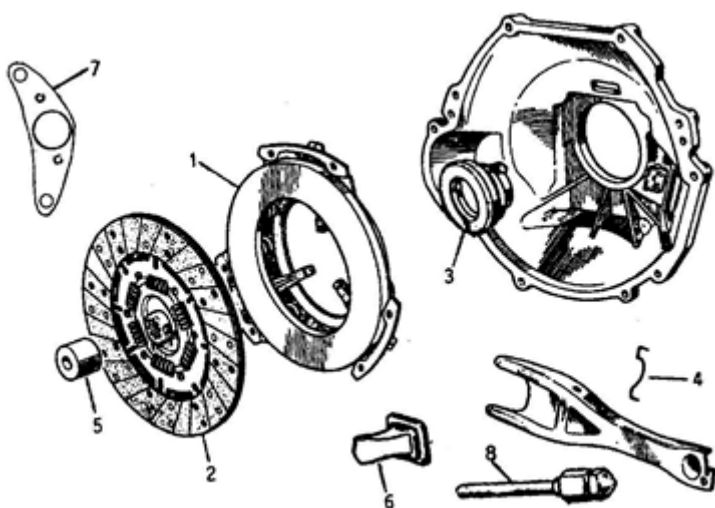

TIGER CLUTCH PARTS

REF.#	DESCRIPTION	PART #	PRICE
1,2,3,5	STOCK TIGER CLUTCH KIT, 10", INCLUDES DISC, PRESSURE PLATE, T/O BRG. PILOT BUSH	HA52	195.00
4	SPRING CLIP FOR ARM	HA46	9.30
5	PILOT BUSHING, BRONZE	HA47	N.L.A.
6	RUBBER BOOT FOR ARM	HA48	28.45
7	SLAVE CYL. BRACKET, 6 BOLT BELLHOUSING	HA49	NLA
8	PUSH ROD FOR CLUTCH SLAVE CYLINDER	HA50	NLA

TIGER SU FUEL PUMP

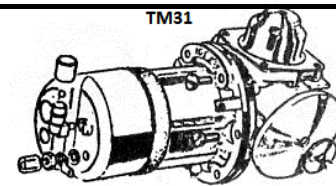

DESCRIPTION	PART #	PRICE
TIGER SU FUEL PUMP, MODIFIED ELECTRONIC VERSION	TM31	205.00
REBUILDING KIT FOR THE TIGER SU FUEL PUMP	TM31K	74.00
FITTING, MALE-MALE, 3/8" BSP-1/2" UNF, PUMP TO PIPE	TM31F	18.50pr
FITTING KIT TO CONNECT TO RUBBER HOSES, CAR SET	TM31B	30.50

HIGH PERFORMANCE CARBURETORS

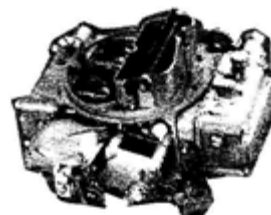

DESCRIPTION	PART #	PRICE
*HOLLEY 1848 465 CFM 4 BBL CARB, GOOD FOR 260 ENGINE ELECTRIC CHOKE	HA33	595.00
HOLLEY 1850 600CFM 4 BBL. CARB. MANUAL CHOKE	HA34	CALL
*HOLLEY 0-80457 AS ABOVE BUT WITH ELECTRIC CHOKE	HA34E	CALL

*WE RECOMMEND YOU BUY THESE ON THE INTERNET.

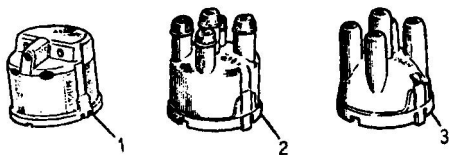

DISTRIBUTOR CAPS (LUCAS DISTRIBUTORS)

REF.#	DESCRIPTION	PART #	PRICE
1	HORIZONTAL OUTLETS (USE AI51 CAP)	AI11	N.L.A.
2	VERTICAL OUTLETS (NUT SECURED LEADS, NUTS INCLUDED)	AI31	18.75
3	VERTICAL OUTLETS (PUSH-IN LEADS)	AI51	18.25

NOTE ALL DISTRIBUTOR CAPS CAN BE INTERCHANGED.

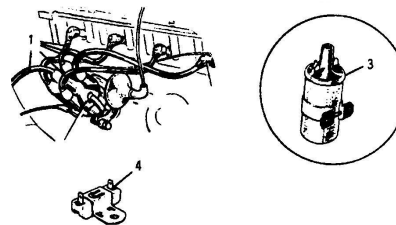

MISCELLANEOUS IGNITION PARTS

REF.#	DESCRIPTION	PART #	PRICE
1	IGNITION WIRE SET, ALL SERIES (PUSH-ON LEADS ONLY, USE AI51 DISTRIBUTOR CAP)	AI61	28.25
3	IGNITION COIL, PUSH-IN LEADS, INTERNAL RESISTOR	AI58	39.20
3	IGNITION COIL, PUSH-IN LEADS, EXTERNAL RESISTOR	AI58E	39.60
4	IGNITION RESISTOR FOR ORIGINAL COIL	ME53A	18.70

DESCRIPTION	PART #	PRICE
PERTRONIX FLAME THROWER LUCAS DISTRIBUTOR, NEW WITH PERTRONIX ELECTRONIC IGNITION. REPLACES DISTRIBUTORS IN NEGATIVE GROUND CARS WITHOUT MECHANICAL DRIVE TACHOMETERS.	AI50PN	255.00
AS ABOVE FOR + GROUND. (S. IV ONLY)	AI50PP	259.00

NOTE: PERTRONIX DISTRIBUTORS NOW USE THE STOCK ALPINE DISTRIBUTOR CAP & ROTOR.

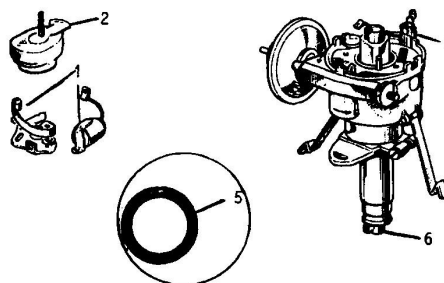

PICTURE REF. #S ARE IN PARENTHESIS

	POINTS & CONDENSER (I)	ROTOR (2)	DIST. TERM.(4) BUSH AND LEAD	O-RING SEAL(5)
ALPINE DISTRIBUTOR PARTS (ALL SERIES)	AI54 19.25	AI55 4.50	AI57 15.75 ALPINE III UP	AI59 3.25

ALPINE I-IV

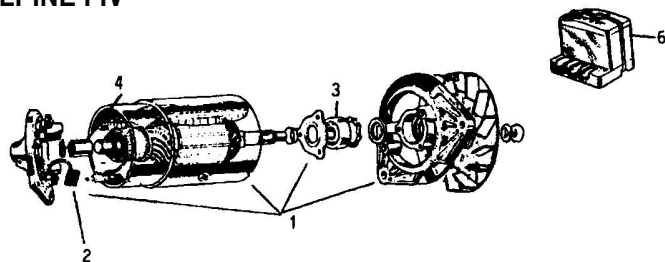

GENERATORS & PARTS

1	GENERATOR, NEW, NO CORE	AD40R	179.80
2	BRUSH SET	AD41	12.90
3	BEARING, DRIVE END BRACKET	AA53	N.L.A.
4	BUSH, NON DRIVEN END	AD44	5.95
6	VOLTAGE REGULATOR, S. I-III	AD35L	79.50
	VOLTAGE REGULATOR, S. IV	AD45L	57.60

ALPINE V

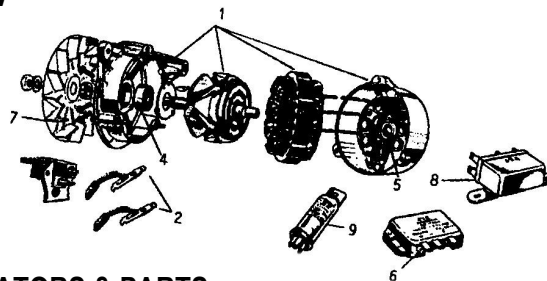

ALTERNATORS & PARTS

1	ALTERNATOR, REBUILT, EXCHANGE	AA50R	N.L.A.
2	BRUSH SET	AA51	12.60
4	BEARING FOR DRIVE END BRACKET	AA53	N.L.A.
5	BEARING FOR NON-DRIVEN END	AA54	N.L.A.
6	VOLTAGE REGULATOR, 4TR	AA55L	68.30
7	FAN & PULLEY, ORIGINAL	AA56	N.L.A.
8	FIELD ISOLATING RELAY	ME50	61.40
9	WARNING LIGHT SIMULATOR RELAY, NOT OEM	ME52	CALL US

STARTERS & PARTS

1	STARTER, NEW, STOCK TYPE, NO CORE	AS50R	165.45
	STARTER WITH SOLENOID, GEAR REDUCTION TYPE HI TORQUE, NIPONDENSO MOTOR NEW	AS50G	245.00
2	STARTER BRUSH SET	AS51	12.80
3	BUSHING FOR DRIVING END BRACKET	AS52	N.L.A.
4	BUSHING FOR COMMUTATOR BRACKET	AS53	N.L.A.
5	STARTER DRIVE ASSEMBLY	AS54	N.L.A.
6	STARTER SOLENOID SWITCH, NO BUTTON	AS55	36.40

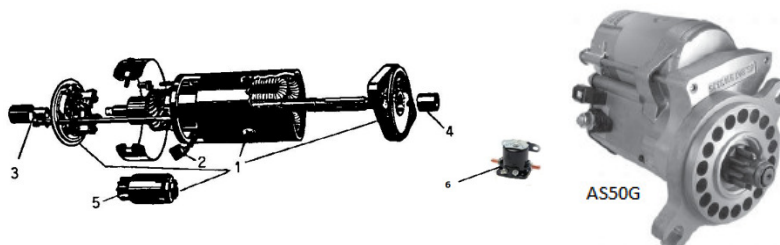

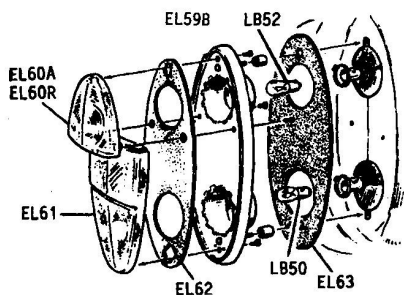

TAIL, STOP, & FLASHER LAMP, ALPINE IV-V, TIGER

DESCRIPTION	PART #	PRICE
LENS, FLASHER, AMBER (INSIDE SCREW, REPRO)	EL60A	17.95ea.
LENS, FLASHER, RED (INSIDE SCREW, REPRO)	EL60R	17.95ea.
LENS, STOP AND TAIL, (INSIDE SCREW)	EL61	31.95ea.
LENS, FLASHER OUTSIDE SCREW, RED	EL64	39.00ea
LENS, FLASHER OUTSIDE SCREW AMBER	EL64A	39.00ea
LENS, STOP/TAIL OUTSIDE SCREW	EL65	49.45ea
LENS SEATING GASKET	EL62	4.85ea
LAMP TO FENDER GASKET	EL63	9.25ea.
BULB, FLASHER LAMP (UPPER)	LB52	1.90ea.
BULB, STOP & TAIL (LOWER)	LB50	2.25ea.
CHROME BEZEL FOR LAMP W/O EL. SOCKETS	EL59B	64.60ea.

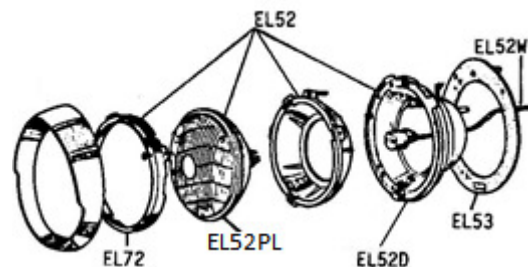

HEADLAMP PARTS, ALL ALPINE & TIGER

DESCRIPTION	PART #	PRICE
HEADLAMP RETAINING RING, CHROME	EL72	24.50ea.
HEADLAMP BUCKET ASSEMBLY WITH HARNESS WITH HALOGEN SEALED BEAM LAMP, METAL	EL52	136.50ea.
LUCAS PL700 QUALITY REPRO TRIPOD TYPE HEADLAMP WITH HALOGEN BULB	EL52PL	79.95ea
HEADLAMP TO FENDER GASKET	EL53	14.50ea.
CLIP, HEADLAMP DOOR TO BUCKET		
CLIP-ON TYPE	EL52C	N.L.A.
SCREW-ON TYPE	EL52D	4.75ea
HARNESS FOR HEADLAMP	EL52W	16.90ea.
ADJUSTING SCREW & SPRING KIT, 1 PER H/L	EL52F	8.75ea

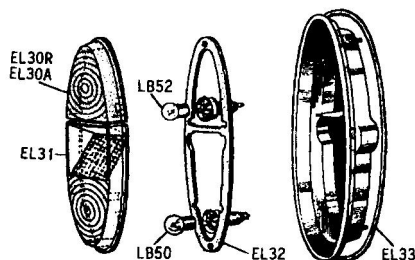

STOP, TAIL, AND FLASHER LAMP, ALPINE S. I-III

GASKET, LENS SEATING	EL32	4.25ea.
GASKET, TAIL LAMP TO BODY	EL33	4.95ea.
BULB, FLASHER (TOP)	LB52	1.90ea.
BULB, STOP-TAIL (BOTTOM)	LB50	2.25ea.
LENS, UPPER (RED)	EL30R	21.40ea
LENS, UPPER (AMBER)	EL30A	21.40ea
LENS, LOWER	EL31	69.95ea

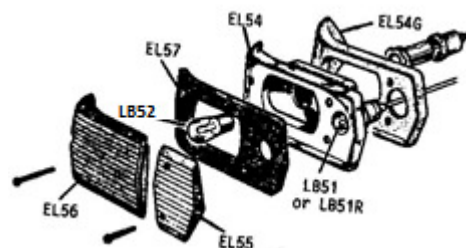

PARKING & SIGNAL LAMP, ALPINE S. IV-V, TIGER

CHROME BODY W/BULB SOCKETS, REPRO.	EL54	134.80ea.
RUBBER LAMP SEATING GASKETS, LH & RH	EL54G	29.95pr.
SCREW SET & "J" CLIPS TO RETAIN EL54 LAMPS	EL54F	6.25set
LENS, SMALL CLEAR	EL55	18.60ea.
LENS, LARGE, AMBER ONLY	EL56	19.95ea.
LENS SEATING GASKET	EL57	4.25ea.
BULB, FLASHER	LB52	1.90ea.
BULB, PARKING FOR OEM LAMP ONLY	LB51	1.60ea.
BULB, PARKING FOR REPRO LAMP ONLY	LB51R	1.85ea.

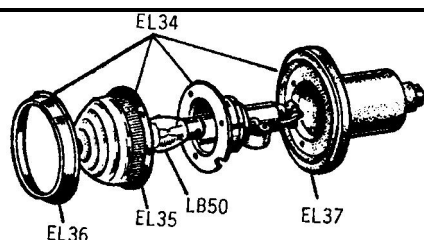

PARKING & SIGNAL LAMP, ALPINE SERIES I-III

LAMP ASSEMBLY, LUCAS	EL34	54.50ea.
LENS	EL35	N.L.A..
CHROME RIM	EL36	8.75ea.
RUBBER BODY	EL37	9.95ea.
BULB	LB50	2.25ea.



MAP LIGHT LENS

LENS, MAP LIGHT (ABOVE CUBBY BOX)	EL70	N.L.A.
BULB	LB54	2.95



DASH WARNING LIGHTS

RED WARNING LIGHT BODY, NOT ORIGINAL	EL75	10.95
GREEN WARNING LIGHT BODY NOT ORIGINAL	EL76	10.95
BLUE WARNING LIGHT BODY NOT ORIGINAL	EL77	10.95
BULB, DASH WARNING LIGHT	LB56	1.85



LICENSE PLATE LAMP, ALPINE IV-V & TIGER

LENS	EL68	N.L.A.
BULB	LB53	1.80ea.

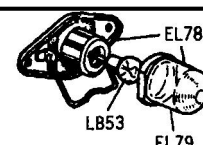

LICENSE PLATE LAMP, ALPINE I - IV TO B94101406

LAMP ASSEMBLY	EL78	N.L.A.
LENS FOR ABOVE	EL79	N.L.A.
BULB	LB53	1.80

SWITCHES, ALPINE & TIGER

APPLICATION	LIGHTING SWITCH LUCAS		PANEL SWITCH		WIPER SWITCH LUCAS		DIMMER SWITCH LUCAS		STOP LIGHT SWITCH		IGNITION & STARTER SWITCH		IGNITION LOCK AND 2 KEYS		BACK-UP LIGHT SWITCH ON TRANS.	
ALPINE SERIES I	ES50	32.75	ES20	29.95	ES20	29.95	ES23	39.00	ES25	20.10	ES56	32.50	ES57	15.75		
ALPINE SERIES II	ES50	32.75	ES50	32.75	ES20	29.95	ES23	39.00	ES25	20.10	ES56	32.50	ES57	15.75		
ALPINE SERIES III	ES50	32.75			ES50	32.75	ES53	47.50	ES55	21.95	ES56	32.50	ES57	15.75		
ALPINE SERIES IV	ES50	32.75			ES50	32.75	ES53	47.50	ES55	21.95	ES56	32.50	ES57	15.75	T1800253	27.75
ALPINE SERIES V	ES50	32.75	ES20	29.95	ES50	32.75	ES53	47.50	ES55	21.95	ES56	32.50	ES57	15.75	T1800253	27.75
TIGER, ALL	ES50	32.75			ES50	32.75	ES53	47.50	ES55	21.95	ES56	32.50	ES57	15.75		

CHROME BEZEL FOR TOGGLE SWITCHES	ES62	8.95
RUBBER COVER FOR ES53	ES61	6.95
SIGNAL SWITCH REPAIR KIT ALPINE III-V, TIGER	ES58	19.95

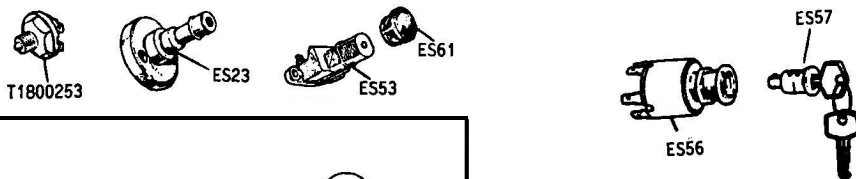

LIGHT BULBS

LOCATION	ALPINE I		ALPINE II		ALPINE III		ALPINE IV, V & TIGER	
FRONT LAMP, FLASHER	LB50	2.25	LB50	2.25	LB50	2.25	LB52	1.90
FRONT LAMP, PARKING							LB51	1.60
STOP & TAIL, 2 FILAMENT	LB50	2.25	LB50	2.25	LB50	2.25	LB50	2.25
REAR FLASHER	LB52	1.90	LB52	1.90	LB52	1.90	LB52	1.90
LICENSE PLATE LAMP	LB53	1.80	LB53	1.80	LB53	1.80	LB53	1.80
MAP LIGHT			LB54	2.95	LB54	2.95	LB54	2.95
ROOF LAMP			LB54	2.95	LB54	2.95	LB54	2.95
DASH WARNING LIGHT	LB56	1.85	LB56	1.85	LB56	1.85	LB56	1.85
INSTRUMENT	LB57	1.95	LB57	1.95	LB57	1.95	LB57	1.95

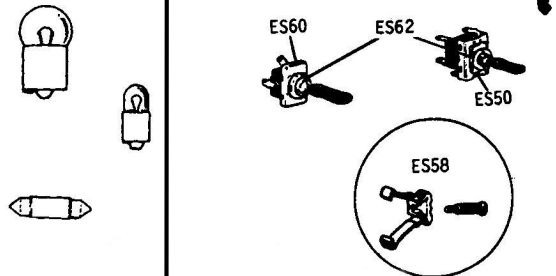

TIGER ELECTRICAL PARTS

FIELD ISOLATING RELAY FOR STOCK TIGER MK.II	ME50	61.40
IGNITION RESISTOR, MK.I & II (CERAMIC REPLACEMENT)	ME53T	23.40
VOLTAGE REGULATOR FOR MK.I (GENERATOR CARS)	AD15T	92.95
VOLTAGE REGULATOR FOR MK.II (ORIGINAL ALTERNATOR)	AD25T	89.20
CONCOURS CORRECT OEM DISTRIBUTOR CAP	AI51T	18.20
YELLOW TOP COIL FOR TIGER, STOCK	AI58T	58.00
VINTAGE STYLE TIGER IGNITION WIRE SET	AI61T	52.60
STARTER SOLENOID, MOTORCRAFT, TIGER ALL	AS25T	54.95
PERTRONIX III DISTRIBUTOR (MUST USE COIL AI58T3)	AI20PT	285.00
PERTRONIX III DIST. AS ABOVE W/O VACUUM ADVANCE	AI20TN	298.00
PERTRONIX III COIL FOR PERTRONIX DIST. ABOVE	AI58T3	49.95

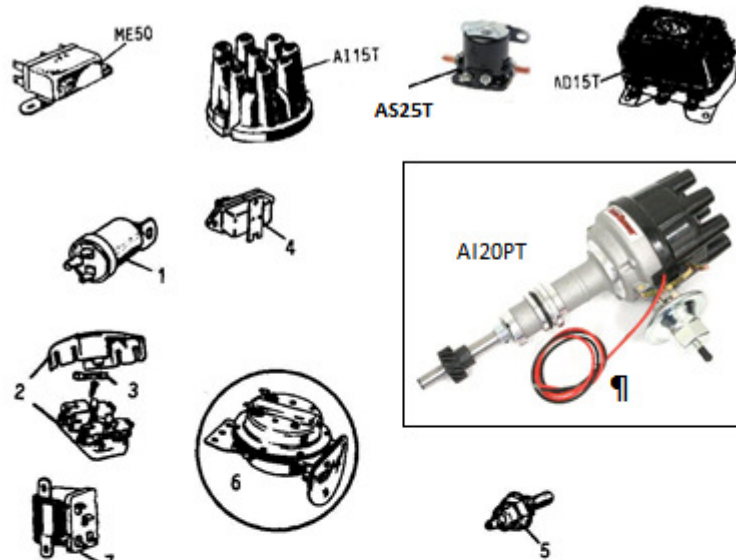

MISCELLANEOUS ELECTRICAL, ALPINE & TIGER

1	TURN SIGNAL FLASHER, ALL	ME54	13.50
2	LUCAS FUSE BOX WITH COVER, ALL	ME55	38.50
3	GLASS FUSE 15 AMP CONTINUOUS, 30 MAX(2 PER CAR), ALPINE & TIGER, SOLD EACH	ME57	1.00
4	INSTRUMENT CONSTANT VOLTAGE REGULATOR, FOR NEGATIVE GROUND CARS ONLY FOR POSITIVE GROUND CARS ONLY	ME58 ME58P	38.25 38.25
5	TEMP SENDING UNIT, ALPINE I-II	ME29	16.50
5	TEMP SENDING UNIT, ALPINE S. III-V, TIGER	ME59	16.50
	TEMP SENDING UNIT, TIGER II-NOT AVAIL USE ME59		N.L.A.
6	HORN, LOW NOTE, NOT OEM	ME63	24.30
6	HORN, HIGH NOTE, NOT OEM	ME64	24.30
7	HORN RELAY, ALPINE S. I-II	ME50	61.40



WIRING HARNESSES, ALPINE & TIGER

DESCRIPTION	PART #	PRICE
HARNESS, ALPINE S. I, LEFT HAND DRIVE	ME13A	415.00
HARNESS, ALPINE S. II, LEFT HAND DRIVE	ME23A	415.00
HARNESS, ALPINE S. III, LEFT HAND DRIVE	ME33A	415.00
HARNESS, ALPINE S. IV, LEFT HAND DRIVE	ME43A	415.00
HARNESS, ALPINE V, LEFT HAND DRIVE	ME63A	415.00
HARNESS, TIGER MK I & IA, LEFT HAND DRIVE	ME13T	415.00
HARNESS, TIGER MK II, LEFT HAND DRIVE	ME23T	415.00
LARGE TIGER WIRING PICTURES INCLUDING THE DASH	ME68	16.00

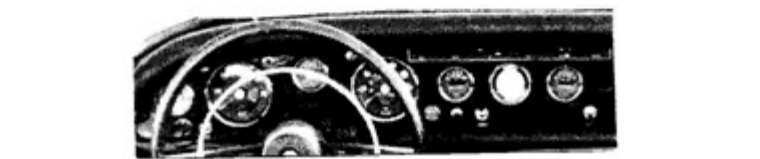

INSTRUMENTS & PARTS

DESCRIPTION	PT. #	PRICE
FLEXIBLE OIL GAUGE LINE, ALL (STOCK TYPE)	DI53	28.60
ENGINE FITTING FOR TIGER OIL GAUGE LINE	TM55	19.95
ALPINE SPEEDO CABLE, S.IV ALL & ALPINE V WITH OD	DI54	37.80
S. V, NON OVERDRIVE	DI55	37.80
TIGER SPEEDO CABLE, SEE PAGE 11		
AMMETER, 50-0-50, LUCAS OR JAEGER (SPECIFY)	DI57	166.00
AMMETER, 35-0-35, LUCAS OR JAEGER (SPECIFY)	DI58	166.00
AMMETER, 30-0-30, LUCAS OR JAEGER (SPECIFY)	DI59	166.00
VOLTMETER, RED NEEDLE UNLESS WHITE IS REQUESTED	DI60	166.00
STOCK TACH INDUCTION WIRE FITTINGS, PLASTIC & METAL	DI61	26.50

INSTRUMENT REBUILDING

CONTACT A LOCAL INSTRUMENT COMPANY OR ONE LISTED BELOW.
 MO-MA INSTRUMENTS (N.M.) (505) 766-6661
 NISONGER CORPORATION (N.Y.) (914) 381-1952

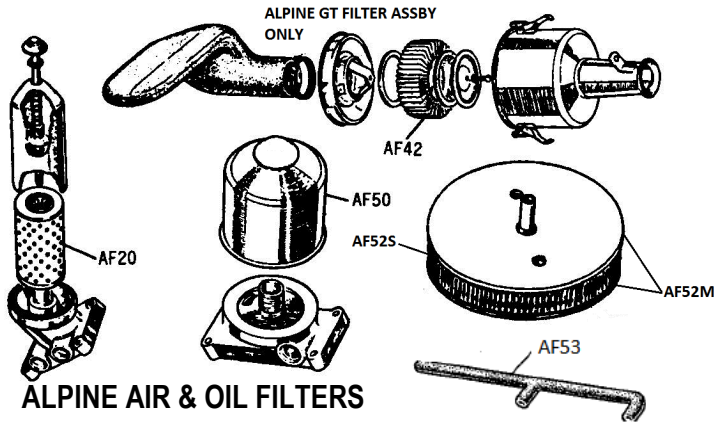

ALPINE AIR & OIL FILTERS

APPLICATION	OIL FILTER	AIR FILTER
ALPINE S. I, II	AF20 18.80	
ALPINE S.III TO B9204781	AF20 18.80	
ALPINE S.III FR.B9204782	AF50 11.85	
ALPINE S. IV	AF50 11.85	
ALPINE S. V	AF5011.85	
ALPINE S. V METAL AIR FILTER HOUSING ONLY		AF52M 8.65ea
ALPINE S. V S & B COTTON WASHABLE FILTER EL.		AF52S 18.95ea
ALPINE S.V AIR CLEANER HOSE TO FLAMETRAP		AF53 19.95

*GT MODELS ONLY WITH METAL AIR CLEANER HOUSING

ALPINE IGNITION SPECIFICATIONS

POINT GAP, ALL 0.015"
CAM DWELL ANGLE 60° ± 3
SPARK PLUG GAP 0.025"

ALPINE SPARK PLUGS

ALPINE I-IV AUTOLITE SPARKPLUG AI66 4.60ea
ALPINE V 1725 AUTOLITE PLUG AI67 4.50ea



WIPERS & WASHERS

GASKET UNDER CHROME WIPER POST BEZEL (PAIR)	MP10B	3.25pr
WINDSHIELD WASHER NOZZLE BODY GROMMETS	MP10E	7.25pr
REPLACEMENT WIPER BLADE, COMPLETE. APPEARANCE IS VINTAGE BUT NOT ABSOLUTELY ORIGINAL	WW51	19.95 ea
WIPER ARM, LEFT HAND DRIVE	WW53	23.95ea
RUBBER GROMMET FOR SCREEN WASHER HOSE	RG61	1.25ea
WINDSHIELD WASHER BAG & PLUG, ALPINE V ONLY	WW55	33.55ea
CHROME BEZEL ONLY FOR WIPER POST	WW58	19.50ea
CHROME NUT MOUNTED ABOVE THE BEZEL	WW58N	3.75ea
ROOTES WASHER BOTTLE, ALPINE III-IV, TIGER I & IA, NOT II	WW59	37.75ea
TUDOR WASHER BOTTLE, LATE TIGER IA, EARLY MK II	WW63	48.50ea
WINDSHIELD WASHER SQUIRTER NOZZLE, CHROME	WW60	9.50ea
CHROME PLATE UNDER WW60 SQUIRTER	WW61	5.20ea
ROUND BRASS NUT TO ANCHOR WW60 NOZZEL	WW62	5.35ea

PERTRONIX IGNITOR SOLID STATE ELECTRONIC IGNITION

THIS IS A COMPACT SYSTEM COMPLETELY CONTAINED WITHIN THE DISTRIBUTOR WITH ONLY 2 WIRES TO CONNECT. CAN BE INSTALLED IN THE TIME IT TAKES TO CHANGE POINTS.. IT SWITCHES TWICE THE ENERGY OF POINT SYSTEMS.

ALPINE I-IV WITH POSITIVE GROUND	AI65AP	118.00
ALPINE V WITH NEGATIVE GROUND (OR ALPINE I-IV CONVERTED TO NEG. GROUND)	AI65AN	112.00
TIGER, ALL WITH STOCK SINGLE POINT DIST.	AI65T	112.00
TIGER, ALL WITH OPTIONAL DUAL POINT DIST.	AI65TD	117.600
COIL, ALPINE PERTRONIX (BLACK)	AI58PA	49.50
COIL, TIGER PERTRONIX (BLACK)	AI58PT	49.50
COIL BRACKET, PERTRONIX	AI58PB	6.25

FUEL SYSTEM, ALPINE & TIGER

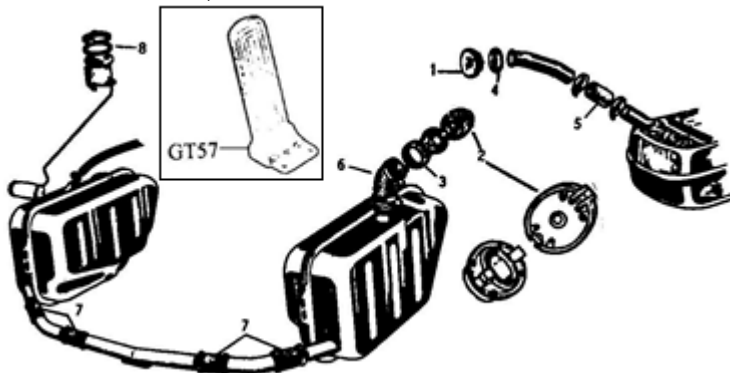

REF.#	DESCRIPTION	PART #	PRICE
1	GAS CAP (NOT ORIGINAL, ROUND) ALPINE S.I & II	GT24	N.L.A.
1	STOCK GAS CAP ALPINE S.III	GT34	46.25
2	GAS CAP CHROME LID WITH BUTTON AND PINS FOR INSTALLATION. S.IV-V, TIGER	GT56	87.65
3	GAS CAP TO FENDER GASKET, ALPINE IV-V TIGER	GT55	4.25
4	FILLER NECK GROMMET, ALPINE I & II	GT25	8.60
5	FILLER NECK HOSE, ALPINE S.I-II	GT50L	8.95
6	FILLER NECK HOSE, ALPINE IV, V & TIGER	GT51	21.85
7	GAS TANK BALANCE PIPE HOSES, 4 PER CAR, ALPINE III-V & TIGER. SOLD EACH	GT50	8.75
8	TANK SENDING UNIT GASKET, ALPINE S.I-II	GT23	4.55
8	SENDING UNIT GASKET, ALPINE III-V & TIGER	GT53	5.95
	GASKET, FUEL CAP SEALING, ALPINE IV-V, TIGER SEALS THE FLIP UP LID TO THE GAS CAP BASE.	GT56G	6.95
9	GAS PEDAL, ALPINE III-V, TIGER RHD ONLY	GT57	29.95
	LARGE OVAL GROMMET, ALPINE I-II FLOOR	GT27	19.80

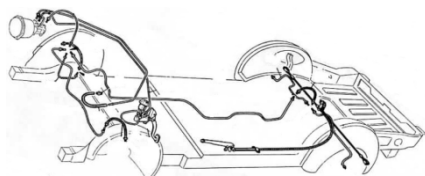

PART #	AUTOMEC BRAKE LINE SETS (NOT PRE-BENT)	PRICE	
HS4A	ALPINE I-IV BRAKE LINE SET, W OR W/O SERVO, WITH REAR AXLE T FITTING. (TO ALPINE IV B94101457)	156.85	
HS5A	ALPINE IV-V BRAKE PIPE SET, SERVO & REAR AXLE CROSSOVER PIPE, RH TO LH	159.60	
HS2T	TIGER BRAKE LINE SET, ALL TIGERS, 5" OR 7" SERVO	169.85	
PART #	LENGTH	INDIVIDUAL PIPE, END TYPE	PRICE
HL18MF	18" M/F	FR. JUNCTION TO RH FRONT HOSE, ALPINE REAR HOSE TO RH W/C, ALPINE IV-V & TIGER	17.80
HL18MM	18" M/M	ALP I-IV, REAR Y FITTING TO RH BACK W/C	17.80
HL26MF	26" M/F	TIGER FR. JUNCTION TO RH FRONT HOSE	19.85
HL40MM	40" M/M	ALP I-IV, EARLY LH REAR FR Y FITTING	21.75
HL42MF	42" M/F	TIGER FR. JUNCTION TO LH FRONT HOSE	23.15
HL54MF	54" M/F	FR. JUNCTION TO LH FRONT HOSE, ALPINE	23.60
HL56MM	56" M/M	RH REAR W/C OVER AXLE TO R WC, TIGER & ALP	24.10
HL72MM	72" M/M	BRAKE PIPE, PARTIAL FRONT TO REAR	25.80

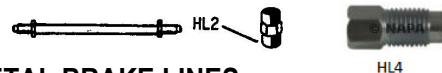

METAL BRAKE LINES

3/16" O.D. LINES WITH BUBBLE FLARES FOR ENGLISH SYSTEMS. MALE FITTINGS BOTH ENDS.

PART #	LENGTH	PRICE
HL8	8"	7.25
HL12	12"	7.40
HL20	20"	7.95
HL30	30"	8.20
HL40	40"	8.45
HL51	51"	9.45
HL60	60"	10.95



BRAKE LINE SETS

HL2	UNION	6.50ea.
HL4	ADAPTER FITTING, 3/16" to 1/4"	8.50ea.
HL33CA	CLUTCH PIPE, 1/4", ALPINE LATE III, ALL ALPINE IV & V	27.30ea

ALPINE I	ASSEMBLY		REPAIR KIT		
	DESCRIPTION	PART #	PRICE	PART #	PRICE
FRONT CALIPER,			HK50*		35.60
CALIPER PISTON, STAINLESS	HP51S	34.80ea			
BRAKE MASTER CYLINDER, 0.70"	HP22	138.00	HK22		15.75
REAR WHEEL CYLINDER	HP24	38.50	HK24*		15.60
CLUTCH MASTER CYLINDER	HP35	144.00	HK35		9.95
CLUTCH SLAVE CYLINDER	HP26	CALL US	HK56		13.20
FRONT BRAKE HOSE TO B9005984	HP57	29.60ea			
REAR BRAKE HOSE	HP57	29.60ea			

*ONE KIT SERVICES BOTH SIDES, LEFT AND RIGHT. ORIGINAL GIRLING CYL. ONLY. REBUILD KITS WILL NOT REBUILD THE CURRENT WHEEL CYLINDERS SOLD NOW.

ALPINE II	ASSEMBLY		REPAIR KIT		
	DESCRIPTION	PART #	PRICE	PART #	PRICE
FRONT CALIPER,			HK50*		35.60
CALIPER PISTON, STAINLESS	HP51S	34.80ea			
BRAKE MASTER CYLINDER, 0.70"	HP22	138.00	HK22		15.75
REAR WHEEL CYLINDER	HP24	38.50	HK24		15.60
CLUTCH MASTER CYLINDER	HP35	144.00	HK35		9.95
CLUTCH SLAVE CYLINDER	HP26	CALL US	HK56		13.20
FRONT BRAKE HOSE	HP57	29.60ea			
REAR BRAKE HOSE	HP57	29.60ea			

*ONE KIT SERVICES BOTH SIDES, LEFT AND RIGHT. ORIGINAL GIRLING CYL. ONLY. REBUILD KITS WILL NOT REBUILD THE CURRENT WHEEL CYLINDERS SOLD NOW.

ALPINE III-IV	ASSEMBLY		REPAIR KIT		
	DESCRIPTION	PART #	PRICE	PART #	PRICE
FRONT CALIPER,			HK50*		35.60
CALIPER PISTON, STAINLESS	HP51S	34.80ea			
BRAKE MASTER CYLINDER 3/4" (A)		NLA	HK32		15.43
BRAKE MASTER CYLINDER 7/8" (SOLD WITH RESERVOIR) (B)	HP42	172.80	HK52		19.60
RESERVOIR ONLY (NOT GIRLING)	HP62	35.80			
SERVO UNIT (5" BOOSTER)			HK43		87.50
REAR WHEEL CYLINDER	HP44	37.50ea	HK44		12.60
CLUTCH MASTER CYLINDER (A)	HP35	144.00	HK35		9.95
CLUTCH MASTER CYLINDER (B)	HP55	CALL US	HK55		10.50
CLUTCH SLAVE CYLINDER (A)	HP26	CALL US	HK56		13.20
CLUTCH SLAVE CYLINDER (B)	HP56	68.30	HK56		13.20
FRONT BRAKE HOSE	HP57	29.60ea			
REAR BRAKE HOSE I	HP57	29.60ea			
REAR BRAKE HOSE (D)	HP58	29.60ea			

*ONE KIT SERVICES BOTH SIDES, LEFT AND RIGHT ORIGINAL GIRLING CYL. ONLY. REBUILD KITS WILL NOT REBUILD THE CURRENT WHEEL CYLINDERS SOLD NOW.

NOTES (A) TO B9204717
(B) FROM B9204718 & ALL SERIES IV
I.S.III & IV TO B94101523
(D) S.IV AFTER B94101524

NOTES: ALL STOCK ALPINE BRAKE HYDRAULICS ARE GIRLING.
ALL STOCK ALPINE CLUTCH HYDRAULICS ARE LOCKHEED
ALL STOCK TIGER BRAKE AND CLUTCH HYDRAULICS ARE GIRLING.

ALPINE V	ASSEMBLY		REPAIR KIT		
	DESCRIPTION	PART #	PRICE	PART #	PRICE
FRONT CALIPER,			HK50*		35.60
CALIPER PISTON, STAINLESS	HP51S	34.80ea			
BRAKE MASTER CYLINDER, 0.875"	HP52	138.00	HK52		19.60
REMOTE RESERVOIR ONLY	HP62	35.80			
SERVO UNIT (5" BOOSTER)(A)			HK43		87.50
SERVO UNIT (7" BOOSTER)(B)			HK53		94.80
REAR WHEEL CYLINDER I	HP54	38.50ea	HK54*		12.75
REAR WHEEL CYLINDER (D)	HP44	37.50ea	HK44*		12.60
CLUTCH MASTER CYLINDER	HP55	CALL US	HK55		10.50
CLUTCH SLAVE CYLINDER	HP56	68.30	HK56		13.20
FRONT BRAKE HOSE	HP57	29.60ea			
REAR BRAKE HOSE	HP58	29.60ea			

*ONE KIT SERVICES BOTH LEFT AND RIGHT SIDES. ORIGINAL GIRLING CYL. ONLY. REBUILD KITS WILL NOT REBUILD THE CURRENT WHEEL CYLINDERS SOLD NOW.

NOTE: THE HK43 & HK53 SERVO KITS REBUILD THE STOCK GIRLING MK IIA SERVO UNITS. FOR OTHER SERVO KITS, SEE THE SPECIAL KIT SECTION FOR OTHER SERVO UNITS THAT MAY HAVE BEEN SUBSTITUTED.

(A) TO B395004058 (PLEASE READ NOTE ABOVE)
(B) FROM B395004059 (PLEASE READ NOTE ABOVE)
I TO B395017552 PLUS 15 EXCEPTIONS: B395017888, 894, 896/7/8/9, 967, 904, 932, 959, 912, 929, 938, 924, 966 (SELF ADJUSTING BRAKES)
(D) FROM B395017553 OTHER THAN THE ABOVE EXCEPTIONS (MANUALLY ADJ. BRAKES)

TIGER I, I-A, II	ASSEMBLY		REPAIR KIT		
	DESCRIPTION	PART #	PRICE	PART #	PRICE
FRONT CALIPER,			HK50*		35.60
CALIPER PISTON, STAINLESS	HP51S	34.80ea			
BRAKE MASTER CYLINDER (SOLD WITH RESERVOIR), 0.875" BORE	HP42	172.80	HK52		19.60
BRAKE M/CYL W/O RESERVOIR	HP52	138.00	HK52		19.60
RESERVOIR ONLY (NOT GIRLING)	HP62	35.80			
SERVO UNIT (5" BOOSTER)(A)			HK43		87.50
SERVO UNIT (7" BOOSTER)(B)			HK53		94.80
REAR WHEEL CYLINDER	HP44	37.50ea	HK44*		12.60
CLUTCH MASTER CYLINDER	HP25T	122.00	HK25T		12.75
CLUTCH SLAVE CYLINDER	HP26T	97.50	HK26T		9.75
FRONT BRAKE HOSE	HP57	29.60ea			
REAR BRAKE HOSE	HP58	29.60ea			

*ONE KIT SERVICES BOTH LEFT AND RIGHT SIDES. ORIGINAL GIRLING CYL. ONLY. REBUILD KITS WILL NOT REBUILD THE CURRENT WHEEL CYLINDERS SOLD NOW.

NOTE: THE HK43 & HK53 SERVO KITS REBUILD THE STOCK GIRLING MK IIA SERVO UNITS. FOR OTHER SERVO KITS, SEE THESECTION BELOW ON OTHER SERVO'S..

(A) ALL MK I & MK IA TO B382001285 (PLEASE READ NOTE ABOVE)
(B) FROM B382001286 & ALL MK II (PLEASE READ NOTE ABOVE)

IMPORTANT: USE ONLY GIRLING COMPATIBLE (DOT 4) FLUID SUCH AS CASTROL DOT 4 BRAKE FLUID. NOT ALL DOT 4 FLUID IS COMPATIBLE WITH GIRLING HYDRAULIC SYSTEMS.

OTHER BRAKE PARTS

CALIPER TRANSFER PORT SEAL, 2 PER CAR, ALL	HK50S	2.75ea
EMERGENCY BRAKE CABLE, ALPINE I-II	BP29	112.75
EMERGENCY BRAKE CABLE, ALPINE III AND ALPINE IV TO B94101458, LONG CABLE ONLY	BP39	95.30
EMERGENCY BRAKE CABLE, ALPINE S. IV FROM B94101458, S. V, AND TIGER	BP59	98.80
RUBBER GROMMET FOR BP59	RG58	5.60
SERVO FILTER KIT, (FILTER, COVER & GASKET)	BP67	18.65
SPRING, BRAKE & CL. PEDAL MASTER CYL. S.IV FROM B94103954, S.V, TIGER., SOLD EACH	BP64	5.25
ORIGINAL ALUMINUM CAP FOR TIGER CLUTCH MASTER CYL.	HP25TC	19.95

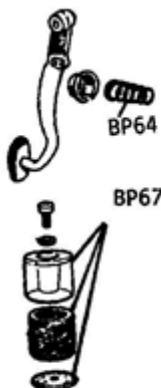

OTHER SERVO KITS

REBUILDING KIT FOR NON-ORIGINAL SERVO UNITS

	GIRLING MK IIB	LOCKHEED REPLACEMENT
5" SERVO (SMALL)	HK43B NOT AVAIL.	HK43L 96.00
7" SERVO (LARGE)	HK53B NOT AVAIL.	

REPLACEMENT SERVO (MFG. BY LOCKHEED) SERVO. REPLACES THE 5" & 7" SERVO FOR ALPINE S.IV AND S.V AS WELL AS THE 5" & 7" SERVO ON ALL TIGERS. THE APPEARANCE IS DIFFERENT THAN THE GIRLING UNITS AND REQUIRES THAT A MOUNTING BRACKET BE MADE.

HP43L 334.00



BRAKE PARTS PADS & SHOES, BRAKE ROTOR

DESCRIPTION	ALPINE SERIES I. II		ALL TIGER & ALPINE S. III-IV		ALPINE SERIES V (A)		ALPINE SERIES V (B)	
	PART #	PRICE	PART #	PRICE	PART #	PRICE	PART #	PRICE
BRAKE ROTOR, FRONT (NEW ITEM)			BP58	89.50ea	BP58	89.50ea	BP58	89.50
BRAKE PADS, (REGULAR)	BP20	79.75set	BP50	31.80set	BP50	31.80set	BP50	31.80set
BRAKE SHOES, SET OF 4	BP41	39.95set	BP41	39.95set	BP51	42.80set	BP41	39.95set
BRAKE RETURN SPRINGS, SET OF 4	BP42	38.50set	BP42	38.50set	BP52	N.L.A.	BP42	38.50set
LOCK PLATES, SET	BP23	27.95set	BP43	USE BP53	BP53	28.25set	BP43	USE BP53
SPRING PIN KIT	BP44	24.80set	BP44	24.80set	BP54	22.00set	BP44	24.80set
BRAKE ADJUSTER UNIT	BP45	29.60ea	BP45	29.60ea	BP55RH	N.L.A.	BP45	29.60ea
DUST COVER FOR LEVER	BP27	5.50ea	BP47	8.95ea.	BP57	14.40ea	BP47	8.95ea
CALIPER PAD PIN & CLIP SET	BP66	18.80set	BP66	18.80set	BP66	18.80set	BP66	18.80set
E-BRAKE LEVER COIL SPRINGS, S. V					BP68	17.25pr.		

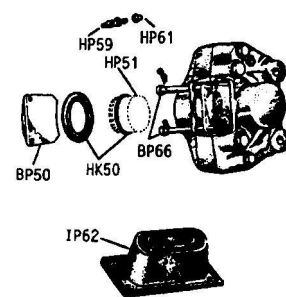

(A) ALPINE SERIES V TO B395017552 PLUS 15 EXCEPTIONS. B395017888,894,896/7/8/9,967,904,932,959,912,929,938,924,966. (SELF ADJUSTING BRAKES)
 (B) VERY LATE SERIES V ALPINES FROM B395017553 OTHER THAN THE ABOVE EXCEPTIONS. (MANUALLY ADJUSTING BRAKES)

ALL THE ABOVE PARTS ARE SOLD IN 2 WHEEL SETS EXCEPT FOR THE BRAKE ADJUSTER UNITS AND DUST COVERS.

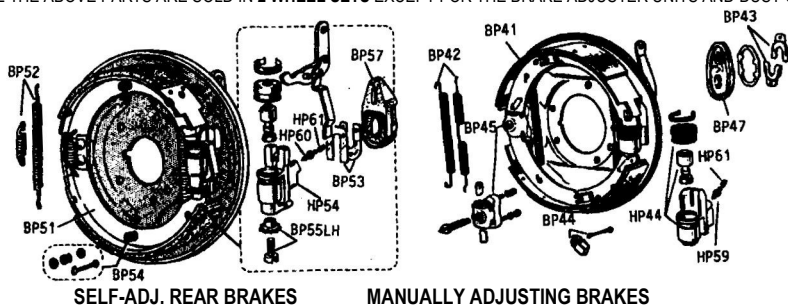

DESCRIPTION	PART #	PRICE
DOT 4 BRAKE FLUID, 12 oz, CASTROL	HF50	7.25
BLEEDER SCREW	HP59	4.25
BLEEDER SCREW CAP FOR HP59	HP61	0.35
EMERGENCY BRAKE BOOT, ALPINE I-II	IP62	19.95

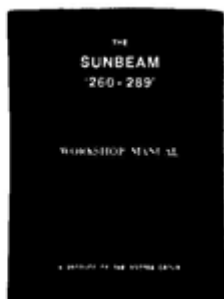

INFORMATIONAL BOOKS

ALPINE S. II SPECIAL TUNING HANDBOOK. COVERS ENGINE, SUSPENSION & BRAKE MODIFICATIONS. 32 PAGES.	SB26A	14.90
"HOW TO REBUILD YOUR SMALL BLOCK FORD" BY TOM MONROE. GOOD SOLID INFO. COVERS 260, 289,302, ETC. 8-1/2 X 11 », 158 PAGES, 567 ILLUSTRATIONS.	SB26T	N.L.A.
"SUNBEAM ALPINE, LIMITED EDITION" '59-67, BY R.M. CLARK. COVERS ALL CARS & HARRINGTONS. 136+ PAGES, INCLUDED ARE ROAD & COMPARISON TEST, NEW MODEL INTRODUCTIONS, FULL SPECIFICATIONS & DATA.	SB54A	N.L.A.
"SUNBEAM TIGER LIMITED EDITION", BY R.M. CLARK. COVERS ALL CARS. 128 PAGES, ROAD TESTS, MODEL INTRODUCTIONS, BUYING GUIDE, ADVICE & INVESTMENTS.	SB54T	N.L.A.
PERFORMANCE TUNING SUNBEAM TIGER BY GORDON CHITTENDEN. REPRINT OF THE '67 CLYMER HANDBOOK. 131 PGS	SB59	34.50

CARDS & POSTERS

SET OF 7 ORIGINAL ROOTES POSTERS, TIGER & ALPINE, 1 FULL COLOR, OTHERS B & W WITH SOME ORANGE TYPE, ALL ARE ROOTES ADS EACH 11 X 17"	SB63	37.50s et
SET OF 8 ROOTES POSTCARDS IN FULL COLOR, RACING PHOTOS & SOME ADS, SOME SIGNED	SB67C	16.80s et
SET OF 8 ROOTES BLACK & WHITE POSTCARDS, RACING PHOTOS & SOME AD PHOTOS, SOME SIGNED	SB67	16.00s et
GENUINE ROOTES CHRISTMAS CARD, 10 CARDS WITH ENVELOPES. AN ATTRACTIVE MODEL REVEALS THE CHARMS OF HER NEW SUNBEAM CONVERTIBLE MODEL.(IN COLOUR)	SB64	15.00s et

HANDBOOKS

OWNER'S HANDBOOKS, REPRINTS (ABOUT 60 PAGES EACH)

ALPINE SERIES I, USE SB25A	SB15A	N.L.A.
ALPINE SERIES II	SB25A	15.75
ALPINE SERIES III	SB35A	15.75
ALPINE SERIES IV	SB45A	15.75
ALPINE SERIES V	SB55A	15.75
TIGER MK I & IA	SB15T	21.95
TIGER MK II	SB25T	23.95

MANUALS

ALPINE S. I-IV FACTORY SHOP MANUAL. ALSO COVERS RAPIER S.III-IV. COVERS MECHANICAL, ELECTRICAL, & TRIM. 446 PAGES.	SB40A	54.00
SUNBEAM TIGER FACTORY SHOP MANUAL. MAINTENANCE, REPAIR, OVERHAUL, TRIM. COMPLETE SPECS. 320 PGS, 305 ILLUSTRATIONS.	SB20T	56.50



SB67



SB67C

WINDSHIELDS, GLASS, & PARTS

WINDSHIELD, ALPINE SERIES I, II, CLEAR	WS20 *	Not Stk
WINDSHIELD SEAL FOR ALPINE S. I-II ONLY (CALL US)	WS21	N.L.A.
WINDSHIELD, ALPINE SERIES III-V, TIGER, CLEAR	WS50 *	Not Stk
RUBBER AROUND WINDSHIELD, ALPINE S. III-V, TIGER. SEAL HAS MOLDED CORNERS AND NO UNJOINED ENDS	WS51	96.80
WINDSHIELD FRAME TO BODY SEAL, CURVED. ALPINE III-V & TIGER (WS52 CAN BE USED ON ALPINE S I & II NOT IDENTICAL.)	WS52	46.95
WINDSHIELD FRAME TO DOOR WING WINDOW SEAL. REPRO WITH METAL STIFFENERS FOR RIGIDITY. ALPINE III-V, TIGER	WS53	43.90pr
FURFLEX PIPING AND DOOR OPENING TRIM MOUNTED ON THE BODY. ORIGINAL APPEARANCE & FIT.		
ALPINE I-II (SET FOR 1 CAR)	WS25	76.70
ALPINE III-V, TIGER (SET FOR 1 CAR)	WS55	92.90
CAULKING CORD USED BETWEEN WS52 ABOVE & THE BODY	WS56	8.25
WINDSHIELD SEALER, NON-HARDENING, 1/10 GALLON TUBE	WS57	8.70
RUBBER MIRROR BUFFER, ALPINE V, TIGER MK IA, II	IP63	3.50
WINDSHIELD POST UP OR DOWN ADJ. NUTS, S.III-V, TIGER, PAIR	WS58	21.75

*DUE TO UNAVAILABILITY, WE WILL MFG. THE WS50 AGAIN

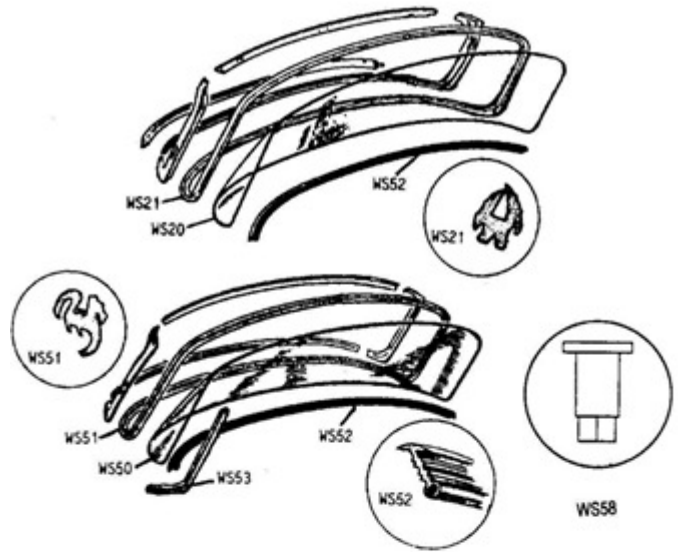

DOOR PARTS

CHANNEL REPLACEMENT KIT 2 DOORS, ALPINE S. I-II, SPECIFY	DC22	38.95set	
DOOR TO DOOR WINDOW RUBBER OUTER SEAL, FITS SOME ALPINE S. II'S (CHECK DRAWING)	DC23	14.80ea	
DOOR WAIST INNER ANTIRATTLE FUZZY STRIP, ALPINE S. I & II, OUTER FOR S.I AND SOME SERIES II'S (CHECK DRAWING)	DC26	17.40ea	
REAR CHANNEL LINER, ALPINE III-V, TIGER	DC50	9.90pr	
GLASS RUN CHANNEL UPPER, ALPINE III-V, TIGER	DC51	9.75ea	
FRONT LOWER CHANNEL, ALPINE III-V, TIGER	DC51	10.95ea	
CHANNEL KIT, ALL THE ABOVE FOR 2 DOORS, ALPINE SERIES III-V, TIGER (DC50, DC51, BUT NO ADHESIVE)	DC52	47.90set	
DOOR TO DOOR WINDOW OUTER SEAL WITH STEEL STIFFENER SAME APPEARANCE AS THE ORIGINAL. ALPINE S. III-V, TIGER	DC53	37.80pr	
DOOR WINDOW ANTIRATTLE FUZZY STRIP, UPPER EDGE BLACK, ALPINE III-V, EARLY TIGERS	DC54	17.50ea	
CLIP FOR ABOVE 3 ANTIRATTLE STRIPS	DC55	0.565ea	
DOOR WINDOW ANTIRATTLE FUZZY STRIP, STAINLESS STEEL BEAD FOR CARS WITH GT INTERIORS, ALPINE III-V & TIGER	DC26	17.40ea	
CLIP FOR ABOVE 2 WEATHERSTRIPS, AS ORIGINAL	DC57	1.75ea	
UPPER DOOR FINISHER, CHROME FINISH ALPINE II ONLY	DP22	89.60pr	
GLAZING RUBBER TO INSTALL DOOR WINDOW IN METAL RETAINING CHANNEL	DP51	5.40ea	
GLAZING RUBBER TO INSTALL FIXED WINDOW, ALPINE III-V, TIGER	DP51B	6.75pr	
DOOR EDGE WEATHERSTRIP, SEALS THE REAR OF THE DOOR AND UNDER THE DOOR TO THE BODY	DP54	19.85ea	
CHROME DOVETAIL, ALL CARS, REPRO	LEFT RIGHT	DP55LH DP55RH	105.00 105.00
DOOR WAIST ROLLS FOR GT INTERIORS. VINYL COVERED PAD ON SOME DOORS JUST ABOVE THE DOOR PANEL. (MOUNT ON YOUR OLD METAL SUPPORT. PICTURED IN UPHOLSTERY)		DP56	92.50pr
METAL FOR DOOR WAIST ROLL PADS ABOVE IF NEEDED		DP56M	68.90pr
DOOR PANEL CLIP (28 PER CAR)		DP57	1.00ea
PLASTIC SLEEVE FOR DOOR PANEL CLIP (10-12 PER CAR)		DP57S	0.80ea
INTERIOR DOOR HANDLE.		DP59	24.75ea
CHROME BEZEL FOR DP59 & DP60, 9/16" ID		DP59B	5.25ea
BLACK PLASTIC ESCUTCHEONS FOR ABOVE, SET OF 4		DP59E	22.50set
WINDOW CRANK		DP60	34.90
PINS FOR ABOVE 2 ITEMS		DP61	1.00ea
OVAL RUBBER LOWER DOOR PLUG (4 PER CAR)		DP62	4.55ea
DOOR WINDOW REGULATOR GEAR REPAIR KIT. REPAIRS LEFT OR RIGHT GEARS & INCLUDES DP67 REGULATOR SHAFT HOUSING ALPINE III-V & TIGER		DP64	N.L.A.
DOOR HINGE SCREW, ALL MODELS		DP65	1.85ea
DOOR CLOSING PADS, L & R. THESE FOAM PADS, SCREW ON UNDER THE CHROME B-POST CAPS		DP66	17.75pr
HOUSING FOR THE WINDOW REGULATOR SHAFT. IF YOUR WINDOW WINDER HANDLE IS LOOSE & SLOPPY, THIS PART MAY FIX THE PROBLEM. ALPINE III-V AND TIGER		DP67	11.80ea
DOOR STRIKER PLATE SCREWS & LOCKWASHERS, STAINLESS		DP68	4.80set
SCREW SET FOR BOTH DOVETAILS, SET OF 6, STAINLESS		DP69	5.60set
DOOR LIMITING STRAPS, ALPINE & TIGER, FITS LH & RH DOORS		DP70	34.00ea
SEAL, WINDSHIELD PILLAR DRAIN CHANNEL (W. METAL CORE)		ET75	7.90ea
SEAL, REAR DOOR POST, VERTICAL (S. III-V, TIGER)		ET76	12.90ea
ALUMINUM THRESHOLD PLATE, ALPINE S. III-V, TIGER, CAN BE USED ON ALPINE I-II		IP74	96.50pr
ALUMINUM TRIANGLE FINISHER PLATES, ALPINE & TIGER		IP75	34.95pr

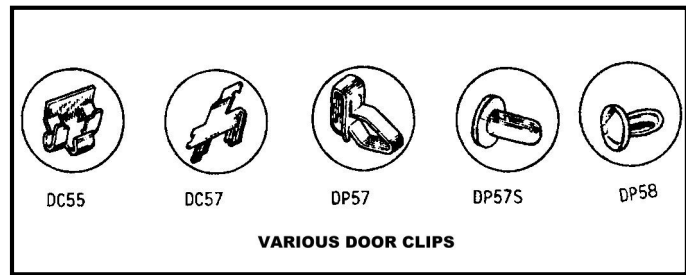
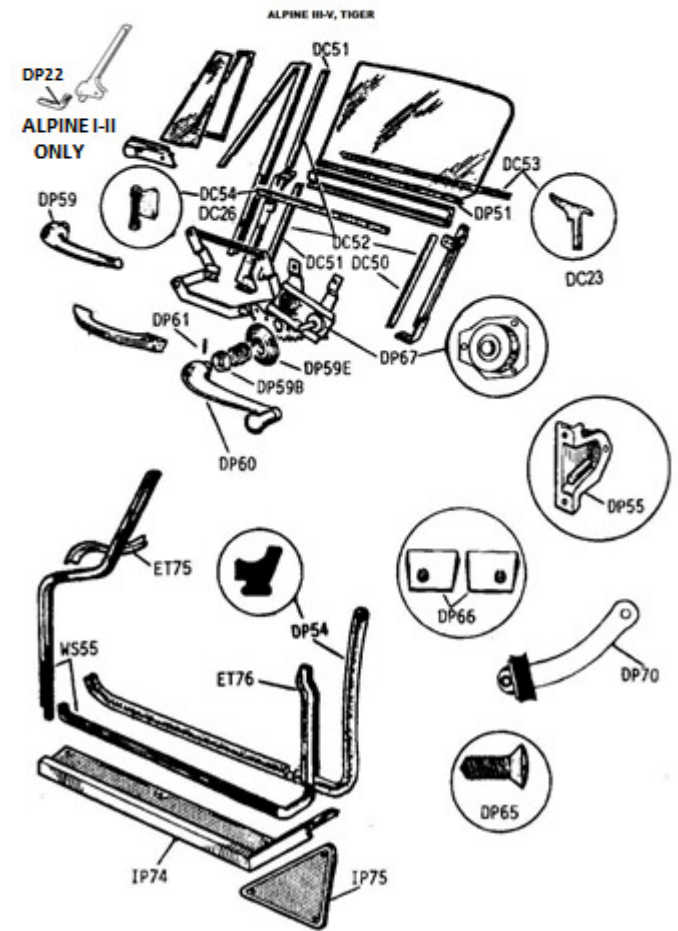

SOFT TOPS & TONNEAUS BY ROBBINS TOP CO.

ROBBINS TOPS ARE MADE FROM THE FINEST QUALITY PRESHRUNK WATERPROOF SPORT TOPPINGS AND ARE THE MOST ORIGINAL TOP AVAILABLE. CHOICE OF 2 MATERIALS, PINPOINT VINYL OR CRUSH-GRAIN LEATHERETTE FINISH VINYL. ALL SEAMS ARE STITCHED WITH DACRON THREAD AND DIELECTRICALLY HEATSEALED FOR SUPERIOR STRENGTH. REAR WINDOWS ARE BONDED BY HEATSEALING AS WERE ORIGINALS.

THE ORIGINAL CRUSH-GRAIN TYPE EVERFLEX BRITISH VINYL IS ALSO AVAILABLE IN A VARIETY OF COLORS IN THE LEATHERETTE FINISH USED ON THE SERIES I-IV ALPINES & EARLY TIGERS. THE ADDITIONAL CHARGE IS \$195. INSIDE COLOUR IS LIGHT GREY.

SOFT TOPS	PINPOINT VINYL PT.#	CRUSHGRAIN VINYL PT.#	PRICE OF EITHER
ALPINE S. I, 3 WINDOWS, ZIPPER	AT10	AT11	\$428.00
ALPINE S. II, 1 WINDOW, NO ZIPPERS	AT20	AT21	428.00
ALPINE S. III, IV, TENSION CABLES	USE AT50 OR AT51 WITH AT66 VELCRO STRIPS		
TIGER MK I, TENSION CABLES	USE AT50 OR AT51 WITH AT66 VELCRO STRIPS		
ALPINE S. V, VELCRO	AT50	AT51	380.00
TIGER MK IA, II, VELCRO	AT50	AT51	380.00
AT50/51 TOP IN BRITISH EVERFLEX	AT50E		625.00
STAYFAST CLOTH TOP			
TIGER & ALPINE IV & V		AT50C	645.00

TONNEAU COVERS	PINPOINT VINYL PT.#	CRUSHGRAIN VINYL PT.#	PRICE OF EITHER
ALPINE SERIES I, II	AT24	AT25	N.L.A.
ALPINE S.III-V,TIGER	AT54	AT55	326.00

BLACK ON BLACK TOPS & TONNEAUS (BLACK OUTSIDE/BLACK INSIDE) ARE STOCKED. WHITE ON BLACK ARE AVAILABLE ON SPECIAL ORDER AT NO EXTRA COST.

SADDLE ON BLACK, BUCKSKIN ON BLACK, DARK TAN ON BLACK, BROWN ON BLACK, BLUE, RED & BRITISH EVERFLEX MATERIAL HAVE AN ADDITIONAL CHARGE TOPS & TONNEAUS NOT IN STOCK TAKE ABOUT 4 WEEKS TO ARRIVE.

SOFT TOP PARTS	PART #	PRICE
SOFT TOP TO WINDSHIELD WEATHERSTRIP, ALL	AT57	27.75
CONVERTIBLE TOP TENSION RODS S.III-V & ALL TIGERS. LEFT RIGHT	AT58LH AT58RH	16.85 16.85
CHROME PIVOT PINS & CLIPS FOR TENSION RODS, PAIR	AT58P	9.25pr
SPIGOT & LOCKNUT FOR ABOVE RODS, CHROMED, 1 EACH	AT59	9.20
SPRINGS FOR TENSION ROD, BOTH SIDES	AT60	12.60pr
CANTRAIL SEAL SET, BOTH SIDES. ALPINE III-V AND TIGER	AT62	23.25
SOFT TOP TO REAR OF BODY SEAL, ALL	AT63	18.25
SIDE COVER FINISHER SEAL, ALPINE III-IV, TIGER	AT64	7.25ea
SIDE COVER FINISHER SEAL, ALPINE I-II	AT65	7.25ea
VELCRO COVERED METAL STRIPS. ALLOWS CONVERSION TO A VELCRO TOP (AT50 OR AT51)	AT66	31.95pr
CHROME SCREWS FOR METAL CONVERTIBLE TOP BOOT COVER INCLUDES 2 BALL SOCKETS AND 2 CHROME PIVOT SCREWS WITH SHOULDERS. SET OF FOUR	AT67	19.85set
SOFT TOP FOLDING INSTRUCTION DECAL. INSTALLS ON CENTER BOOT COVER. ALPINE I	AT68A	17.80
SOFT TOP INSTRUCTION DECAL, AS ABOVE ALPINE II	AT68B	17.80
INSTRUCTION DECAL AS ABOVE FOR ALPINE III-V, TIGER MK I	AT68C	18.95
TIGER IA, TIGER II & ALPINE V USED NO DECAL	NONE	
STRAPS WITH HOOKS FOR VINYL TOP BOOT, PR. ALPINE V STRAPS SUPPORT THE BOOT WHEN TOP IS UP. TIGER IA, II	AT70	46.90pr
CHROME SOCKET IN HEADER BOW FOR SPIGOT ABOVE, EACH	AT72	13.40ea
ALIGNMENT PINS FOR ALUMINUM BRACKETS, PAIR	AT77	13.60pr
NYLON ALIGNMENT GUIDES FOR TENSION ROD, PAIR	AT78	N.L.A.
COVERS FOR FRAME VERTICAL RAILS, ALPINE III-V, TIGER	AT80	49.95pr
VERTICAL ANCHOR STRIPS FOR TOP ALPINE III-V, TIGER	AT81	19.75pr
EDGE STRIP RUBBER TRIM , REAR EDGE OF THE 3 METAL COVERS, ALPINE I-IV, TIGER MK 1 ONLY	AT83	14.70set
EDGE STRIP ON THE REAR OF THE FRONT BOX, U SHAPED	AT84	13.50ea

SOFT TOP FASTENERS

TOP TO BODY ANCHOR CLIP 6/CAR, III-V, TIG. HT64 1.15ea	TONNEAU STUD, STD. AT74 2.10EA.	SPECIAL BALL STUD ALPINE I-II ONLY, 2 / CAR AT76 3.45.
TONNEAU STUD, 10-32 AT73 2.60EA.	LIFT THE DOTS BOTH PLATES AT75 1.80EA.	ANCHOR BUTTON WITH STUD UK60 0.80HTEA.

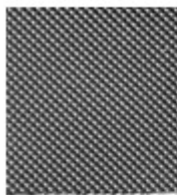

PINPOINT PATTERN



CRUSHGRAIN PATTERN

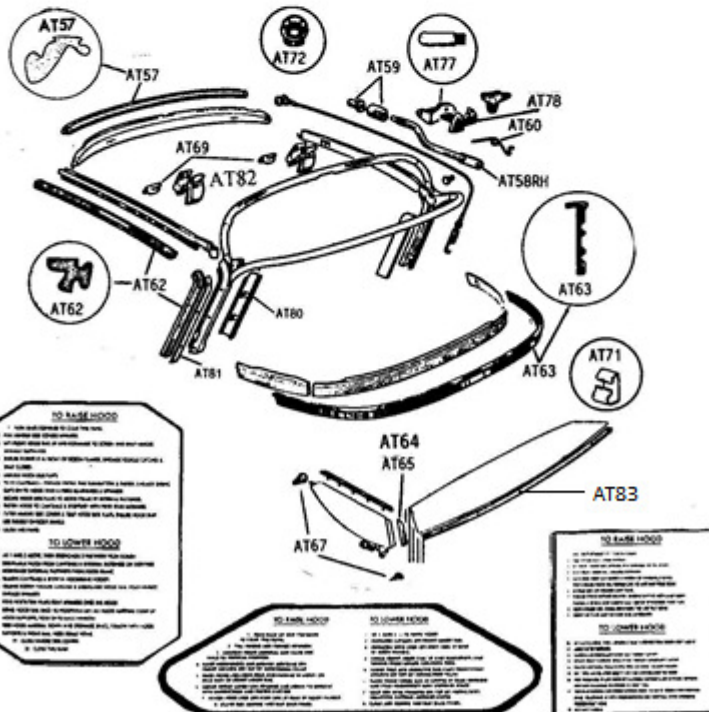

OPTIONAL SUN VISORS

OPTIONAL SUN VISORS. MANUFACTURED TO BE DUPLICATES OF THE ORIGINALS EXCEPT THAT THE RODS ARE STAINLESS STEEL. ORIGINAL VINYL. ALPINE S.V, TIGER IA-II (CARS WITH 7" MIRRORS) CAN BE USED ON TIGER I & ALPINE III-IV., WHITE	IP84	ON B/O
COMPLETE BRACKET SET FOR ABOVE. CAST POLISHED STAINLESS STEEL FOR STRENGTH.	IP83	ON B/O



SPECIAL SEAT SCREWS

LARGE SEAT BACK PIVOT SCREWS. COUNTERSUNK SLOTTED SCREW WITH PIVOT NIPPLE AFTER THE THREADS	UK82	19.95pr
RATCHET PLATE & SEAT-REST SCREWS, 5/16X1/2" BSF, ND.6	UK83	2.25ea
ROUND NUT, 5/16" BSF (FOR SEAT BACK REST), 1 PER SEAT	UK83N	4.25ea
LONG SCREW, 2 1/2" BSF	UK84	2.95ea

UPHOLSTERY & DOOR PANELS

SEAT KITS ARE MANUFACTURED FROM HIGH QUALITY REINFORCED VINYL TO ORIGINAL PATTERNS. THE PEBBLE MATERIAL IS THE ORIGINAL VINYL USED BY ROOTES IN THE TIGER MK II, MOST TIGER MK IA'S, AND SOME ALPINE V'S. THE LONGHORN MATERIAL WAS ORIGINAL IN MOST ALPINE I-IV'S. THE LONGHORN MATERIAL WAS DISCONTINUED BY THE MFG. AND WE ARE USING THE SMOOTH MATERIAL NOW WHICH IS VERY CLOSE. THE SMOOTH MATERIAL WAS THE GRAIN USED IN MOST ALPINE V'S BUT IS NOT FACTORY ORIGINAL MATERIAL.

NOTE: ORDER ONE UPHOLSTERY KIT TO RECOVER BOTH SEATS.

ALPINE SERIES I & II, SMOOTH	UK20S	475.00pr
ALPINE SERIES III & IV AND EARLY TIGER. TYPE 2: BACKREST HAS PLEATED SECTION FLAP THAT ATTACHES AT THE BOTTOM. SEE ILLUSTRATION.		
SMOOTH	UK41S*	475.00pr
PEBBLE	UK41P*	545.00pr

***CAUTION:** CHECK YOUR SEATS CAREFULLY BY FEEL TO MAKE SURE YOU ARE ORDERING THE CORRECT KIT.

ALPINE S. V	SMOOTH	UK50S	475.00pr
TIGER I-A, SOME ALPINE V'S	PEBBLE	UK50P	545.00pr
TIGER MK II ONLY	PEBBLE	UK76P	575.00pr

MOULDED HIGH RESILIENT FOAM SEAT CUSHIONS			
BOTTOM CUSHION.	ALPINE S.III-V, TIGER	UK63	66.00ea
BACKREST CUSHION, ALPINE III-IV, TIGER I TYPE 2 UPHOLSTERY. THIS IS A 2 PIECE BACKREST CUSHION.		UK64E	65.00ea
BACKREST CUSHION, ALPINE S. V, TIGER IA, II.		UK64	64.00ea
CLIP, UPHOLSTERY TO SEAT FRAME		IP85	0.85ea

DIAPHRAGMS & SEAT STRAPS ARE LISTED ON THE NEXT PAGE

DOOR PANELS, READY TO INSTALL. CLIPS NOT INCLUDED

NOTE: DOOR PANELS FOR GT AND NON-GT INTERIORS CANNOT BE INTERCHANGED. THE VINYL MATCHES THE UPHOLSTERY KITS.

DOES YOUR CAR HAVE GT DOOR PANELS? ALL TRUE GT CARS (SOME ALPINE III-V'S AND ABOUT 15 EARLY TIGERS WERE TRUE GT CARS) AND ALL TIGER 1A'S & II'S CAME WITH GT INTERIORS FROM THE FACTORY. TRUE GT CARS HAD NO PROVISION FOR A CONVERTIBLE TOP BUT HAD A LARGER REAR SEAT AREA AND A MORE FINISHED INTERIOR. TIGER IA & II'S HAD THE IMPROVED GT DOOR PANELS EVEN THOUGH THEY HAD CONVERTIBLE TOPS. THE GT DOOR PANELS HAVE 3 PLEATS AND ARE MORE COMPLICATED BECAUSE THEY HAVE METAL EDGING UNDER THE MATERIAL.

ALPINE S.I-II, ALL	SMOOTH	UK22S	175.00pr
ALPINE S. III-V, TIGER, NON-GT	SMOOTH	UK52S	175.00pr
ALPINE S. III-V, TIGER, NON-GT	SMOOTH	UK52S	175.00pr
ALPINE S. III-V, TIGER, NON GT	PEBBLE	UK52P	205.00pr
ALPINE S. III-V, TIGER, GT TYPE	SMOOTH	UK52GTS	435.00pr
ALPINE S. V, TIGER, GT TYPE	PEBBLE	UK52GTP	495.00pr

PACKAGE TRAY COVER, VINYL MADE WITH THE FACTORY ORIGINAL VINYL TO COVER THE HORIZONTAL STORAGE AREA BEHIND THE FRONT SEATS. BLACK WITH BLACK PIPING. HEAT PRESSED PLEATS AS ORIGINAL. NOT USED ON ALL CARS

TIGER I ONLY & ALPINE I-IV ONLY	LONGHORN	UK68L	NLA
	PEBBLE	UK68P	NLA

CENTER CONSOLE ARMREST UPHOLSTERY KIT.

ALPINE I-II, SIDE OPENING	SMOOTH	UK27A	55.90
ALPINE I-II, FRONT OPENING	SMOOTH	UK57S	55.90
ALPINE III-V, TIGER	SMOOTH	UK57S	55.90
	PEBBLE	UK57P	75.00

DOOR PANEL CLIPS FOR THE ABOVE DOOR PANELS (ABOUT 28 PER CAR)	DP57	1.00ea
PLASTIC SLEEVES FOR LOWER DOOR PANEL CLIPS (ABOUT 10-12/CAR)	DP57S	0.80ea

ADDITIONAL VINYL MATERIAL FOR INTERIOR USE. ABOUT 52-54" WIDE.	SMOOTH	LONGHORN	PEBBLE
	UK51S	UK51L	UK51P
	17.95yd	N.L.A.	49.90yd

BACKREST 11 PLEATS



UK20

BOTTOM 11 PLEATS

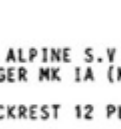

ALPINE S.V & TIGER MK IA (MOST)

BACKREST 12 PLEATS



UK50

BOTTOM 10 PLEATS



BACKREST 7 PLEATS

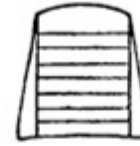

UK41

BOTTOM 6 PLEATS

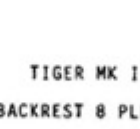

TIGER MK II

BACKREST 8 PLEATS

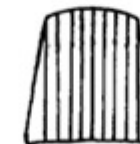

UK76

BOTTOM 8 PLEATS



UK41

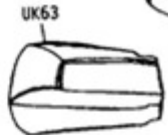

SPECIAL GT TYPE DOOR PANELS



DP57



DP57S

(FACTORY ORIGINAL MATERIAL)



SMOOTH PATTERN

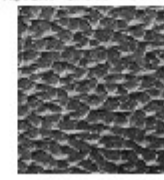

PEBBLE PATTERN

MISCELLANEOUS INTERIOR PANEL KIT. INCLUDES KICK PANELS AND THE TRIMMED PANELS BEHIND THE SEATS & THE TRUNK CURTAIN. ALPINE S.I-IV AND TIGER MK I.

ALPINE I-II (SPECIFY ALPINE I OR II)	SMOOTH	UK21S	285.00
ALPINE III-IV, TIGER I	SMOOTH	UK71S	285.00
ALPINE III-IV, TIGER I	PEBBLE	UK71P	345.00

BLACK PLASTIC RIVETS FOR UK71. (16 PER CAR NEEDED)	IP59		0.65ea
--	------	--	--------

MISCELLANEOUS INTERIOR PANEL KIT INCLUDES KICK PANELS AND THE TRIMMED PANELS BEHIND THE SEATS, & TRUNK CURTAIN. SOFT TOP BOOT AND REAR PADDED ROLL ARE NOT INCLUDED. ALPINE V, TIGER IA & II.

ALPINE V,	SMOOTH	UK72S	285.00
ALPINE V, TIGER I-A, TIGER II	PEBBLE	UK72P	325.00

VINYL BOOT FOR SOFT TOP. INCLUDES FASTENERS. ALPINE V, TIGER IA-II.

ALPINE V	SMOOTH	UK65S	275.00
TIGER IA-II, SOME ALPINE V's	PEBBLE	UK65P	320.00

PADDED ROLL (MOUNTED BELOW THE SOFTTOP VINYL BOOT) COMPLETE.

ALPINE V, TIGER IA-II	SMOOTH	UK74S	185.00
AND TIGER MK IA & TIGER II	PEBBLE	UK74P	195.00

THE ORIGINAL PEBBLE IS ONLY AVAILABLE IN BLACK ALTHOUGH PIPING CAN BE OTHER COLORS. SPECIFY SEAT COLOR AND PIPING COLOR WHEN SPECIAL-ORDERING. BLACK WITH BLACK PIPING IS IN STOCK. ALL OTHER COLORS MUST BE PREPAID. OTHER COLORS ARE: RED, WHITE, TAN, BLUE, ETC.

REQUEST COLOR SAMPLES BEFORE ORDERING TO CONFIRM THAT THE COLOR IS ACCEPTABLE.

DASH PAD, VACUUM FORMED AND FOAM-FILLED LIKE THE FACTORY PAD. SAME MATERIAL AS ALPINE V & LATE TIGER. YOUR CAR'S FINISHING TOUCH. ALL CARS.	IP79		198.00
FOAM PAD FOR LOWER DASH ROLL. DOES NOT INCLUDE THE METAL SUPPORT OR VINYL COVER. ALL CARS	IP81		22.50
DOOR WAIST ROLL PADS FOR THE TOP OF THE DOOR ON CARS ONLY WITH THE GT INTERIORS. THE METAL FRAME IS NOT INCLUDED. MATCHES IP79 DASH PAD MATERIAL.	DP56		92.50pr

CARPETS: COMPLETE REPLACEMENT KITS, FRONT & REAR WITH JUTE BACKING.

ALPINE SERIES I & II	TUFTED PILE	UK26A	395.00set
ALPINE SERIES III-IV	TUFTED PILE	UK56A	395.00set
ALPINE SERIES V	TUFTED PILE	UK78A	395.00set
TIGER MK I ONLY	TUFTED PILE	UK56T	395.00set
TIGER MK IA & TIGER II	TUFTED PILE	UK78T	395.00set
EMBROIDERED ALPINE & TIGER CARPETED FLOORMATS			SEE PAGE 27

NOTE: ONLY BLACK CARPETS, ARE STOCKED. ALL OTHERS MUST BE PREPAID. OTHER COLORS ARE AVAILABLE

COLORS OTHER THAN BLACK HAVE A SURCHARGE DEPENDING ON THE MATERIAL

SEAT CUSHION DIAPHRAGM. FOR ALPINE S. V & TIGER MK IA AND TIGER MK II SEATS. THE DIAPHRAGM IS MOUNTED TO THE SEAT FRAME UNDER THE CUSHION AND GIVES FIRM YET FLEXIBLE SUPPORT TO THE CUSHION.

DIAPHRAGM, ALPINE V, TIGER IA-II	UK61		46.50ea
----------------------------------	------	--	---------

SEAT STRAP KIT TO REDO SUPPORTING STRAPS FOR THE LOWER SEAT CUSHIONS. FOR 2 SEATS. ALPINE S.III-IV, TIGER I, STRAPS ARE DUPLICATES OF THE ORIGINALS.	UK79		44.50set
SEWN MATERIAL ANCHOR SET FOR ABOVE (FOR 2 SEATS)	UK81		88.00set

CARPET CLIPS: ABOUT 20 EACH PER CAR.

LONG PRONG RING & SPRING RING,PAIR	UK58C		1.75
ANCHOR BUTTON (EACH)	UK60		0.80

NOTES: LONGHORN IS STOCK MATERIAL FOR ALPINE I-IV's & MOST TIGER I's BUT IS NO LONGER AVAILABLE. SMOOTH IS THE CORRECT PATTERN FOR ALPINE V's BUT IS NOT OEM. IT IS SIMILAR TO THE LONGHORN.

PEBBLE IS THE STOCK FACTORY ORIGINAL MATERIAL FOR SOME ALPINE IV & V's AND SOME TIGER I's & FOR ALL TIGER IA AND TIGER II's.



MISCELLANEOUS PANEL KIT (UK21)

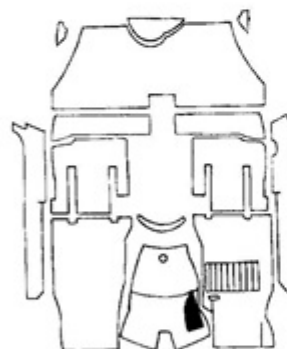
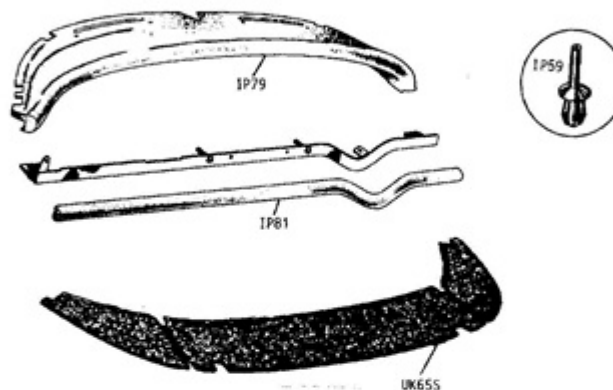

CARPET KIT, UK56T LAYOUT



DASH PAD, UPHOLSTERY ETC. FROM SUNBEAM SPECIALTIES



UK79, UK81

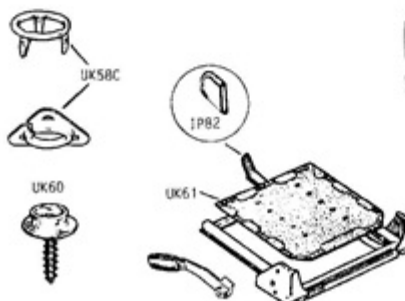

EXTERIOR TRIM

TIGER SIDE MOULDINGS. EXACT DUPLICATES OF THE ORIGINALS. CLIPS ARE NOT INCLUDED WITH THE MOULDINGS. ORDER SEPARATELY.



FRONT FENDER, LONG, LEFT OR RIGHT.	ET87T	29.50ea
FRONT FENDER, SHORT, LEFT OR RIGHT.	ET88T	8.80ea
DOOR MOULDING, LEFT OR RIGHT	ET89T	29.50ea
REAR FENDER MOULDING, LEFT OR RIGHT	ET90T	29.50ea
1 SIDE SET, 1 EACH OF THE ABOVE	ET91T	90.00st
SIDE MOULDING CLIPS, PLASTIC.	ET72T	0.45ea
CHRYSLER PENTASTAR FOR RH FENDER, LATE ALPINE V & LATE TIGER IA-II CARS	ET86	15.95
TRUNK OR FRONT END CHROME LETTERS" "S U N B E A M" LETTER SET	ET107	ON B/O
SPIRE FIX CLIP FOR TRUNK LETTERS	ET94	0.20ea
WASHERS & GASKETS FOR ABOVE, 7 OF EA.	ET94G	14.95st
CLIP FOR FRONT LETTERS	ET78	0.35ea
HOOD BADGE, SUNBEAM ROOTES GROUP, DOMED, CHROME PLATED BRASS WITH TALBOT CENTER. EXACT REPRO.	ET62	39.80ea
SUNBEAM SCRIPT FOR TIGER MK II HOOD	ET64T	29.25ea
TIGER FENDER OR TRUNK SCRIPT, REPRO.	ET65T	28.50ea
ALPINE FENDER SCRIPT, REPRO.	ET65A	28.50ea
CLIP FOR ALPINE/TIGER SCRIPT OR SIDE BADGE OR TRUNK SERIES BADGE	ET78	0.35ea
HARRINGTON ALPINE FENDER BADGE	ET92	51.95ea
HARRINGTON LEMANS ST. WHEEL BADGE	ET93	51.60ea
CHROME SURROUND FOR MOTIF BADGE	ET66	23.95ea
PLASTIC MOTIF BADGES FOR ABOVE, SPECIFY ALPINE III, IV, V, TIGER 260, OR TIGER V8	ET105D	21.80ea
BULLET LH MIRROR. CHROMED FINISH WITH A.3 1/2" x 1 1/2" BASE ONLY. FLAT MIRROR	ET100LH	49.95ea
BULLET RH MIRROR, FLAT GLASS	ET100RH	49.95ea
BULLET RH MIRROR CONVEX GLASS	ET100RC	49.95ea
DOOR MIRROR, LONG STEM MIRROR, L OR RH	ET110	31.50ea
TRUNK HINGES, REPRO. VERY HIGH QUALITY & STRONGER THAN ORIGINAL FITS ALL CARS, EXTERIOR DOOR HANDLES, HIGH QUALITY REPRO W/DOOR LOCK FLAP, NO LOCKS.	ET102	192.00pr
"SUNBEAM" MKII NAMEPLATE (MOUNTED ADJACENT TO THE "TIGER" SCRIPT)	ET106	15.95ea
BARREL CLIP TO RETAIN COWL VENT GRILLS.	ET112	1.15pr
TIGER MK II SILL MOLDING CLIP, ORIGINAL	ET118	4.25ea

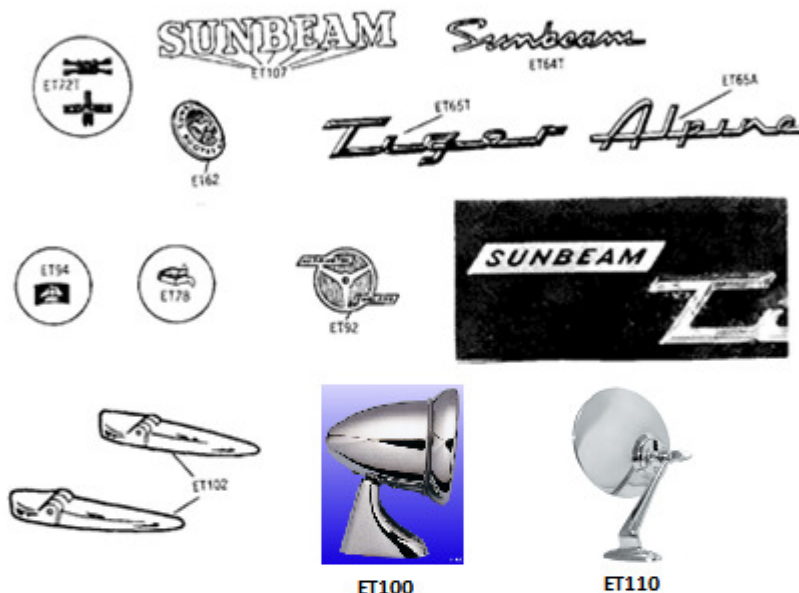

BUMPER PARTS

BUMPER GUARD BUFFER, ALPINE S. IV, V, & TIGER (WITH METAL AS ORIGINAL)	ET50	13.50ea
CLIP FOR BUFFER (USE 2 PER BUFFER)	ET50C	0.90ea
FINISHER STRIP, BUMPER GUARD TO BUFFER, 36" LONG, MAKES 8 PIECES	ET51	7.95set
BUMPER BRACKET, LEFT FRONT	ET54LH	31.95ea
RIGHT FRONT	ET54RH	31.95ea
REAR, LH OR RH	ET53	29.30ea
CHROME BUMPER BOLT & NUT, 4 NEEDED.	ET111	12.95ea

GRILL PARTS FOR ALPINE IV-V, TIGER

LOWER GRILL FINISHER, STAINLESS STEEL AS ORIGINAL.	ET98	34.95
SET OF 4 CLIPS TO INSTALL ET98	ET121	6.70
GRILL CENTER BAR, RIGHT	ET52RH	22.75
GRILL CENTER BAR LEFT	ET52LH	22.75
GRILL CENTER BADGE BRACKET	ET57	29.95
CHROME SURROUND, GRILL CENTER BADGE	ET108	112.00
GRILL CENTER BADGE	ET55	55.90

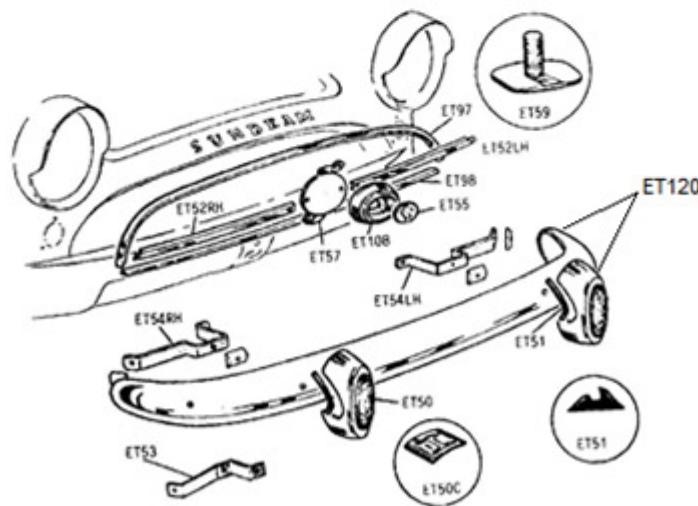

UPPER GRILL FINISHER, ALL ALPINE & TIGER I & IA

UPPER GRILL MOULDING (EYEBROW), REPRO BUT HAS SOME WAVINESS IN CHROME ORDER CLIPS SEPARATELY.	ET97	89.75
RETAINING STUD FOR UPPER FINISHER, 8 REQ.	ET59	1.80

MISC. ATTACHING SCREWS, STAINLESS STEEL

10-32x1/2" PHILLIPS FLAT HEAD COUNTERSUNK	ET113	0.25ea
10-32x1/2" PHILLIPS OVAL HEAD COUNTERSUNK	ET114	0.25ea
10-32x1/2" PHILLIPS PAN HEAD SCREW	ET115	0.25ea
SCREW FOR INT. DOOR PULL (4 PER CAR)	ET117	0.65ea

MISCELLANEOUS BODY SCREWS



CAR COVERS

CAR COVER. TAN POLYCOTTON FLANNEL BY COVERCRAFT 50% HEAVIER THAN COVERCRAFT'S POLYCOTTON DRILL COVER FOR LONGER WEAR AND GREATER SUNLIGHT RESISTANCE. A FINE DURABLE, BREATHABLE MATERIAL TREATED TO GIVE MILDEW RESISTANCE & WATER REPELLENCY. ALPINE & TIGER, (NOT FOR LONG TERM OUTDOOR STORAGE)	UK62TF	315.00
COVERCRAFT WEATHERGUARD COVER FOR INDOOR OR OUTDOOR USE, REPELS WATER	UK62W	336.00
OPTIONAL CABLE AND LOCK FOR THE UK62 CAR COVER ABOVE	UK68	16.80
CAR COVER STORAGE BAG	UK69	19.95

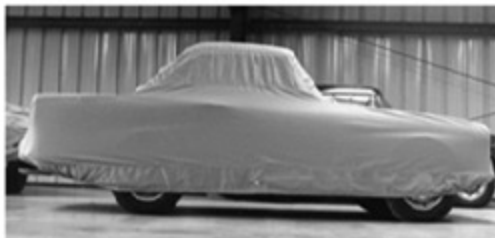

UK62TF



UK73

FRONT MASK

SUNBEAM BRA. GIVE YOUR SUNBEAM PROTECTION FROM BUGS, PEBBLES & SAND.	UK73	175.00
--	------	--------

MISC. INTERIOR TRIM

BRAKE AND CLUTCH PEDAL PADS. ALPINE S.I	IP12	22.00pr
CUBBY BOX FOR DASHBOARD. SPECIFY ALPINE I-II - HAS NO HANDHOLD CUTOUT	IP28A	29.50
FOR PLASTIC DASH, ALPINE III-V	IP78A	29.50
FOR WOOD DASH. ALPINE III-V, TIGER	IP78T	29.50
FOR WOOD DASH W/O HANDHOLD CUTOUT	IP78TN	29.50
PEDAL PAD, BRAKE OR CLUTCH, ALPINE S.II TO EARLY S.V. EARLY TIGER (SEE DRAWING)	IP42	14.80pr
TIGER GAS PEDAL PAD COVER (NOT ORIG)	IP43T	14.50
HORN RING, HIGH QUALITY REPRO. STRONGER THAN ORIGINAL. FITS ALPINE S.III-V, ALL TIGERS	IP50R	119.75
PEDAL PAD, BRAKE OR CLUTCH, LATER ALPINE S.V, LATER TIGER IA, II (SEE DRAWING)	IP52	14.80pr
GEAR SHIFT BOOT, ALPINE 4 SPEED, 3 3/8" O.D.	IP53A	19.25
CUSTOM ALPINE GEARSHIFT KNOBS. BLACK VINYL BROWN VINYL WALNUT	IP56BL IP56BR IP56WA	N.L.A. N.L.A. N.L.A.
TIGER WALNUT SHIFT KNOB	IP56TW	N.L.A.
DEFROSTER HOSE, ORIGINAL APPEARANCE.	IP68	ON B/O
WOODEN DASHBOARDS. HIGH QUALITY PLYWOOD WITH BURLED WALNUT VENEER. FITS TIGERS & ALPINE III-V GT MODELS. SHOW QUALITY.	IP73	N.L.A.
WOODEN DASH AS ABOVE WITH MATCHING CUBBY BOX DOOR.	IP73D	N.L.A.
SEAT SLIDER HANDLE RUBBER COVER	IP82	6.50pr
VENT REPAIR KIT, 2 PLASTIC FLAPS & GASKETS, ROLLERS & SPRINGS, S.V, LATE TIG.	IP86C	45.50
DRAIN HOSE, FROM DASH VENTS ABOVE	IP86H	19.95ea
DAY-NIGHT INTERIOR REPLACEMENT MIRROR SIMILAR TO ALPINE V, TIGER IA-II WITH THE RUBBER CUSHION AGAINST THE GLASS. FITS ANY CAR	IP87	N.L.A.
HOOD RELEASE CABLE (NOT ORIGINAL)	IP89	23.00
MIRROR STEM ONLY, FOR MIRROR ABOVE	IP90S	42.00
SWITCH LABELS, METAL, SET OF 4	IP92	29.95

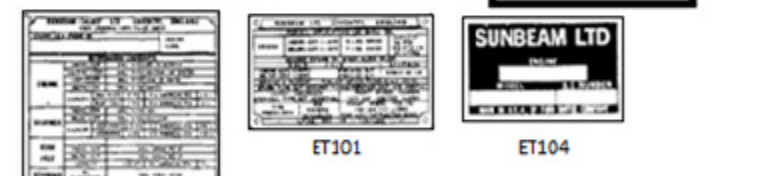
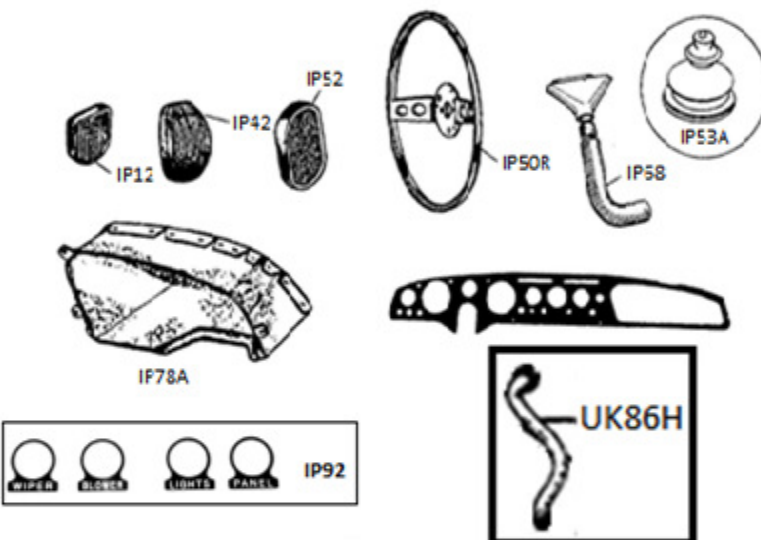

TIGER FRAME EXHAUST PASS-THRU SUPPORTS

METAL SUPPORTS, HOLE FOR 2" EXHAUSTS	ET116	165.00pr
--------------------------------------	-------	----------

ENGINE COMPARTMENT TRIM

DUCKBILL HEATER DRAIN, ALPINE & TIGER SEE COOLING SYSTEM, SOLD EACH	CS65	12.50
TIGER LUBRICATION SPEC PLATE. MOUNTED ON BULKHEAD	ET101	15.95
TIGER ENGINE INFO PLATE	ET104	16.50
ALPINE III-IV SPEC PLATE, STD TRANS	ET101A	14.50
RUBBER SEAL UNDER HOOD, 62" LONG	ET70	9.60
HOOD BUFFER (4 PER CAR), SOLD EACH	ET95	7.50
ALPINE S.I-II SPEC PLATE.	ET99	24.95
CLIPS FOR ABOVE SEAL, 4 PER CAR, SOLD EA.	HT64	1.15
HOOD STAY RUBBER	RG59	4.75
ENGINE COMPARTMENT GROMMETS, PG. 26		



BODY GASKETS

SET OF 4 FOR TRUNK HINGES	MP10A	8.30
WINDSHIELD WIPER BEZEL, PAIR	MP10B	3.25
EXTERIOR DOOR HANDLE, 2 PAIR	MP10C	9.35
HARDTOP HOLD-DOWN PAD FITS ALPINE S. III-V, TIGER, PAIR	MP10D	N.L.A.
WINDSHIELD WASHER BEZEL GROMMETS, PR.	MP10E	9.95

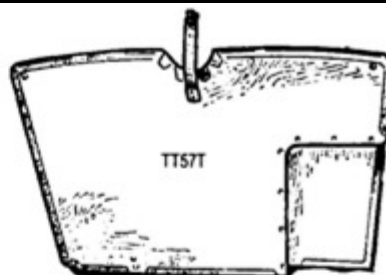
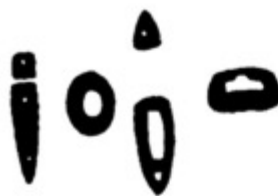

ALPINE & TIGER TRUNK

TRUNK LATCH STRIKER	TT51	19.50
TWO TRUNK GAS TANK COVER PANELS & 2 REAR TRUNK PANELS. DURABLE BLACK PLASTIC. SET OF 4. ALPINE S. III-V	TT52A	64.00
TIGER, ALL	TT52T	64.00
TT52T ALSO AVAIL. IN ORIG. TYPE BOARD	TT52TC	64.00
TRUNK LOCK GROMMET	TT53	5.25
TRUNK WEATHERSTRIP. THIS SEAL IS ALMOST IDENTICAL TO THE ORIGINAL & FASTENS ON WITH A METAL CORE.	TT54	54.50
TRUNK BUFFER (2 PER CAR), SOLD EA	TT55	1.90
TRUNK LOCK TUMBLER & KEYS FOR ALL CARS.	TT56	NLA
ALPINE III-V FLOOR MAT, AS ORIGINAL	TT57A	129.00
DZUS BRACKET FOR ABOVE, MOUNTED ON THE REAR OF THE TRUNK, SOLD EACH, 2/CAR.	TT57D	28.95
FOOTMAN LOOP FOR TRUNK PLATFORM AT FRONT, 3 PER CAR EXCEPT 2 PER MK II TIGER.	TT57F	6.75
TIGER TRUNK PLATFORM, ORIGINAL	TT57T	
MATERIALS USED		465.00
TIGER BATTERY TRAY, PLASTIC.	TT58T	29.00
BATTERY ANTI-CORROSION MAT, ALP. OR TIG.	TT59	6.50
TIGER BATTERY BRACKET & 2 "J" HOOKS	TT59T	29.75
RUBBER STRAP FOR SPARE TIRE, NO BUCKLES, LATE ALPINE V & TIGER II ONLY.	TT60	28.50
TRUNK LIFT CHROME HANDLE	TT61	47.50
LICENSE PLATE MOUNTING BRACKET, BLACK,, ATTACHES UNDER THE TRUNK LIFT HANDLE	TT62	19.50



TT62

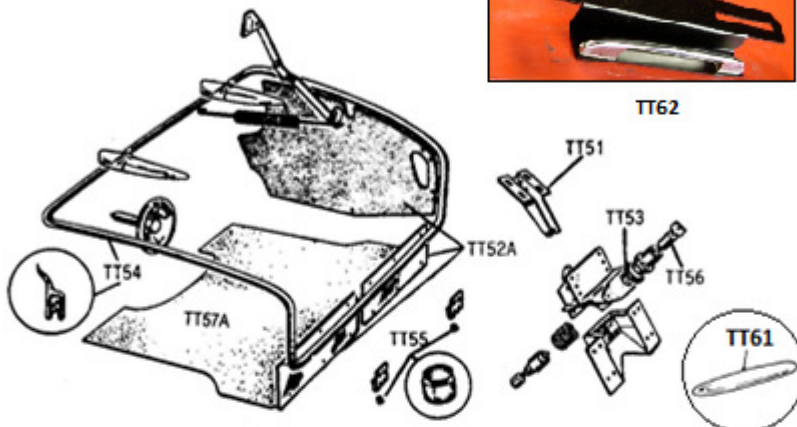

HARDTOP, ALPINE I-II

HARDTOP TO WINDSHIELD SEAL	AT57	27.75
HARDTOP DOOR WINDOW SEAL FOR 2 SIDES	HT20	N.L.A.
PIPING MOUNTED BESIDE HT20, 2 SIDES	HT21	19.95
CHROME HARDTOP ATTACHING BOLT, SOLD EACH	HT22	12.95
PLEXIGLAS WRAP-AROUND REAR WINDOW BUY FROM "AIRCRAFT WINDSHIELD CO." (562) 430-8108, LOS ALAMITOS, CALIF.	HT25	
PIPING, 46" LONG, HARDTOP HEADER	HT26	12.95
ALPINE S.I-II HARDTOP REAR WINDOW SEAL WITH LOCKING STRIP, NO GROOVE FOR CHR.	HT28	57.70
TOOL TO INSTALL LOCKING STRIP ABOVE	HT28T	11.95
HARDTOP HEADLINER, S. I-II	WHITE BLACK	HT29W HT29B
		108.80 108.80
HARDTOP TO BODY SEAL (REAR)	HT63	20.60
CLIPS FOR HEADLINER, SOLD EACH.	HT64	1.15

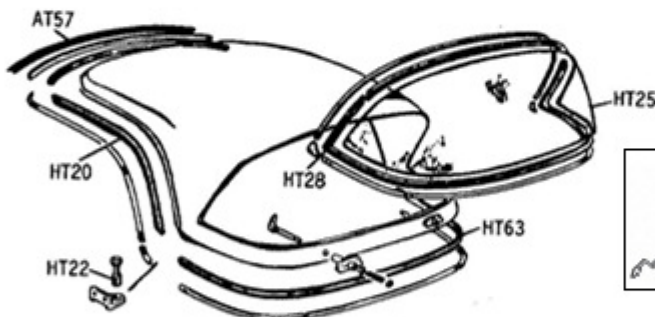

HT28T

HARDTOP, ALPINE III-V, TIGER

HARDTOP TO WINDSHIELD WEATHERSTRIP	HT50	18.85
PIPING BOTH SIDES, LIKE ORIGINAL, PAIR	HT51	17.95
HARDTOP QUARTER WINDOW SEALS, PAIR	HT52	59.80
PLEXIGLAS QUARTER WINDOWS, PAIR	HT53	89.50
DOOR WINDOW VERTICAL SEAL, PAIR	HT54	9.40
POLISHED ALUMINUM RETAINER, HT54 (PR)	HT54C	59.75
PLEXIGLAS REAR WINDOW MOULDED.	HT55	230.00
REAR CORNER PADS. NEOPRENE RUBBER, PR	HT56	29.80
TOGGLE CLAMP GASKETS, SCREW-ON, PAIR	HT57	17.75
RUBBER FOR REAR WINDOW. HAS MOLDED CORNERS FOR A CLOSE FIT EVERYWHERE. SYNTHETIC RUBBER	HT58	82.60
HARDTOP HEADLINER, REPRO.	WHITE BLACK	HT59W HT59B
		108.80 108.80
DOOR WINDOW HORIZONTAL SEAL WITH METAL STIFFENER. PAIR	HT60	35.50
SEAL, HARDTOP TO BODY, FOR 1 CAR, "U" SHAPED.	HT61	21.50
HARDTOP MOULDING CLIP FOR REAR WINDOW MOULDINGS. SOLD EACH	HT62	8.95

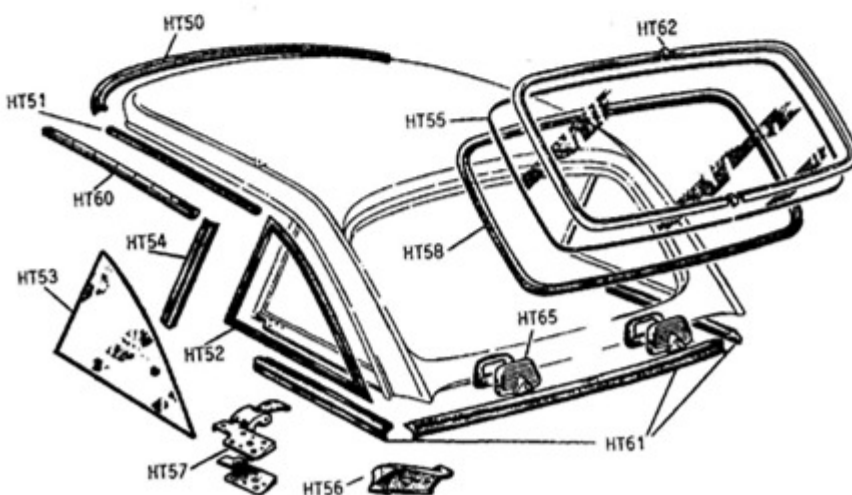

EXHAUST COMPONENTS

STAINLESS STEEL TUBULAR HEADER ASSEMBLY DESIGNED TO FIT ALPINE S. III-V.	EC57S	410.00
AS ABOVE BUT FITS STOCK ALPINE II	EC57E	410.00
STAINLESS STEEL EXHAUST DOUBLE DOWN-PIPES FOR S.IV-V.	EC55S	104.00
STAINLESS STEEL "Y" PIPE.	EC50S	74.60
STAINLESS STEEL EXHAUST PIPE, MUFFLER, & RESONATOR. THREE SECTION. ALL ALPINES.	EC56S	346.00
ALPINE & TIGER RUBBER EXHAUST MOUNT (ALPINE 4/CAR, TIGER 8/CAR)	EC54	8.25ea
STUD FOR MANIFOLD DOWNPIPE	A9705123	2.95ea
LONG BRASS NUT FOR ALPINE EXHAUST STUD	A5220701	3.45ea

TIGER HEADERS, MILD STEEL	EC59	455.00pr
TIGER DOWNPIPES, STAINLESS, PAIR	EC59S	146.00pr
TIGER STAINLESS EXHAUST SYSTEM EXCEPT EC59S ABOVE, 1 3/4" PIPE FOR STOCK TIGERS	EC58S	585.00st
SEALING DONUT, EC59S TO MANIFOLD	EC60	5.40ea

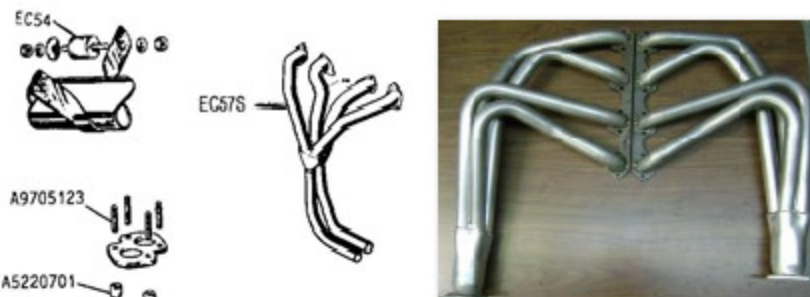

EC59 TIGER HEADERS



GROMMETS & PLUGS

BASIC ALPINE ENGINE COMPARTMENT GROMMET SET. 14 DIFFERENT GROMMETS AND PLUGS. TOTAL OF 37 PIECES. ALL PARTS DUPLICATES OF THE ORIGINALS. (SOME EXTRAS)	RP50	35.70
SUPPLEMENTAL TIGER GROMMET SET. INCLUDES GROMMETS FOR BATTERY CABLE, SPEEDO CABLE, OIL LINE, BRAKE LINES & SMALL PLUGS. 8 PIECES	RP51T	13.50
FIREWALL HEATER HOSE GROMMETS, PAIR	RG50	4.25pr
2" HOLE PLUG, TIGER SPARKPLUG ACCESS HOLE, ROCKER COVER HOLE, ALPINE & TIGER SHACKLE BOLT HOLES IN TRUNK. ORDER AS NEEDED.	RG51	3.80ea
1" RUBBER TRUNK HOLE PLUG	RG66	2.85ea
ALPINE II-V FIREWALL THROTTLE ROD GROMMET	RG58	5.60
GROMMET INSIDE HEATER CORE BOX FOR CONTROL CABLE	RG62	3.25ea
RUBBER INSULATORS FOR BATTERY & STARTER CABLES AT STARTER SOLENOID	RG63	4.50pr
FUEL PIPE GROMMET UNDER TRUNK	RG65	6.85
VENT CONTROL GROMMET SET. ALP. V, TIGER IA-II	IP67S	9.20set
DUCKBILL DRAIN, 1 PER CAR OR 3 PER CAR (LATE)	CS65	12.50ea

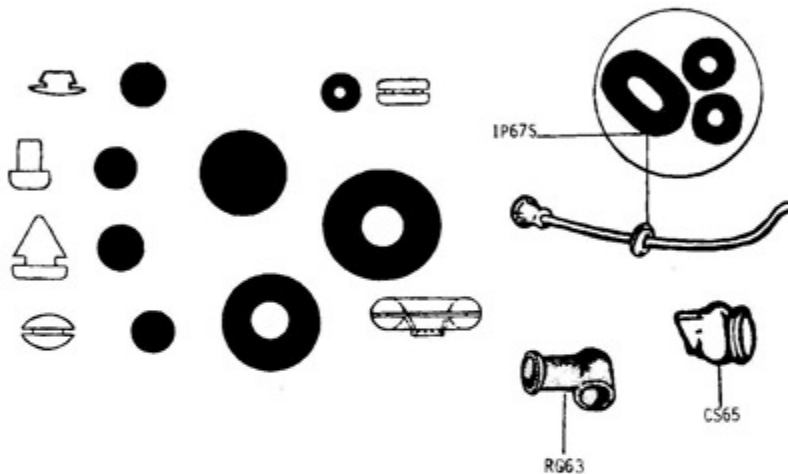

NOTE: ALPINE. FOR COMPLETE ENGINE COMPARTMENT COVERAGE, ALPINES SHOULD ORDER RP50, RG50, RG62, RG63, & RG58.

NOTE: TIGER. FOR COMPLETE ENGINE COMPARTMENT COVERAGE, TIGERS SHOULD ORDER RP50, RP51T, RG50, RG51 (1 OR 2), RG62, & RG63.

TOOLS

HUB CAP REMOVER, 3/4" WIDE	VT54	7.75
----------------------------	------	------

EMBLEMS & PATCHES

SUNBEAM ALPINE KEY FOB	AY50	N.L.A.
SUNBEAM TIGER KEY FOB	AY20	N.L.A.
SUNBEAM TIGER KEY CHAIN	AY23T	10.75
ALPINE LAPEL PIN - TIE TACK	AY51	5.50
TIGER LAPEL PIN - TIE TACK	AY21	6.50
ALPINE JACKET PATCH, 3" CIRCLE WITH TALBOT EMBLEM CENTER	AY52	10.25
TIGER JACKET PATCH, SAYS "SUNBEAM TIGER, POWERED BY FORD"	AY22	11.75.
TIGER SCRIPT LAPEL PIN	AY24	7.50
ALPINE SCRIPT LAPEL PIN	AY54	7.50
SUNBEAM PIN, RED	AY53	7.25



SIGNS

ALPINE PARKING ONLY SIGN	AY56A	21.50
TIGER PARKING ONLY SIGN	AY56T	21.50
TIGER 150 MPH SPEED SIGN	AY58T	21.50



SIGN SUPPLY LIMITED TO STOCK ON HAND.

TIGER & ALPINE EMBROIDERED FLOOR MATS

ALPINE EMBROIDERED CARPET FLOOR MATS BOUND NON-SLIP CARPET ATTRACTIVELY EMBROIDERED WITH "ALPINE" IN WHITE LETTERS.	IP72A	138.00pr
TIGER EMBROIDERED CARPET FLOOR MATS BOUND NON-SLIP CARPET ATTRACTIVELY EMBROIDERED WITH "TIGER" IN WHITE LETTERS.	IP72T	138.00pr



LAT 8 VALVE COVERS

TIGER LAT 8 ALUMINUM VALVE COVERS. THESE VALVE COVERS ARE MADE FROM THE ORIGINAL SHELBY-FORD TOOLING USED IN THE '60'S. STAINLESS STEEL BAFFLES ARE INSTALLED. OUR COVERS ARE BEAD BLASTED AND THE RIBS AND LETTERS ARE HIGHLY POLISHED. IF QUALITY, ORIGINALITY, AND EASE OF INSTALLATION ARE IMPORTANT, THEN THESE ARE THE COVERS FOR YOU. CAST BY BUDDY BAR CASTING CO. (ORIGINAL)	LAT8	585.00pr
COBRA VALVE COVERS. (260-289 ENGINE)	LAT8C	585.00pr

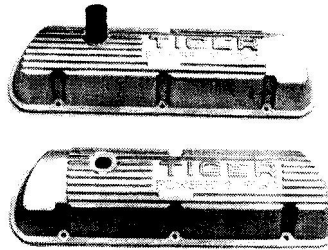

NOTES: ARE YOU USING OR PLANNING TO USE POLY LOCKS OR ROLLER TIP ROCKERS? THEN ORDER THE COVERS WITH THE BAFFLES NOT INSTALLED. FOR AN ENGINE WITH A CUSTOM VALVE TRAIN, HIGH LIFT CAM OR HEADS, YOU WILL HAVE TO CREATE ADDITIONAL CLEARANCE WITH THICKER GASKETS (FELPRO #1645) OR A SPACER AND CREATE A DIFFERENT BAFFLING SYSTEM..

LAT 70 15" x 6 1/2" TYPE WHEELS & SPINNERS

LAT 70 TYPE WHEEL, REPRODUCTION, A356 HEAT-TREATED ALUMINUM. APPEARANCE IS LIKE THE ORIGINALS BUT DIE-CAST FOR GREATER STRENGTH & BETTER APPEARANCE. STRONGER AND SAFER PRODUCT THAN THAT OFFERED IN THE '60s. POLISHED. (ORDER SPINNERS SEPARATELY.) WHEELS ACCEPT ONLY 3" MOUNT SPINNERS. (NOT 2 9/16")

LAT 70 WHEEL WITH THE 3" HUB. 6 1/2" WIDE.	LAT7015	285.00ea
SPINNER ONLY WITH NO DECAL. QUALITY HIGH-PRESSURE DIE-CASTING. FITS 3" HUB WHEELS.	MW52	45.95ea
DECAL FOR ABOVE, EMBOSSED, TIGER	MW52T	5.25 ea



ORIGINAL ROOTES POSTERS, POSTCARDS & CHRISTMAS CARD

FACTORY ROOTES PROMOTIONAL MATERIAL. RECREATED FROM THE ORIGINAL ARTWORK ARCHIVED AT THE COVENTRY MOTOR MUSEUM IN COVENTRY ENGLAND. PRINTED IN ENGLAND. CHECK OUR CATALOG ONLINE AT [WWW.ROOTES.COM](http://www.rootes.com) TO SEE THESE IN COLOR. SCAN THESE PICTURES WITH YOUR COMPUTER AND USE THEM FOR DESKTOP WALLPAPER, A SCREENSAVER, OR A SLIDE SHOW.

SET OF 7 ORIGINAL ROOTES POSTERS, TIGER & ALPINE, 1 FULL COLOR, OTHERS B & W WITH SOME ORANGE TYPE, ALL ARE ROOTES ADS EACH 11 X 17 INCHES (24 X 38 cm)	SB63	37.50 set
SET OF 8 ROOTES POSTCARDS IN FULL COLOR, RACING PHOTOS & SOME ADS, SOME SIGNED	SB67C	16.80set
SET OF 8 ROOTES BLACK & WHITE POSTCARDS, RACING PHOTOS & SOME AD PHOTOS, SOME SIGNED	SB67	16.00set
GENUINE ROOTES CHRISTMAS CARD, 10 CARDS WITH ENVELOPES. AN ATTRACTIVE MODEL REVEALS THE CHARMS OF HER NEW SUNBEAM CONVERTIBLE MODEL. (IN COLOR)	SB64	15.00(10)



SB63

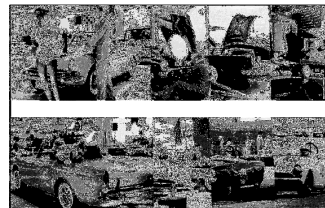

SB67



SB67C

SEAT BELTS

SEAT LAP BELTS FOR 2 SEATS, CHROME BUCKLE	UK85	102.80pr
3 POINT BELTS AS ABOVE, USED ON UK CARS	UK86	171.00pr
CHROME SUNBEAM DECAL FOR SEAT BELTS	UK87	NLA



SUNBEAM SPECIALTIES, INC



ORDER FORM

PHONE (408) 371-1642
FAX (408) 371-8070



NO COD'S (MAY BE PREPAID BY CK OR WIRE TRANS)

DATE _____ CUST. # _____
 / / _____

BILLING ADDRESS:

NAME _____
 STREET _____
 CITY _____ STATE _____ ZIP _____

TELEPHONE

DAY () _____ EVENING () _____
 FAX () _____ E-MAIL _____

SHIP-TO ADDRESS

NAME _____
 STREET _____
 CITY _____ STATE _____ ZIP _____

METHOD OF PAYMENT

VISA MC DISCOVER CHECK OPEN PREPAID

CARD NUMBER

MONTH YEAR SECURITY #

_____ X

CARD EXPIRES REAR OF CARD CARDHOLDER SIGNATURE

CARDHOLDER INFO:

NAME _____
 STREET _____
 CITY _____ STATE _____ ZIP _____

METHOD OF SHIPPING

SPECIAL INSTRUCTIONS _____
 (Normal shipping is by UPS ground or by mail for light packages)

TYPE OF CAR

ALPINE Series # _____ TIGER Mark # _____ OTHER Description _____

OTHER INFO _____

SERIAL # _____

LINE	PART#	DESCRIPTION	QTY.	PRICE EA.	TOTAL
1.					
2.					
3.					
4.					
5.					
6.					
7.					
8.					
9.					
10.					
11.					
12.					
13.					
14.					
15.					
16.					
17.					
18.					
19.					
20.					

SHIPPING CHARGES ARE BASED ON THE ACTUAL SHIPPING COST
 IT IS NOT NECESSARY TO CALCULATE. WE CAN DO IT ON REQUEST IF NEEDED.

POST OFFICE: www.usps.com
 UNITED PARCEL SERVICE: www.ups.com

CORE CHGS.	
SUB TOTAL	
(CA. RESIDENTS) SALES TAX	
THANKS TOTAL	

SUNBEAM SPECIALTIES, INC

SHIPPING & POLICIES

SHIPPING CHARGES: SHIPPING CHARGES ARE BASED ON OUR ACTUAL COSTS FOR SHIPPING. THESE CHARGES INCLUDE UPS OR POST OFFICE SHIPPING CHARGES, INSURANCE, AND THE COST OF THE CARDBOARD BOXES AND SHIPPING CONTAINERS USED. THERE IS A CRATING CHARGE OF \$45.00 TO PACKAGE A WINDSHIELD FOR SHIPPING. WINDSHIELDS CAN BE SHIPPED BY UPS (91 LBS UPS VOLUME OVERSIZE) AND CHARGES ARE REASONABLE. NO PACKAGES WILL BE SHIPPED BY COD.

ADDRESSES: PLEASE PROVIDE A STREET ADDRESS FOR UPS SHIPMENTS.

WARRANTY: ALL PARTS ARE WARRANTED AGAINST DEFECTS IN MATERIAL & CONSTRUCTION BY THE ORIGINAL MANUFACTURER OR SUNBEAM SPECIALTIES, INC. UNDER NO CIRCUMSTANCES DOES OUR WARRANTY COVER LABOR, FAILURE OF A RELATED PART, FAILURE FROM FAULTY INSTALLATION, LOSSES FROM THE LOSS OF USE OF THE VEHICLE, NOR WOULD THE LIABILITY OF SUNBEAM SPECIALTIES, INC. EXCEED THE PURCHASE PRICE OF THE ORIGINAL PART.

RETURNED PARTS: DEFECTIVE PARTS OR ITEMS NOT AS ORDERED MAY BE RETURNED FOR A FULL REFUND. SPECIAL ORDER PARTS MAY NOT BE RETURNED UNLESS DEFECTIVE. AFTER 30 DAYS OF THE PURCHASE DATE, EXCEPT AS ABOVE, RETURNED PARTS ARE SUBJECT TO A 15% RESTOCKING CHARGE. NO RETURNED PARTS ARE ACCEPTED COD.

FOREIGN SHIPMENTS MUST BE PREPAID IN US DOLLARS BY VISA, MC OR DISCOVER OR BANK CHECK IN US \$. CANADIAN SHIPMENTS ARE GENERALLY SHIPPED BY AIRMAIL BUT CAN BE SHIPPED BY UPS GROUND, UPS EXPEDITED, OR UPS EXPRESS. UPS GROUND SHIPMENTS WILL BE CHARGED ABOUT \$35+ BY UPS ON RECEIPT OF THE PACKAGE FOR CUSTOMS BROKERAGE CHARGES. ALL FOREIGN SHIPMENTS BY THE POST OFFICE ARE SHIPPED BY AIR AS SURFACE SHIPPING HAS BEEN DISCONTINUED.

COD IS NO LONGER USED BECAUSE OF THE HIGH COSTS. PARTS MUST BE PREPAID. PRICES ARE SUBJECT TO CHANGE WITHOUT NOTICE. IF A PRICE CHANGE IS SUBSTANTIAL, YOU WILL BE NOTIFIED BEFORE YOUR ORDER IS SHIPPED. PRICES MAY BE UNSTABLE IF OUR FIRST CHOICE SUPPLIER IS UNABLE TO FILL OUR ORDER AND WE HAVE TO BUY FROM AN ALTERNATE SUPPLIER ON HARD-TO-FIND PARTS.

CLAIMS FOR DAMAGED PACKAGES SHOULD BE MADE DIRECTLY TO THE CARRIER AS SOON AS POSSIBLE. CLAIMS FOR MISSING PARTS MUST BE MADE TO US WITHIN 30 DAYS OF RECEIVING THE PACKAGE.

SOFT TOPS THAT HAVE BEEN UNFOLDED MUST BE RETURNED FOLDED EXACTLY AS RECEIVED TO AVOID DAMAGE TO THE REAR WINDOW. VERIFY THAT THE TOP IS THE CORRECT TOP FOR YOUR CAR BEFORE OPENING IT UP.

UPS RATES www.ups.com

UPS IS BEST FOR HEAVIER PACKAGES. SHIPMENTS CAN BE TRACKED. RATES VARY BY SIZE, WEIGHT & DESTINATION AND CAN HAVE RURAL, URBAN, RESIDENTIAL AND OTHER SURCHARGES..

POSTAL RATES <http://postcalc.usps.gov/>

PRIORITY MAIL IS FAST & INEXPENSIVE FOR LIGHT PACKAGES IN THE US. A 1 LB. BOX CAN BE SHIPPED IN THE US FOR \$9.55, 2 LBS. FOR \$13.80. SMALL SIZED SHIPMENTS MAY BE SENT IN FLAT RATE BOXES. PACKAGES UNDER 13 OZ. CAN BE SHIPPED BY FIRST CLASS IN THE US, UNDER 4 LBS. OUTSIDE THE US.

UPS RATES ARE MUCH TOO COMPLICATED TO GIVE A BRIEF DESCRIPTION. THERE ARE MANY SURCHARGES FOR RESIDENTIAL DELIVERY, IRREGULAR PACKAGES AND RURAL AREAS. PLEASE VISIT [WWW. UPS.COM](http://www.ups.com) FOR SOME MORE INFO.

US POST OFFICE. FOR INFO,VISIT [WWW.USPS.COM](http://www.usps.com) FOR FOREIGN OR AMERICAN POSTAL RATES, CONDITIONS, AND SIZE LIMITS.

ROOTES ARCHIVE CENTRE TRUST



<https://www.rootesarchive.org/>

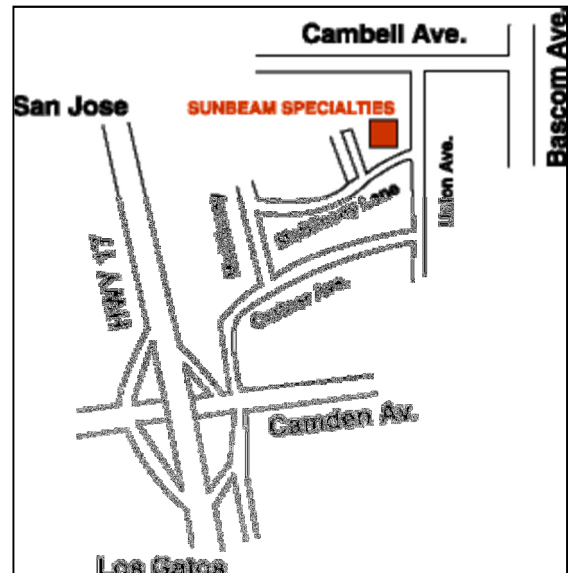

765-A East McGlinchy Lane, Campbell, CA 95008

(408) 371-1642

SUNBEAM SPECIALTIES, INC

**SUNBEAM SPECIALTIES, INC.
765 E McGLINCY LN STE A
CAMPBELL, CA 95008**



SUNBEAM *Specialties, Inc.* - 765-A E. McGlincy Ln, Campbell CA 95008 408 371-1642